

ABBREVIATIONS :-

- F.F.L. = FINISH FLOOR LEVEL .
- P.C.C. = PLAIN CEMENT CONCRETE
- R.C.C. = REINFORCED CEMENT CONCRETE .
- T.O.S. = TOP OF SLAB
- MS = MILD STEEL
- ACP. = ALUMINUM COMPOSITE PANEL
- FD = FIRE DOOR
- G = GLAZING
- W = WINDOW
- V = VENTILATOR
- D = DOOR
- SD = SHAFT DOOR
- FHC. SHAFT = FIRE HOUSE CABIN SHAFT
- PL. SHAFT = PLUMBING SHAFT

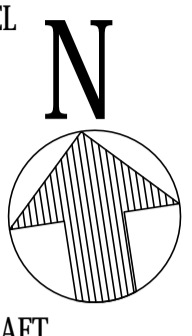

- EXISTING PLOT LINE
- - - SET BACK LINE
- - - ROAD WIDENING LINE

1. Dimensions are not to be scaled.
2. All Dimensions are in Millimeters unless stated otherwise.
3. All Levels are in Millimeters and relate to Datum level.
4. The contractor shall verify all dimensions, details, specifications & site conditions & shall report any error, omission and/or anomaly to the architect before commencement of work.
5. For construction purposes, the dimensions shall not be measured directly of the drawings. The drawings shall not be used for construction until they are issued for construction.
6. These drawings are to be read in co-ordination with hvac, electrical, plumbing drawings & all relevant sections of specifications..
7. All shop drawings should be provided to the architect for approval.

No.	Date	By	Description
R1	28-02-2022	ARPITA	UG Tank & STP position revised

Architects
SANJIV TANDON ARCHITECTS
 ARCHITECTURE & INTERIORS
 S-10/10, DLF CITY, PHASE III, GURGAON,
 HARYANA, PH - +91-9811019278

MEP Consultant:
Acrobat Engineers Pvt.Ltd.
 H.No. 19 Block-18
 Basement Level, Spring Field Colony
 Faridabad (Haryana)
 Tel : 0129-4056009
 customerservice@acrobatengineers.com

Structures
SANRACHNA CONSULTANTS
 302-315, Ansal's Majestic Tower, Plot no.-17,
 Block G-1, Vikas puri, New Delhi-110018
 Phone- 011-49423861, 28545881, 28545281,
 E mail- info@sanrachnaconsultants.com
 Website:-www.sanrachnaconsultants.com

Client :-
MR. RAJEEV BEHAL
DOMOV HOUSING PRIVATE LIMITED

Project Title:-
CONSTRUCTION OF RESIDENTIAL VILLAS AT ANJUNA VILLAGE, BARDEZ GOA.

Drawing Title:-
SITE LAYOUT PLAN

- DRAWING STATUS:-
- CONCEPTUAL
 - FOR SUBMISSION
 - FOR APPROVAL / COMMENTS
 - FOR TENDER
 - GOOD FOR CONSTRUCTION

Drawn by Arpita	Sanjiv Tandon	Checked Sanjeev Ahlawat
Date 28-02-2022	Scale 1:100(A1)	Revisions R0

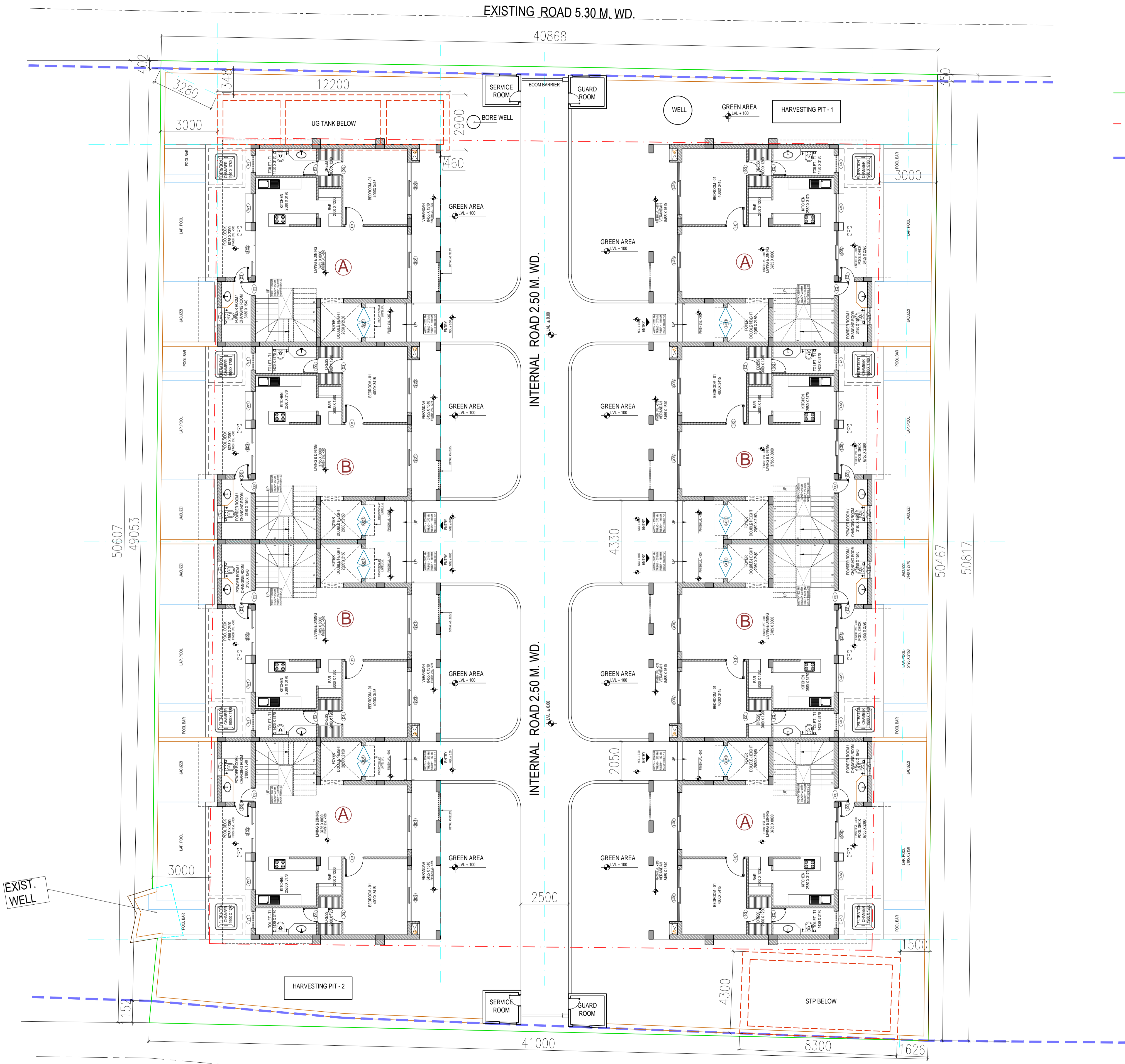

EXIST. WELL

Drawn by Arpita	Sanjiv Tandon	Checked Sanjeev Ahlawat
Date 28-02-2022	Scale 1:100(A1)	Revisions R0