

SITE PLAN
SCALE - 1:500

TOTAL AREA OF PLOT	2140.00 M2
AREA WITHIN R/W (PROPOSED)	95.00 M2
NET AREA FOR DEVELOPMENT	2045.00 M2
AREA OF PLOT 'B'	903.00 M2

PROJECT

PLAN SHOWING N.O.C FOR SALE OF PLOT 'B' IN LAND BEARING SURVEY No. 413 SUB. DIV. NO. 1(PART) SITUATED AT ANJUNA VILLAGE BARDEZ-GOA. BELONGING TO - **Mr. ANTHONY ALBUQUERQUE & Mrs. LIANA MARIA ALBUQUERQUE.**

Submission Drawing

DESIGNED BY

JOB No. 5035/21

DATE :- 23/01/21

SCALE :- 1:500

DRN. BY - VIJAY

DRG. No. 01



Albuquerque

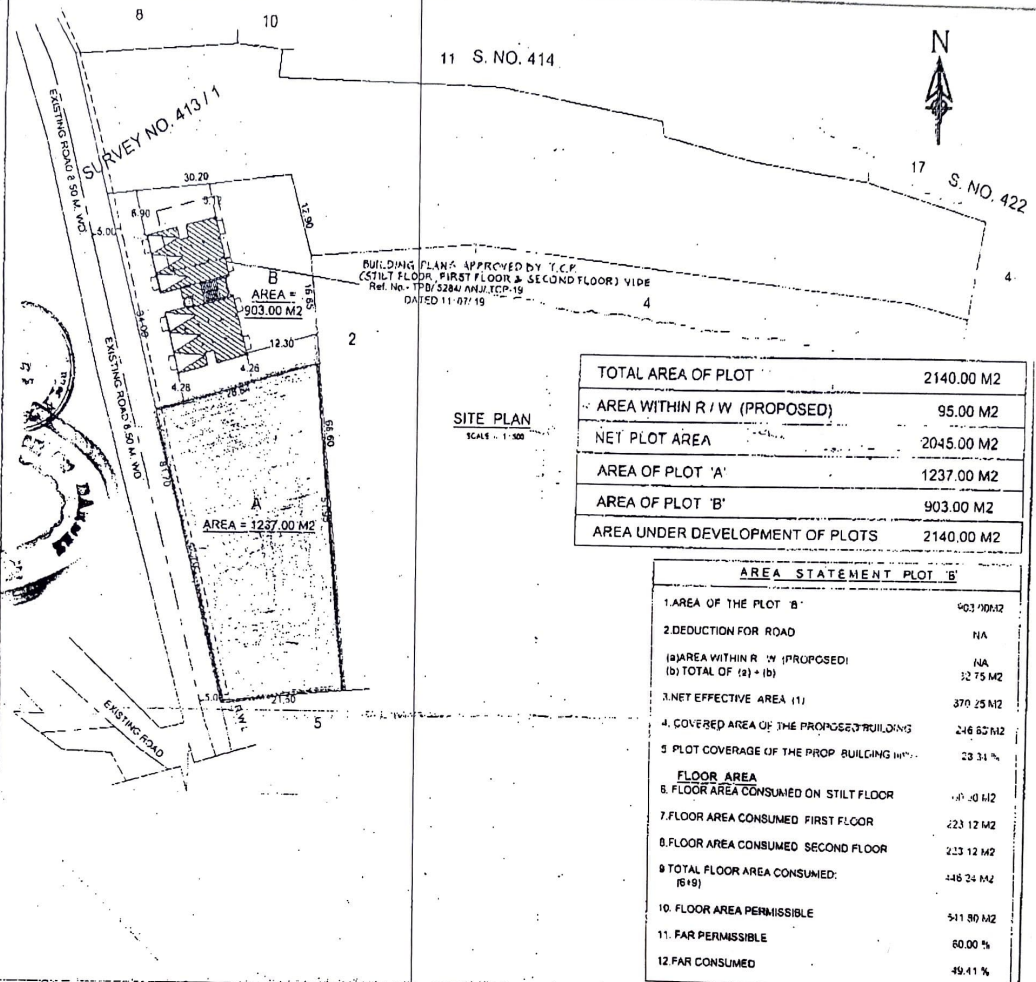

TOTAL AREA OF PLOT	2140.00 M2
AREA WITHIN R/W (PROPOSED)	95.00 M2
NET PLOT AREA	2045.00 M2
AREA OF PLOT 'A'	1237.00 M2
AREA OF PLOT 'B'	903.00 M2
AREA UNDER DEVELOPMENT OF PLOTS	2140.00 M2

AREA STATEMENT PLOT 'B'	
1. AREA OF THE PLOT 'B'	903.00 M2
2. DEDUCTION FOR ROAD	NA
(a) AREA WITHIN R/W (PROPOSED)	NA
(b) TOTAL OF (a) + (b)	32.75 M2
3. NET EFFECTIVE AREA (1)	370.25 M2
4. COVERED AREA OF THE PROPOSED BUILDING	246.62 M2
5. PLOT COVERAGE OF THE PROP. BUILDING (1/3)	33.31 %
FLOOR AREA	
6. FLOOR AREA CONSUMED ON STILT FLOOR	47.30 M2
7. FLOOR AREA CONSUMED FIRST FLOOR	223.12 M2
8. FLOOR AREA CONSUMED SECOND FLOOR	223.12 M2
9. TOTAL FLOOR AREA CONSUMED (6+7+8)	446.24 M2
10. FLOOR AREA PERMISSIBLE	511.80 M2
11. FAR PERMISSIBLE	60.00 %
12. FAR CONSUMED	49.41 %

PRODUCED BY AN AUTODESK EDUCATIONAL PRODUCT

PROJECT
 PLAN SHOWING NOC FOR SALE OF PLOT 'A' IN LAND BEARING SURVEY No. 413 SUB. DIV. NO. 1(PART) SITUATED AT ANJUNA VILLAGE BARDEZ- GOA. BELONGING TO - Mr. ANTHONY ALBUQUERQUE & Mrs. LIANA MARIA ALBUQUERQUE.

TITLE Submission Drawing		JOB No. 4080-19	
APPLICANT'S SIGN <i>Albuquerque</i>	DESIGNED BY <i>Albuquerque</i>	DATE	03-07-19
AGNELO DE OLIVEIRA T.C.P. Reg. No. ER/0017/2010 P.W.D. Reg. No. 5548/PK N.M.C. No. 1310, N.P.C.S. 20A N.G.P.D.A. No. 19		SCALE	1:500, 1:50
		DRN BY.	VIJAY
		DRG No.	01

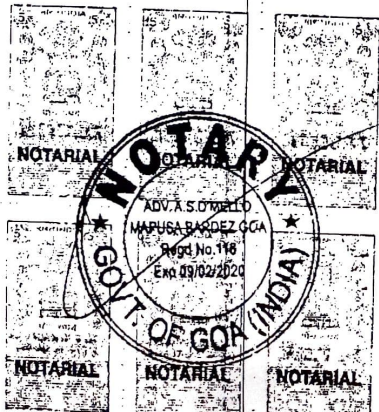

CERTIFIED TO BE TRUE COPY
Amello
 30/09/19
 ADV. A. S. D'MELLO
 NOTARY
 REG. NO. ...54...96/19