

NOTE: TPB/2137/MARNA/TCP/16/3533 DATE: 29/11/2016

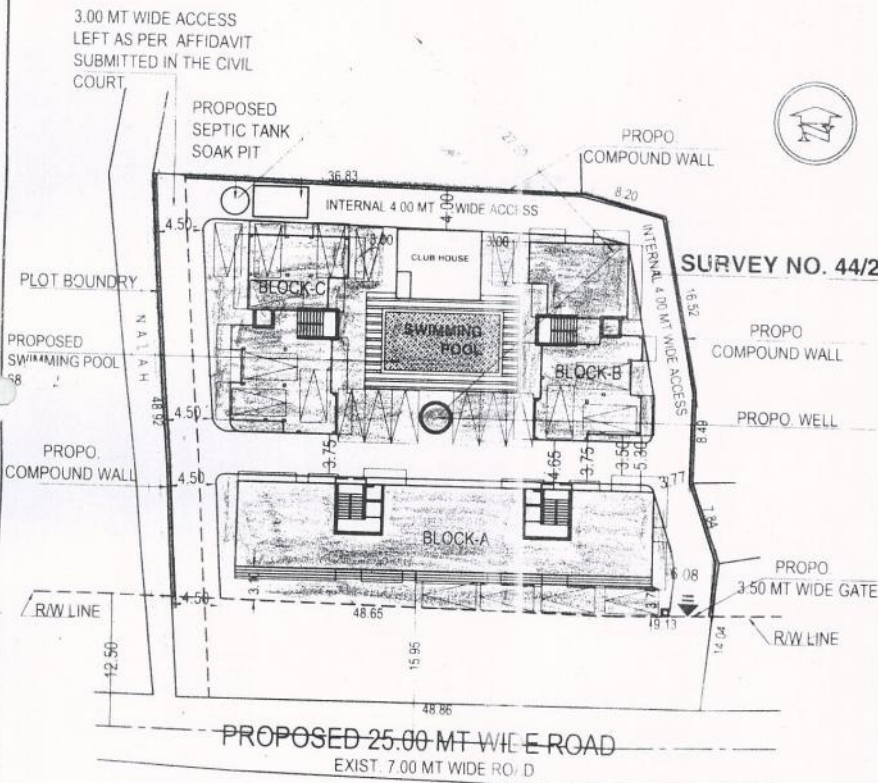

SITE PLAN

SCALE : 1:500

Approved with condition vide

L. No.: *TPB/2537/MARNA/2016/1165*

[Signature]
Dy. Town Planner

Town & Country Planning Dept
Govt. of Goa, Mapusa

26/12/2016

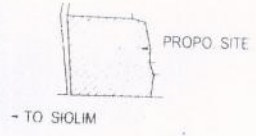

LOCATION PLAN

NOT TO SCALE

Secretary
V. P. Siodim Marna



SIGNATURE OF ARCHITECT

SIGNATURE OF OWNER

Ashwinikumar Prabhu
Architect

TCP Reg. No. AR/0029/2010
C5, Trionora Apartments,
NEAR MUNICIPAL MARKET,
Panaji - Goa.

[Signature]

AREA STATEMENT

SR.NO	DESCRIPTION	AREA	UNITS
1	AREA OF PLOT	2375.00	sq. mt
2	AREA UNDER R/W	446.23	sq. mt
3	NET EFFECTIVE AREA FOR COVERAGE	1928.77	sq. mt
4	BLOCK-A	315.67	sq. mt
5	BLOCK-B	159.57	sq. mt
6	BLOCK-C	159.57	sq. mt
7	CLUB HOUSE	50.92	sq. mt
8	TOTAL COVERED AREA OF BUILDINGS	685.73	sq. mt
9	COVERAGE CONSUMED	35.55	%
10	COVERAGE PERMISSIBLE (40%)	771.50	sq. mt

11	NET FLOOR AREA BLOCK-A		
a)	Ground Floor	280.95	sq. mt
b)	First Floor	249.89	sq. mt
c)	Second Floor	249.89	sq. mt
d)	TOTAL FLOOR AREA	780.73	sq. mt
12	NET FLOOR AREA BLOCK-B		
a)	Ground Floor	57.79	sq. mt
b)	First Floor	143.77	sq. mt
c)	Second Floor	143.77	sq. mt
d)	TOTAL FLOOR AREA	345.33	sq. mt
12	NET FLOOR AREA BLOCK-C		
a)	Ground Floor	000.00	sq. mt
b)	First Floor	143.77	sq. mt
c)	Second Floor	143.77	sq. mt
d)	TOTAL FLOOR AREA	287.54	sq. mt
13	TOTAL FLOOR AREA OF BLOCK-A, B & C	1413.60	sq. mt
14	F.A.R. CONSUMED	59.52	%
15	F.A.R. PERMISSIBLE (60%)	1425.00	sq. mt
16	LENGTH OF COMPOUND WALL	123.27	R. mt
17	AREA FOR INFRASTRUCTURE TAX	2135.48	sq. mt
18	PARKING REQUIRED	21	Nos.
19	PARKING PROVIDED	22	Nos.
20	ADDITIONAL F.A.R. Available (7.5% of 1413.60 00M2)	106.02	M2
21	ADDITIONAL F.A.R. Utilised (for Club House) - 50.92m2(3.60%)		

	PROJ. NO.	DRG. NO.	REV. NO.
	SA-AR-360/16	SD-01	
	DATE	DRAWN BY	CKD. BY
NORTH	16-06-2016	Krishna	ashwin. P

TITLE:
PROPOSED DEVIATION OF SITE PLAN SHOWING APPROVED CONSTRUCTION OF RESIDENTIAL BUILDINGS BLOCK-A,B,C SWIMMING POOL, CLUB HOUSE & WELL ON PLOT BEARING SURVEY NO.44/2 AT MARNA, BARDEZ - GOA FOR **Mrs. VERONICA POLSON PAUL EDATTUKARAN AND OTHERS.**

PROJECT ARCHITECT

ASHWINIKUMAR PRABHU



studio Arche'type

architecture + interiors

C-5, 3rd Floor, Trionora Apts., Near Municipal Market, Panaji - GOA, INDIA
B-209, 2nd floor, Saldanha Business Towers At Court Circle Mapusa - GOA - INDIA
Ph 0091-832-6516650, Panjim off. 6511330 e-mail studioarchetype@gmail.com