

### AREA STATEMENT

FLOOR	TOTAL BUA (sq.m)	STORAGE DUCT	CORRIDOR	PASSAGE	VERBALC	TERRACE	TOTAL	NET F.A.R. (sq.m)
GROUND FLOOR	174.24	18.97	13.80	19.94	18.94	33.96	164.85	164.85
FIRST FLOOR	174.24	23.97	13.80	19.94	18.94	33.96	117.82	117.82
TOTAL	348.48	42.94	27.60	39.88	37.88	67.92	282.67	282.67
TYPE I X NOS = 1616.80 SQ.M = BUA								
TYPE I X NOS. COVERAGE = 70.44 SQ.M								
TYPE II X NOS. COVERAGE = 87.88 SQ.M								
TOTAL COVERAGE = 158.32 SQ.M								
TOTAL F.A.R. = 2044.44 M2								

### AREA STATEMENT FOR INFRASTRUCTURE TAX

FLOOR	TOTAL BUA (sq.m)	STORAGE DUCT	CORRIDOR	PASSAGE	VERBALC	TERRACE	TOTAL	NET F.A.R. (sq.m)
GROUND FLOOR	140.80	18.97	13.80	19.94	18.94	33.96	176.38	176.38
FIRST FLOOR	174.24	23.97	13.80	19.94	18.94	33.96	117.82	117.82
TOTAL	315.04	42.94	27.60	39.88	37.88	67.92	294.20	294.20
TYPE I X NOS. COVERAGE = 104.44 SQ.M								
TYPE II X NOS. COVERAGE = 87.88 SQ.M								
TOTAL COVERAGE = 192.32 SQ.M								
TOTAL F.A.R. = 2044.44 M2								

### AREA CALCULATIONS

GROUND FLOOR FAR	1108.82 M2
TYPE I = 140.80 M X 4 NOS = 563.20 M2	
TYPE II = 272.81 M X 2 NOS = 545.62 M2	
FIRST FLOOR FAR	936.62 M2
TYPE I = 117.82 M X 4 NOS = 471.28 M2	
TYPE II = 228.17 M X 2 NOS = 464.94 M2	
TOTAL FLOOR AREA CONSUMED	2044.44 M2
TOTAL BUILT UP AREA	2786.60 SQ.M
GROUND FLOOR BUA	1393.3 SQ.M
TYPE I = 176.38 SQ.M X 4 NOS = 705.48 SQ.M	
TYPE II = 343.82 SQ.M X 2 NOS = 687.80 SQ.M	
FIRST FLOOR BUA	1393.3 SQ.M
TYPE I = 176.38 SQ.M X 4 NOS = 705.48 SQ.M	
TYPE II = 343.82 SQ.M X 2 NOS = 687.80 SQ.M	

### AREA STATEMENT

G1 TOTAL AREA OF SY NO 186/5 & 186/13	3775 M2
G2 AREA FOR ROAD WIDENING	275 M2
G3 EFFECTIVE PLOT AREA	3500 M2
G4 COVERAGE PERMISSIBLE (60%)	1400.0 M2
G5 PROPOSED COVERAGE (39.8%)	1393.3 M2
G6 F.A.R. PERMISSIBLE (60%)	2285.0 M2
G7 PROPOSED F.A.R (64.15%)	2044.44 M2

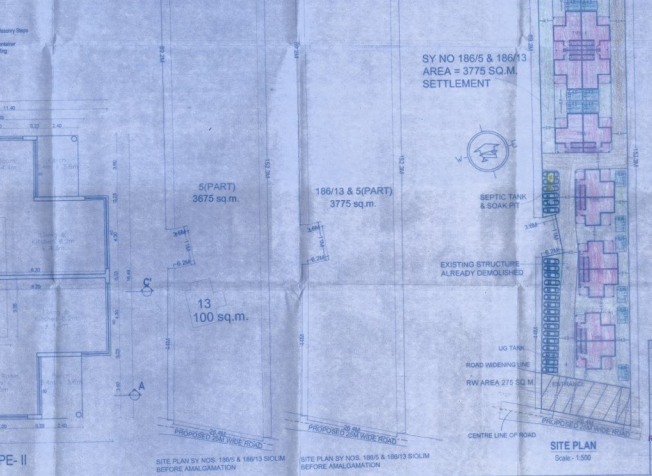
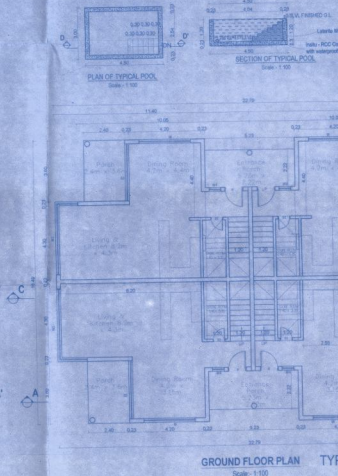

Approved with Res. No. 105  
passed by the ward/panchayat  
Board - 22/03/2015

**SECRETARY**  
V.P. Datta

**HEALTH OFFICER**  
PRIMARY HEALTH OFFICER

**FOR REGULATION OFFICER**  
FOR REGULATION OFFICER

**FOR REGULATION OFFICER**  
FOR REGULATION OFFICER

**FOR REGULATION OFFICER**  
FOR REGULATION OFFICER