

Sapana Grandeur

AT AQUEM - MARGAO - GOA

SHOPS, OFFICES AND 2 & 3 BHK APARTMENTS

Location Map (not to scale)



For Bookings Contact

NANU
ESTATES

VILLAS | APARTMENTS | PLOTS

NANU ESTATES PRIVATE LIMITED

Head Office :

Nanu House, V. V. Road, Margao - Goa - 403601
Ph. : +91 832 67555014

Mobile : +91 8888 22 7777

Web : www.nanuestates.in

Email : sales@nanuindia.com

Branch Office :

Panaji Office : Naik Villa, Dr. Dada
Vaidya Road, Opp. Kundaikar Nagar,
Panaji - Goa - 403001
Ph. : +91 832 2225180 / +91 832
2435307

A member of
CREDAI

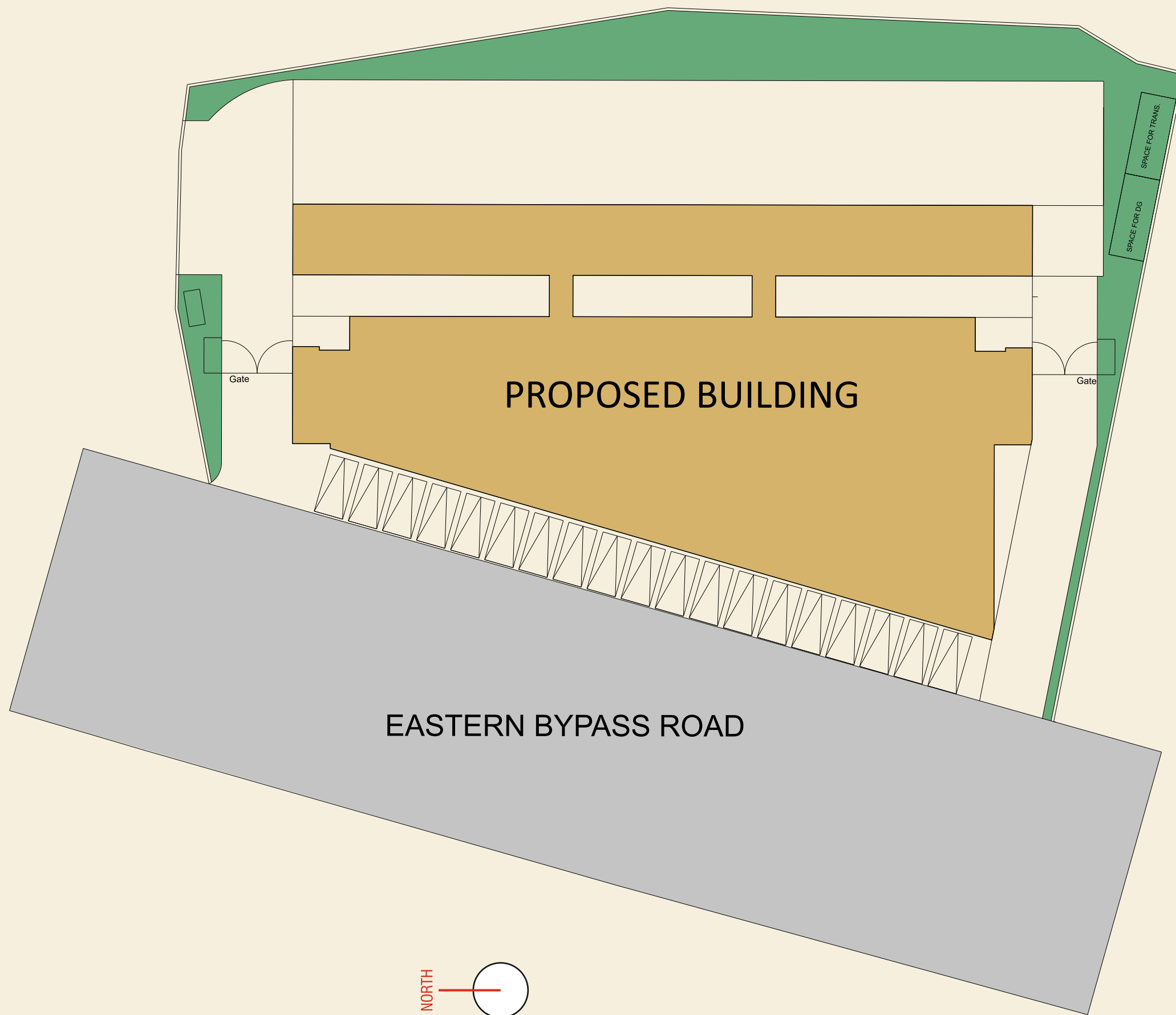

PROPOSED BUILDING

EASTERN BYPASS ROAD

NORTH

Amenities

- Internal Roads with Interlocking Pavers
- Lift with Backup Generator
- Society Office cum Gym
- CCTV at Entrance Gate with 24 hrs Surveillance
- Gated Complex with Security Cabin

Project Specifications

Structure - RCC framed structure with internal and external block masonry walls.

Plaster - External double coat sand faced cement plaster. Internal walls with gypsum plaster/ Cement putty.

Flooring - Vitrified flooring for entire unit.

Kitchen - Granite platform with stainless steel sink. Ceramic dado tiles 2 feet above platform.

Decor - Internal walls in emulsion and external walls in external emulsion paint.

Electrical - 3 phase electrical connection with premium quality concealed wiring with modular switches.

Toilets - Ceramic tiles for floor & walls, premium quality sanitary ware with premium quality fittings.

Scheme Layout

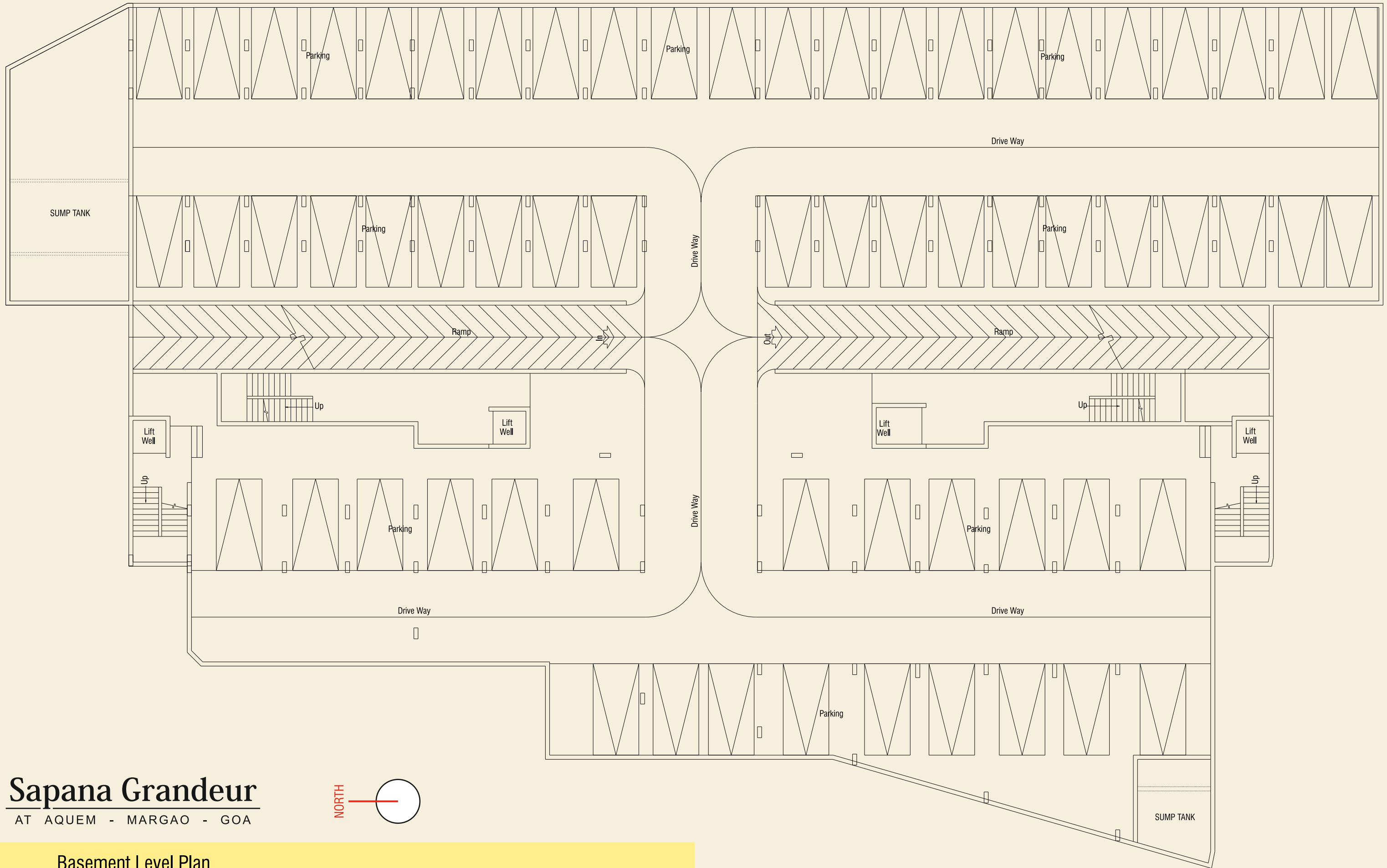

Sapana Grandeur
AT AQUUM - MARGAO - GOA

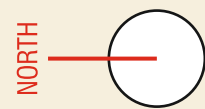

Basement Level Plan

NOTE: Dimensions shown in the above floor plan are as per the plans approved by the South Goa Planning & Development Authority and Margao Municipal Council, which includes the carpet area to be covered by plaster of internal walls and plaster of internal side of external walls. Such dimensions will vary after the internal walls and internal side of the external walls are plastered. Consequently, there is likely to be reduction in the carpet area depending upon the thickness of plaster of the walls.

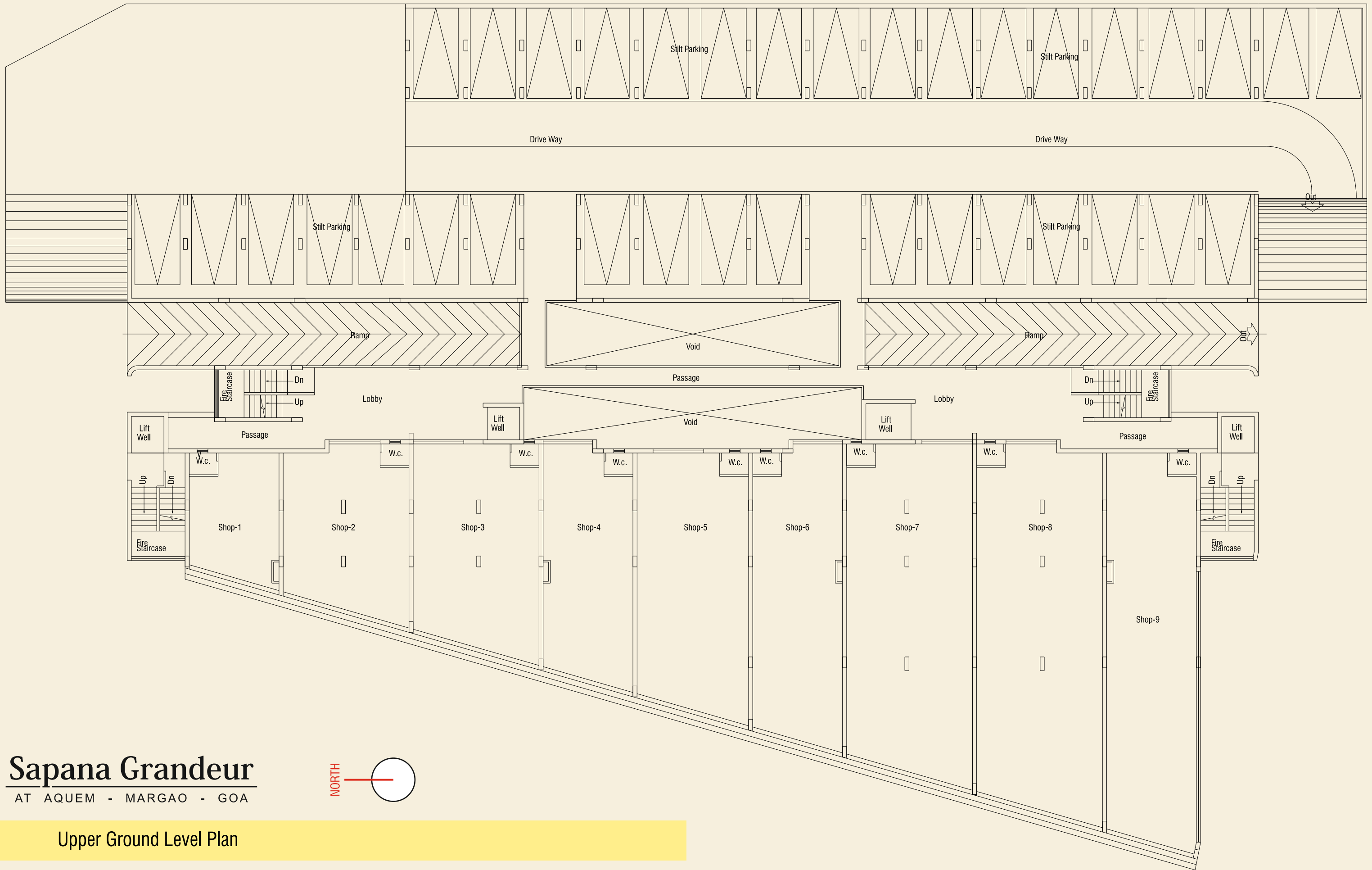

Sapana Grandeur
AT AQUUM - MARGAO - GOA

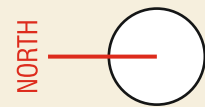

Upper Ground Level Plan

NOTE: Dimensions shown in the above floor plan are as per the plans approved by the South Goa Planning & Development Authority and Margao Municipal Council, which includes the carpet area to be covered by plaster of internal walls and plaster of internal side of external walls. Such dimensions will vary after the internal walls and internal side of the external walls are plastered. Consequently, there is likely to be reduction in the carpet area depending upon the thickness of plaster of the walls.

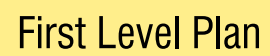

NOTE: Dimensions shown in the above floor plan are as per the plans approved by the South Goa Planning & Development Authority and Margao Municipal Council, which includes the carpet area to be covered by plaster of internal walls and plaster of internal side of external walls. Such dimensions will vary after the internal walls and internal side of the external walls are plastered. Consequently, there is likely to be reduction in the carpet area depending upon the thickness of plaster of the walls.

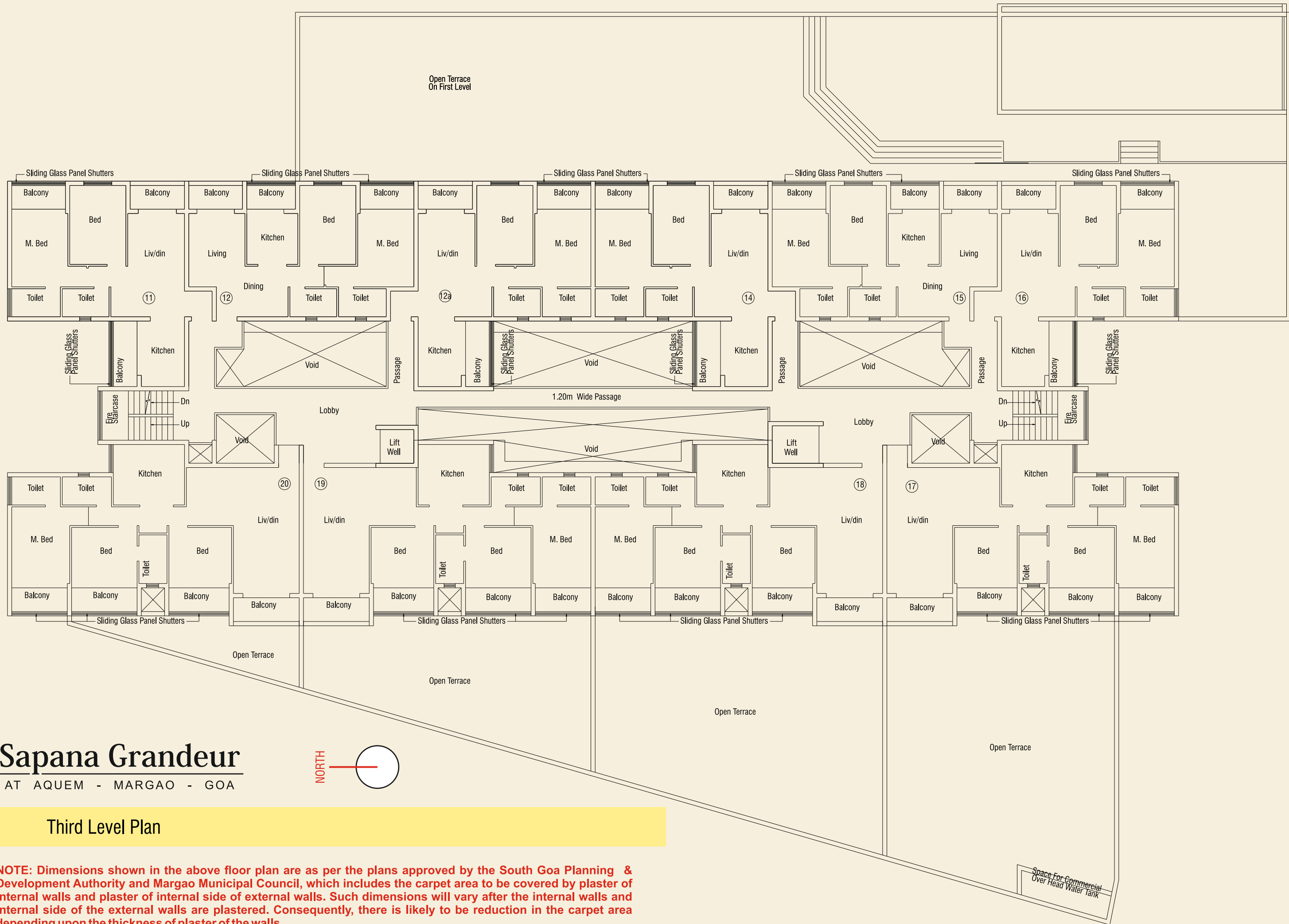

Sapana Grandeur

AT AQUEM - MARGAO - GOA

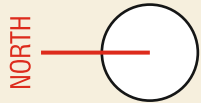

Third Level Plan

NOTE: Dimensions shown in the above floor plan are as per the plans approved by the South Goa Planning & Development Authority and Margao Municipal Council, which includes the carpet area to be covered by plaster of internal walls and plaster of internal side of external walls. Such dimensions will vary after the internal walls and internal side of the external walls are plastered. Consequently, there is likely to be reduction in the carpet area depending upon the thickness of plaster of the walls.

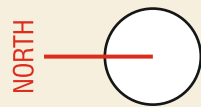

NOTE: Dimensions shown in the above floor plan are as per the plans approved by the South Goa Planning & Development Authority and Margao Municipal Council, which includes the carpet area to be covered by plaster of internal walls and plaster of internal side of external walls. Such dimensions will vary after the internal walls and internal side of the external walls are plastered. Consequently, there is likely to be reduction in the carpet area depending upon the thickness of plaster of the walls.

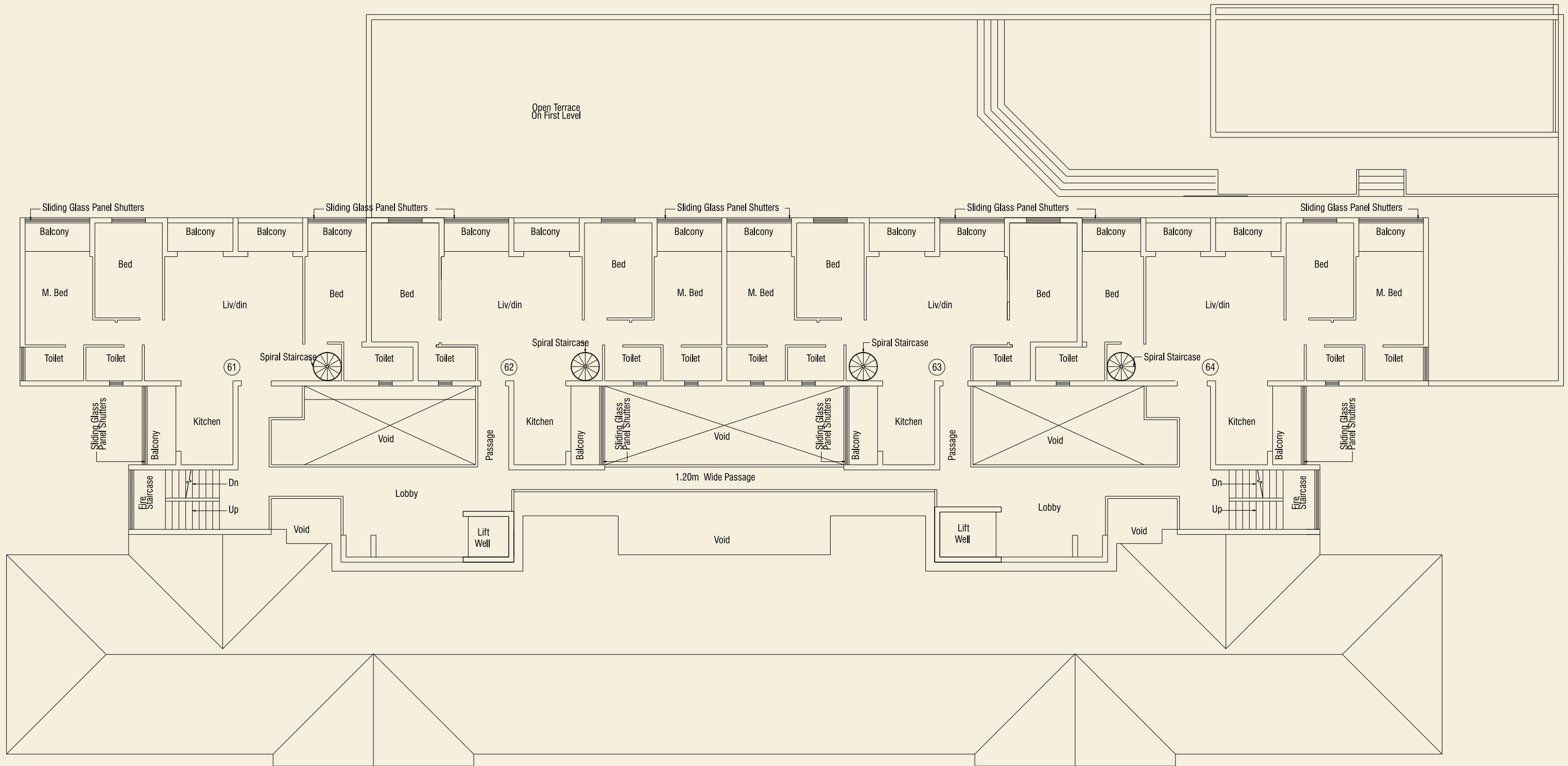

Sapana Grandeur
AT AQUUM - MARGAO - GOA

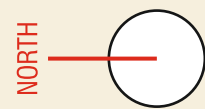

Eighth Level Plan

NOTE: Dimensions shown in the above floor plan are as per the plans approved by the South Goa Planning & Development Authority and Margao Municipal Council, which includes the carpet area to be covered by plaster of internal walls and plaster of internal side of external walls. Such dimensions will vary after the internal walls and internal side of the external walls are plastered. Consequently, there is likely to be reduction in the carpet area depending upon the thickness of plaster of the walls.