

AREA STATEMENT

- 1) PLOT AREA -1067 SQM
- 2) PERMISSIBLE F.A.R (60% OF 1067 SQM) -640 SQM
- 3) PERMISSIBLE COVERAGE (40% 1067 SQM) - 427 SQM

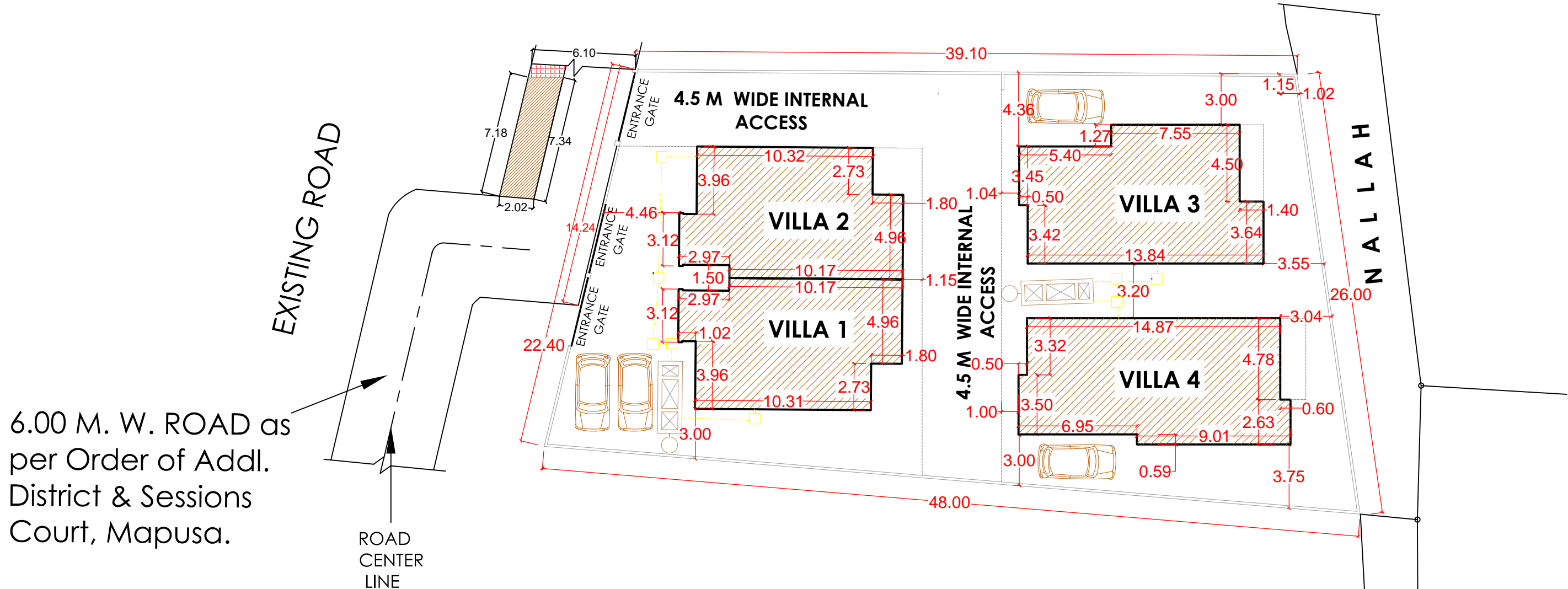

6.00 M. W. ROAD as per Order of Addl. District & Sessions Court, Mapusa.

SITE PLAN ALONG WITH GROUND FLOOR LAYOUT (FOR SUBMISSION PURPOSE)

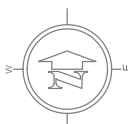

PROPOSED DEVELOPMENT IN SURVEY NO 175 / 4B AT SIOLIM GOA (REVISION DATE: 17/05/2021)

DEVELOPER:
RATESH
DRAWN PLAN:
HARSHADA KUNDAIKER
MULSPRO CONSULTANCY & SERVICES LLP