

AREA STATEMENT - PHASE -II

1)	Area of Plot in Sq.m	:	3075.00 m2
2)	Area with in R/W in Sq.m	:	152.00 m2
3)	Net Effec. Area of Plot in Sq.m	:	2923.00 m2
4)	Covered Area of Proposed Building	:	222.65 + 366.70 = 589.35m2
5)	Coverage of Proposed Building (%)	:	20.20 %
6)	Permissible Coverage in (%)	:	40.00 %
7)	Permissible FAR in (%)	:	60.00 %
8)	Parking : Total No. of Required Parking : 11 Nos. Total Provided - 16Nos.		

Floor wise Area Calculations :

Floor (%) reference	Floor Use	Floor (m2) Area	Area Free of FAR				Net Floor Area m2	FAR (%)
			Bal.	O.T.	Stair.	Porch		
Ground Floor	Commercial	90.65	0.00	0.00	0.00	0.00	90.65	3.10%
	Residential	523.90	0.00	0.00	45.45	64.74	413.71	14.15%
F. Floor	Residential	639.52	61.00	142.34	47.88	0.00	388.30	13.28%
S. Floor	Residential	87.67	3.53	14.25	23.04	0.00	46.85	1.60%
Total		1341.75	64.53	156.59	116.37	64.74	939.51	32.15%

Area Calculation for Infrastructure Tax :

i)	Commercial Area in m2	:	90.65 sq.m
ii)	Residential Area in m2	:	1029.76 sq.m

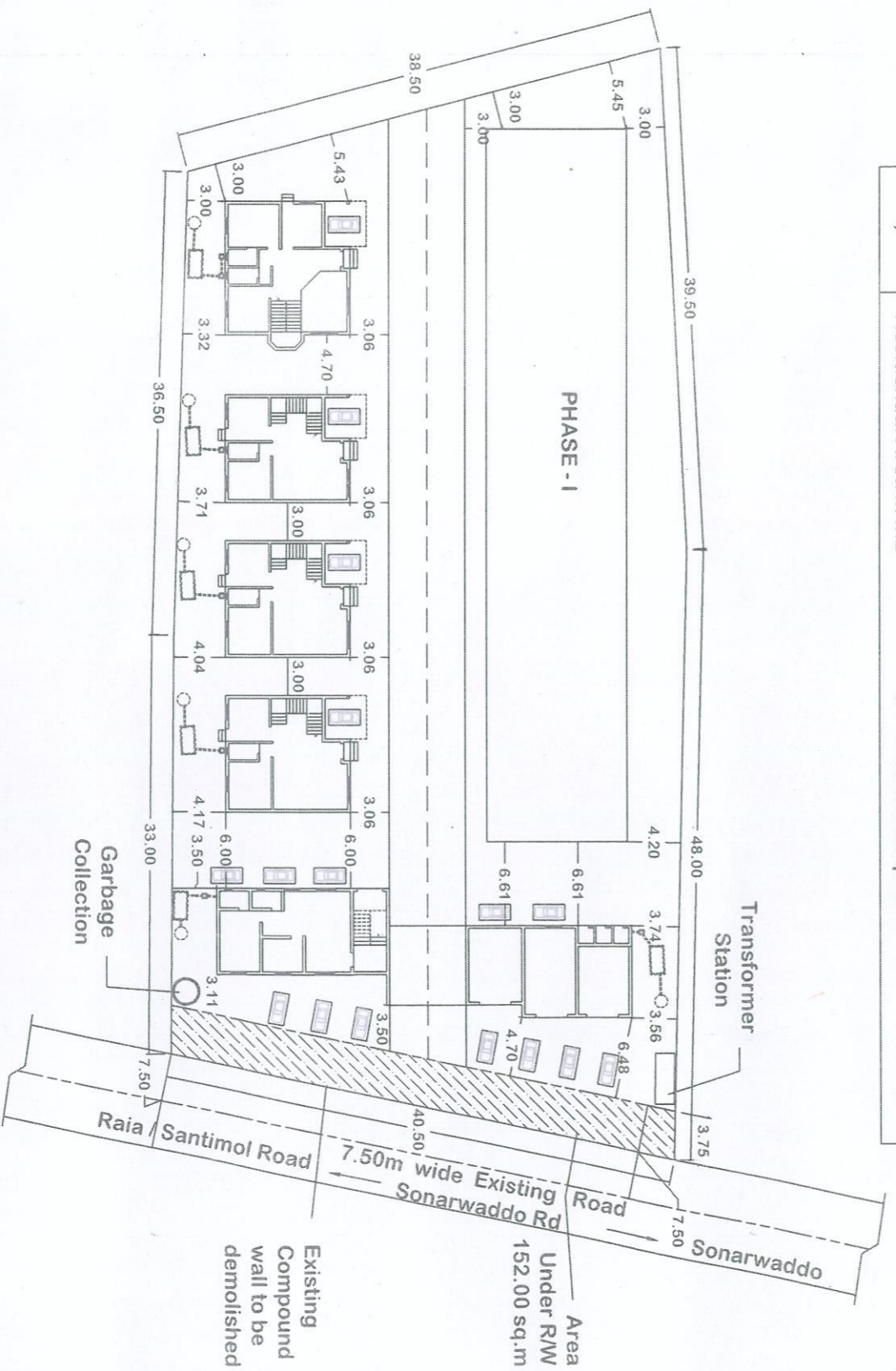

Owner.

Architect.

ARCHITECT
Megha Rane
 PONDA-GOA
 TCP Reg. No. AR/0027/2014
 COA Reg. No. CA/2011/53860

PROJECT :-

PROPOSED VILLA'S & Commercial Arcade "JEHOVAH
 NESSI" FOR Mr. Suhas Harold Sanjeevrao And Mrs. Juliana
 Fernandes LOCATED ON PLOT BEARING Sur / Sub - Div.
 NO. 101/2 at Santemol IN VILLAGE Raia, SALCETE
 TALUKA - GOA. - (PHASE - II)