

### B-BUILDING PERIPHERAL LOCATIONS

- NORTH - COMPOUND WALL/ S.NO 62
- EAST - 10.0M WIDE ODP ROAD
- SOUTH - A- BUILDING/ OPENSACE
- WEST - COMPOUND WALL/ DABOLIM RAILWAY STATION

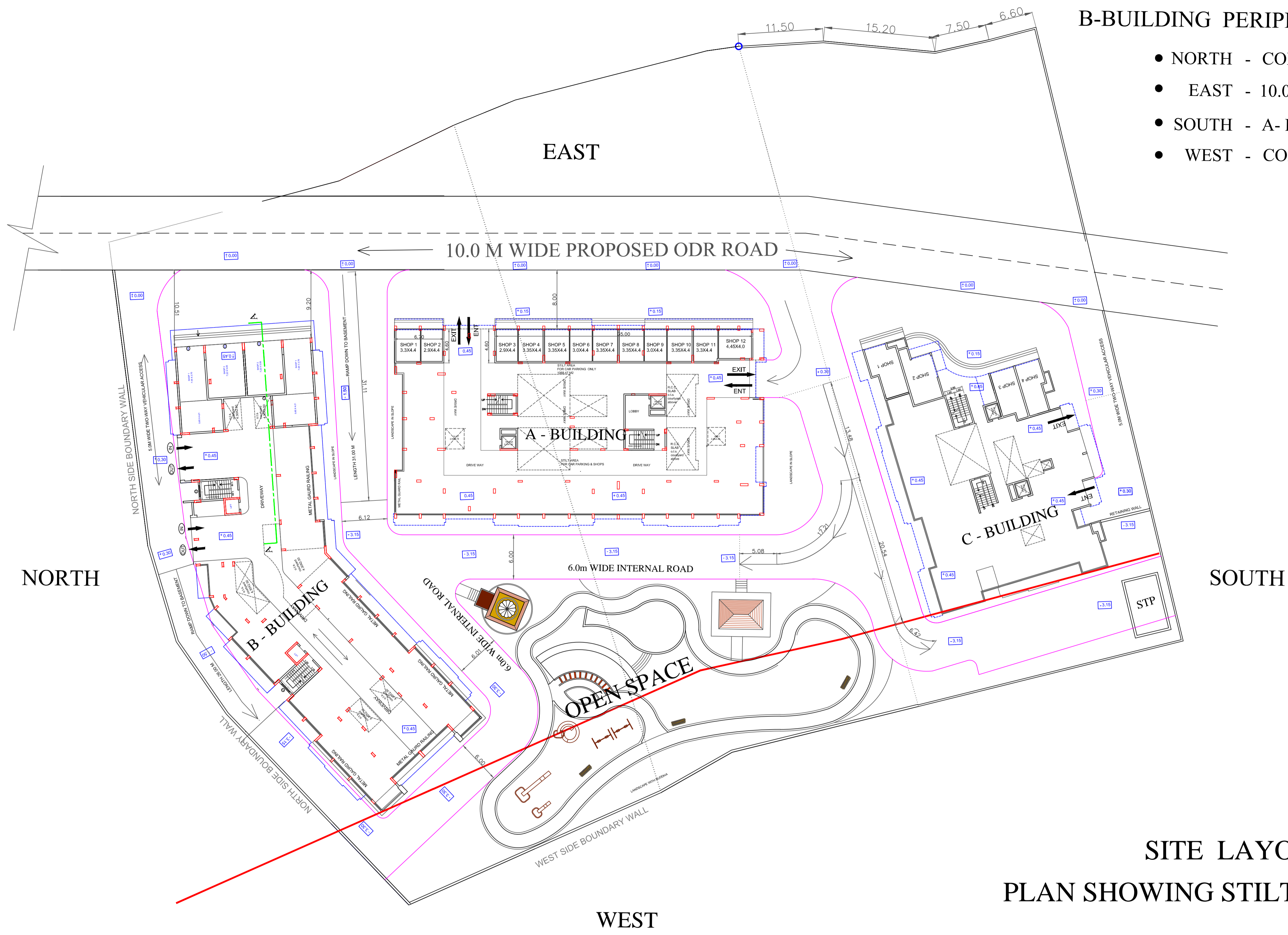

**SITE LAYOUT PLAN  
PLAN SHOWING STILT FLOOR PLANS**

S. NO. 63/2,63/3,63/4 VILLAGE - DABOLIM		PROJECT ✿ RESIDENTIAL & COMMERCIAL			OWNER ✿ MR. RAMSAGAR VASANT PRASAD	
TAL - MARGOA, GOA		drawing ✿ tentative master layout			ARCHITECTS	KETAN CHAVAN & ASSO.
SUSTAINABLE GREEN ARCHITECTURE		SCALE	DATE	DWG NO	DRAFTED BY	AR. KETAN CHAVAN FLAT NO 12, SITAKESHAR APT, BANER ROAD, AUNDH, PUNE PIN 411007
		1 :	12.01.2017	PRN/GOA/RP1	SIDDARTH	
					CONTACT - 9922111711 , 9850975752	ketanncn@gmail.com