



Government of Goa  
Form 'D'  
See Rule 7

Goa Land Revenue (City Survey) Rules, 1969  
Property Card of Panaji city

Page No. 1

Date 28/05/2013

Pt Sheet No	Chalta No	Area Sq.Mts	Tenure	Particulars of assessment or rent paid to Government and when due for revision	Category
12	8	6380.00			Private

Assessments

--- Nil ---

Holders in the origin of the title  
(So far as traced) -

[SHRI UMAKANT MORTO AGXICAR, SHRI VISHWANATH MORTO AGXICAR  
AND SHRI RAVINDRA MORTO AGXICAR IN EQUAL SHARES]

Lessees -

--- Nil ---

Other Encumbrances -

--- Nil ---

Other Remarks -

--- Nil ---

Details -

Mutation Date	Mutation Number	Mutation Type	Name Remarks	Now Holder (H), Lessee (L), Encumbrance(E)	Area (Sq.Mts)
		Partition	[ SHRI UMAKANT MORTO AGXICAR, SHRI VISHWANATH MORTO AGXICAR AND SHRI RAVINDRA MORTO AGXICAR IN EQUAL SHARES ]	H	6,380.00
18/01/2008	110254	Certificate of Purchase	[ MAHESH RAJARAM HALARNKAR ]	H	131.00
14/05/2013	110628	Deed of Sale	VAASTU ESTATE DEVELOPERS	H	

[ ] Bracketed entries indicate Deletion

For any further inquiries, please contact the ISLR of the concerned city.

\*\*\* END OF REPORT \*\*\*

CERTIFIED COPY

Copy applied for as on Vaastu Estate  
Developers dt. 24/5/13  
 Copy made on \_\_\_\_\_  
 Copy deposited on \_\_\_\_\_  
 Amount paid towards Rs \_\_\_\_\_  
 Rs \_\_\_\_\_ vide \_\_\_\_\_  
 Rs 120 Total  
 Rs 600 / \_\_\_\_\_  
 Copied by P. Kayle/Can F-687  
 Compared by P. Kayle C-1  
28/5/13





Government of Goa  
Form 'D'  
See Rule 7

Goa Land Revenue (City Survey) Rules, 1969  
Property Card of Panaji city

Page No. 1

Date 28/05/2013

Pt Sheet No	Chalta No	Area Sq.Mts	Tenure	Particulars of assessment or rent paid to Government and when due for revision	Category
12	8-A	62.00			Private

## Easements

---- Nil ----

Holdings in the origin of the title  
(So far as traced) -

[SHRI UMAKANT MORTO AGXICAR, SHRI VISHWANATH MORTO AGXICAR  
AND SHRI RAVINDRA MORTO AGXICAR IN EQUAL SHARES]

## Lessees -

---- Nil ----

## Other Encumbrances -

---- Nil ----

## Other Remarks -

---- Nil ----

## Details -

Mutation Date	Mutation Number	Mutation Type	Name Remarks	Now Holder (H), Lessee (L), Encumbrance(E)	Area ( Sq.Mts )
7/05/2013	110628	Deed of Sale	VAASTU ESTATE DEVELOPERS	H	

[ ] Bracketed entries indicate Deletion

For any further inquiries, please contact the ISLR of the concerned city.

\*\*\* END OF REPORT \*\*\*

## CERTIFIED COPY

Copy applied for as on Vaastu Estate Developers  
 dt. 24/5/13  
 Copy ready on \_\_\_\_\_  
 Copy delivered on \_\_\_\_\_  
 Advalorem fees received Rs. \_\_\_\_\_  
 Fees Rs. \_\_\_\_\_ vide \_\_\_\_\_  
 Rpt. No. 120 dated 24/5/13 Total \_\_\_\_\_  
 Fees Rs. 600/- Receipt \_\_\_\_\_

Copied by J. Kayleker RSO  
 Compared by [Signature] (H.S.)  
28/5/13





Government of Goa

Form 'D'

See Rule 7

Goa Land Revenue (City Survey) Rules, 1969

Page No. 1

Property Card of Panaji city

Date 28/05/2013

Pt Sheet No	Chalta No	Area Sq.Mts	Tenure	Particulars of assessment or rent paid to Government and when due for revision	Category
12	14	348.00			Private

## Easements

---- Nil ----

Holders in the origin of the title  
(So far as traced) -[SHRI UMAKANT MORTO AGXICAR, SHRI VISHWANATH MORTO AGXICAR  
AND SHRI RAVINDRA MORTO AGXICAR IN EQUAL SHARES]

## Lessees -

---- Nil ----

## Other Encumbrances -

---- Nil ----

## Other Remarks -

---- Nil ----

## Details -

Mutation Date	Mutation Number	Mutation Type	Name Remarks	Now Holder (H), Lessee (L), Encumbrance(E)	Area ( Sq.Mts )
14/05/2013	110628	Deed of Sale	VAASTU ESTATE DEVELOPERS	H	

[ ] Bracketed entries indicate Deletion

For any further inquires, please contact the ISLR of the concerned city.

\*\*\* END OF REPORT \*\*\*

## CERTIFIED COPY

Copy applied for as on Vaastu Estate Developers  
dt. 24/5/13  
 Copy ready on \_\_\_\_\_  
 Copy delivered on \_\_\_\_\_  
 Advance fee received Rs. \_\_\_\_\_  
 Rs. \_\_\_\_\_ vide \_\_\_\_\_  
 Amt. for \_\_\_\_\_ dated 24/5/13 Total \_\_\_\_\_  
 Fees Rs. 600/- Rupees \_\_\_\_\_

Copied by P. Kay/ekar F.D.  
 Compared by [Signature]  
28/5/13





Government of Goa

Form 'D'

See Rule 7

Goa Land Revenue (City Survey) Rules, 1969

Page No. 1

Property Card of Panaji city

Date 28/05/2013

Pt Sheet No	Chalta No	Area Sq.Mts	Tenure	Particulars of assessment or rent paid to Government and when due for revision	Category
12	15	152.00			Private

**Easements**

---- Nil ----

**Holders in the origin of the title  
(So far as traced) -**[SHRI UMAKANT MORTO AGXICAR, SHRI VISHWANATH MORTO AGXICAR  
AND SHRI RAVINDRA MORTO AGXICAR IN EQUAL SHARES]**Lessees -**

---- Nil ----

**Other Encumbrances -**

---- Nil ----

**Other Remarks -**

---- Nil ----

**Details -**

Mutation Date	Mutation Number	Mutation Type	Name Remarks	Now Holder (H), Lessee (L), Encumbrance(E)	Area ( Sq.Mts)
14/05/2013	110628	Deed of Sale	VAASTU ESTATE DEVELOPERS	H	

[ ] Bracketed entries indicate Deletion

For any further inquiries, please contact the ISLR of the concerned city.

\*\*\* END OF REPORT \*\*\*

**CERTIFIED COPY**Copy applied for as on Vaastu Estate Developers  
dt - 24/5/13

Copy ready on \_\_\_\_\_

Copy delivered on \_\_\_\_\_

Advance fees received Rs. \_\_\_\_\_

Rupees \_\_\_\_\_ vide \_\_\_\_\_

Rpt. No. 120 dt. 24/5/13 Total \_\_\_\_\_Fees Rs. 600/- \_\_\_\_\_Copied by P. Kavlekar, F.S.D.Compared by [Signature]  
28/5/13



GOVERNMENT OF GOA  
 Directorate of Settlement and Land Records  
 PANAJI - GOA

REVISED PLAN

OF THE LAND BEARING CHALTA No. 8 PART OF P.T. SHEET No. 12 SITUATED AT PANAJI CITY OF TISWADI TALUKA APPLIED BY SHRI SUNIL MORAJKAR FOR CONVERSION OF USE OF LAND FROM AGRICULTURAL TO NON-AGRICULTURAL PURPOSE VIDE CASE NO RB/CNV/TIS/AC-II/37/2012, DATED 16/07/2013, FROM THE OFFICE OF THE ADDITIONAL COLLECTOR-II, PANAJI GOA AND ALSO SHOWING THEREIN 3 MTS. WIDE ACCESS AS PER ORDER NO. RB/CNV/TIS/AC-II/37/2012 DATED 09/05/2014 OF THE ADDITIONAL COLLECTOR-II, NORTH GOA DISTRICT PANAJI

SCALE : 1:500

PROPOSED AREA FOR CONVERSION : 6242 Sq. Mts.

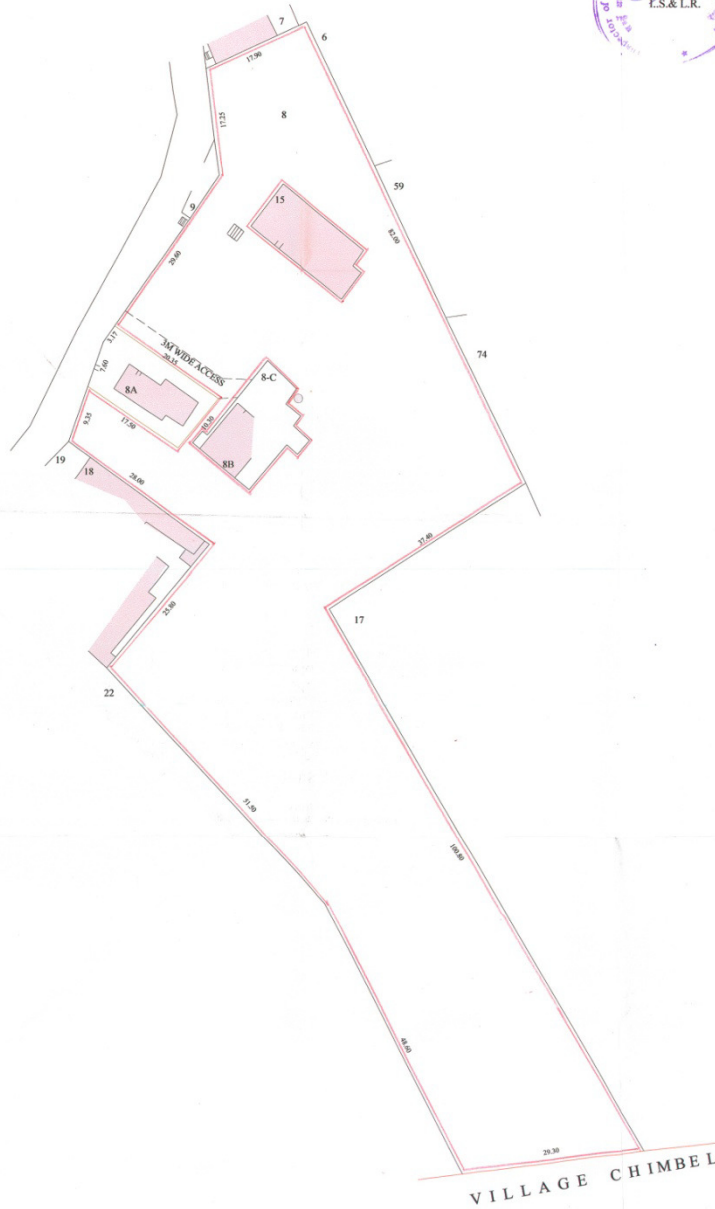

PREPARED BY:-

*Prakash*  
 11/06/2014  
 PRAKASH SHET (F.S.)

Verified By:-

*Naik*  
 11/6/14  
 PARESH NAIK (H.S.)