

GOVERNMENT OF GOA  
DIRECTORATE OF SETTLEMENT & LAND RECORDS  
PANAJI - GOA

PLAN

OF THE PROPERTY BEARING SURVEY No.4/18 SITUATED AT ST.JOSE DE AREAL VILLAGE  
OF SALCETE TALUKA APPLIED FOR CONVERSION OF USE OF LAND FROM  
AGRICULTURAL INTO NON AGRICULTURE PURPOSE BYMR.MOHAMMED ZAKEE SOUDAGAR  
VIDE ORDER NO. SDO/SAL/CONV /5/2012/9388 DATED 14/09/2012. BY DY COLLECTOR  
& SDO MARGAO GOA.

SCALE : 1:1000

AREA TO BE CONVERTED 1175.00 SQ. MTS.



I.S.&L.R.

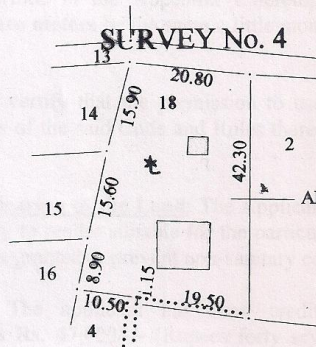

AREA TO BE CONVERTED 1175.00SQ.MTS.

P.H.PRABHU (F.S.)

PREPARED BY

SURVEYED ON: 01/11/2012

SUDESH BHAIRELI (SUP.)

VERIFIED BY

File No.: 2/ISLR/246/2012