



GOVERNMENT OF GOA
Directorate of Settlement and Land Records
Office of Inspector of Survey and Land Records
MARGAO-GOA



35/20-03/CMAR20:20183

Plan Showing plots situated at
Village : MARGAO
Taluka : SALCETE
P.T.Sheet No.6/ Chalta No.22
Scale :1:500

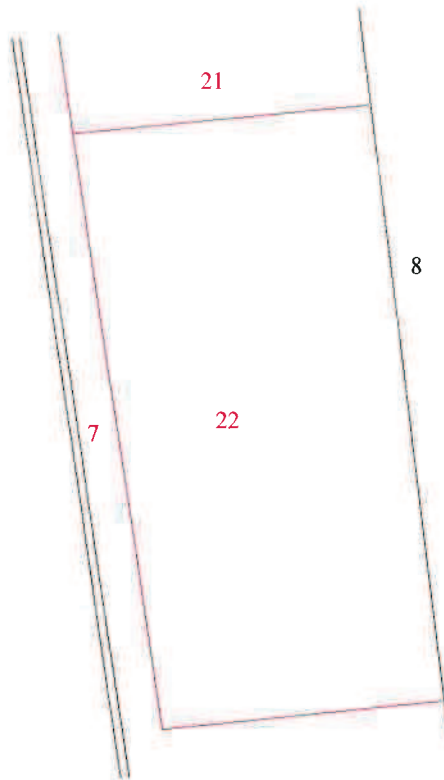

(Savio C. Siveira)
Inspector of Survey & Land Records
Margao-Goa



Generated By : Madhukar N.Joshi
On : 28.04.2020

Compared By: K.B. Gaude

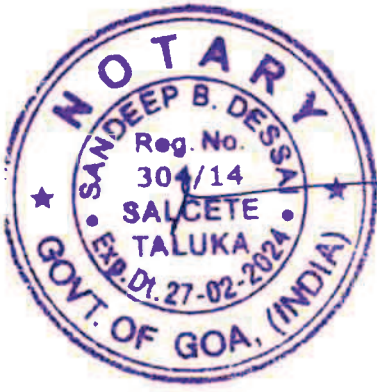
TRUE COPY



200000546797

Government of Goa

Form 'D'

See Rule 7

Goa Land Revenue (City Survey) Rules, 1969
Property Card of Margao city

Page No. 1

Date 26/08/2020

Pt Sheet No	Chalta No	Area Sq.Mts	Tenure	Particulars of assessment or rent paid to Government and when due for revision	Category
6	22	759.00			Private

Easements

----- Nil -----

Holders in the origin of the title

(So far as traced) -

[SHRI:- PAULO FALEIRO]

Lessees -

----- Nil -----

Other Encumbrances -

----- Nil -----

Other Remarks -

----- Nil -----

Details -

Mutation Date	Mutation Number	Mutation Type	Name Remarks	Now Holder (H), Lessee (L), Encumbrance(E)	Area (Sq.Mts)
25/08/2020	312450	Deed of Succession	1. MRS REMEDIANA COLACO 2. MRS ANITA SAVINA FALEIRO 3. MRS SHARON FALEIRO 4. MRS FALVIA FALEIRO 5. MR POLLIE FALEIRO By virtue of Deed of Succession dated 23/02/2009, registered in the Notary Ex-Officio Salcete (Margao-Goa).	H	

[] Bracketed entries indicate Deletion

For any further inquiries, please contact the ISLR of the concerned city.

*** END OF REPORT ***

