

FLOOR	AREA STATEMENT FREE OF F.A.R							LESS 7.5% ADDITIONAL F.A.R LOBBY/SERVICES (SQ.M.)	NET F.A.R (SQ.M.)
	TOTAL B.U.A (SQ.M.)	STAIR (SQ.M.)	LIFT (SQ.M.)	BALCONY (SQ.M.)	ATRIUM (SQ.M.)	TERRACE (SQ.M.)	PARKING (SQ.M.)		
	A	B	C	D	E	F	G		
LOWER BASEMENT FLOOR	3813.75	20.18	21.72	0.00	0.00	0.00	3581.55	190.30	0.00
UPPER BASEMENT FLOOR	3793.08	18.31	21.72	0.00	0.00	0.00	3702.50	50.55	0.00
GROUND FLOOR	2457.63	81.02	0.00	60.74	400.29	0.00	550.49	103.71	1261.38
1ST FLOOR	2445.34	82.33	21.72	387.43	449.28	0.00	0.00	58.78	1445.80
2ND FLOOR	2100.87	56.69	21.72	496.99	0.00	0.00	0.00	54.71	1470.76
3RD FLOOR	2100.87	56.69	21.72	496.99	0.00	0.00	0.00	54.71	1470.76
4TH FLOOR	2100.87	56.69	21.72	496.99	0.00	0.00	0.00	54.71	1470.76
5TH FLOOR	2100.87	56.69	21.72	496.99	0.00	0.00	0.00	54.71	1470.76
6TH FLOOR	2100.87	56.69	21.72	496.99	0.00	0.00	0.00	54.71	1470.76
7TH FLOOR	2100.87	56.69	21.72	496.99	0.00	0.00	0.00	54.71	1470.76
8TH FLOOR	2100.87	56.69	21.72	496.99	0.00	0.00	0.00	54.71	1470.76
TOTAL	27215.90	598.67	217.20	3927.10	849.57	0.00	7834.54	786.31	13002.50

COVERED AREA = (257.63-373.23) = 2084.40 M²
 F.A.R = 13002.50 M²

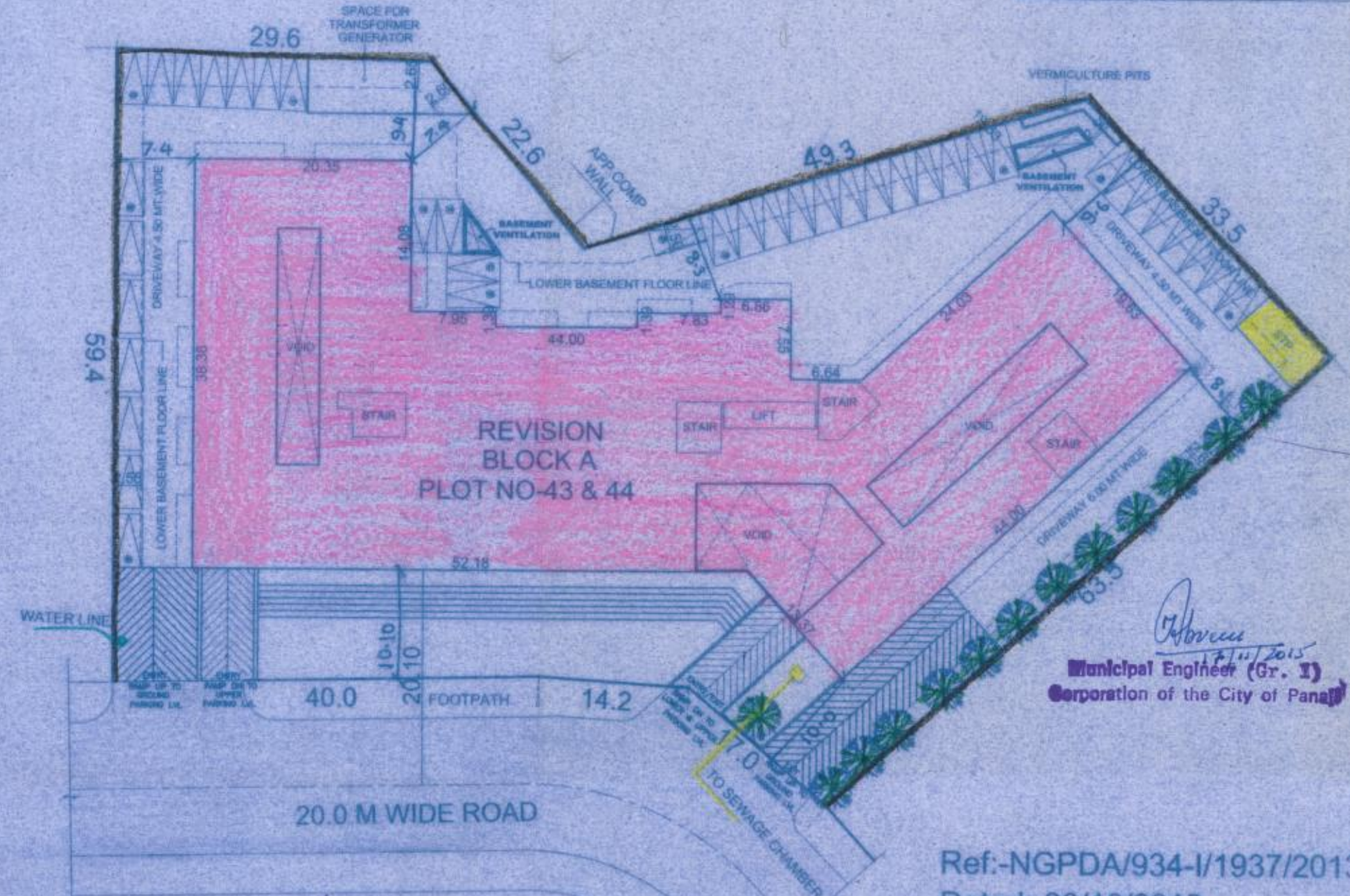

APPROVED FROM PLANNING P.O. No. 147/1937/15
 SUBJECT TO CONDITIONS GIVEN
 VIDE ORDER No. NG PDA/934-1/15
 DATED 9 SEP 2015
SITE PLAN
 SCALE-1:500

Ref:-NGPDA/934-II/1937/2013
 Dated:-30/10/2013
 Ref:-NGPDA/934/591/2008
 Dated:-22/05/2008

MEMBER SECRETARY
 NORTH GOA
 PLANNING & DEV. AUTHORITY
 PANJIM - GOA

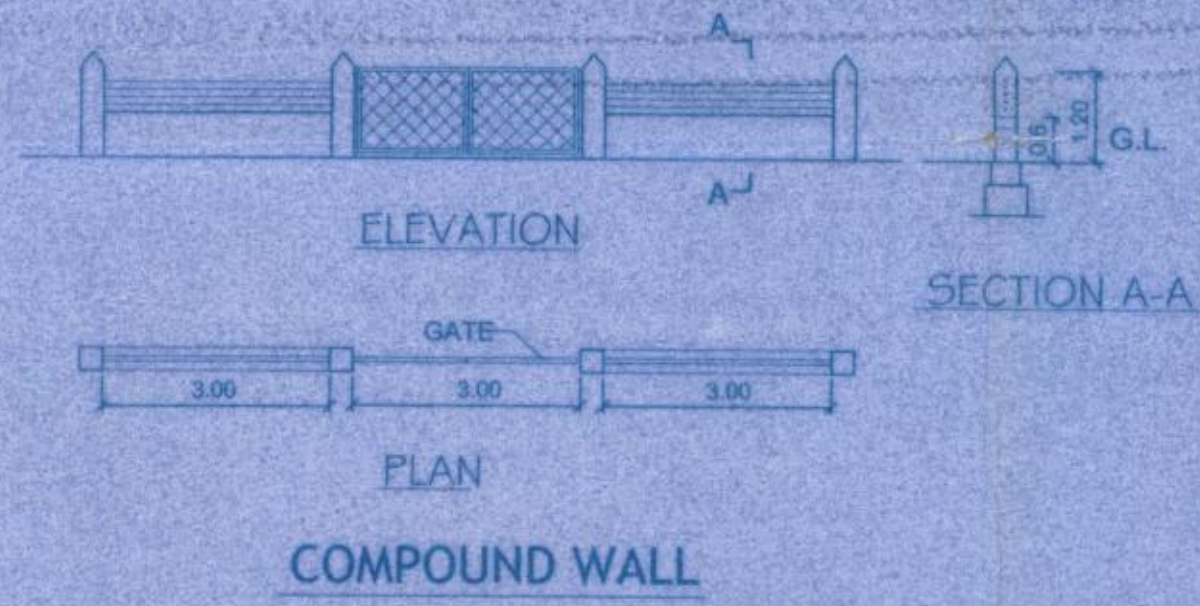

CAR PARKING

REQUIRED PARKING (13002.50/50) =	260 Nos.
LOWER BASEMENT PARKING	=137 Nos.
UPPER BASEMENT PARKING	=139 Nos.
STILT PARKING	= 29 Nos.
SURFACE PARKING	= 39 Nos.
PARKING PROVIDED	=344 Nos.

AREA STATEMENT

A AREA UNDER PLAT 43 & 44	5213.10 m ²
B AREA UNDER ROAD WIDENING	nil
C NET PLOT AREA	5213.10 m ²
D PERMISSIBLE COVERED AREA (c X 40%)	2085.24 m ²
E PERMISSIBLE FAR (CS) (a X 2.50)	13032.75 m ²
F APPROVED COVERED AREA	2075.00 m ²
G APPROVED COVERAGE	39.80 %
H PROPOSED COVERED AREA	9.40 m ²
I PROPOSED COVERAGE	0.18%
J TOTAL (APP.+PRO.) COVERED AREA	2084.40 m ²
K PROPOSED COVERAGE	39.98 %
L APPROVED F.A.R	13.030.00 m ²
M PROPOSED F.A.R	13.002.50 m ²
N TOTAL F.A.R CONSUMED	2.49

PROJECT:
 PROPOSED REVISION ON PLOT NO 43 & 44 IN EDC PATTO PLAZA, SITUATED AT PANAJI - GOA.

OWNER
M/s PARSVNATH DEVELOPERS LTD

DRN BY: V.G DRGS:
 DRG NO: SUB-01 SITE PLAN, AREA STATEMENT
 JOB NO: 564/13 COMPOUND WALL

DATED: SCALE: 1:100

ARCHITECT'S SIGNATURE: CLIENT'S SIGNATURE:

Bryan J. Soares
 Reg. No. CA/89/12085
 AR/0031/2010

ARCHITECTS:
SOARES & ASSOCIATES
 G-1, VIKAS BUILDING,
 18TH JUNE ROAD,
 PANJIM, GOA.
 PH./FAX : 2228040, 2430010
 e-mail: soares88@gmail.com