

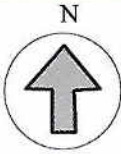

GOVERNMENT OF GOA
Directorate of Settlement and Land Records
PANAJI-GOA

Inward No.:-12117



Plan Showing plots situated at
 Village : ANJUNA
 Taluka : BARDEZ
 Survey No./Subdivision No. : 398/ 14-B
 Scale :1:1000

A. Matondkar
 A. Matondkar

Inspector of Survey &
 Land Records.

SURVEY No. 398

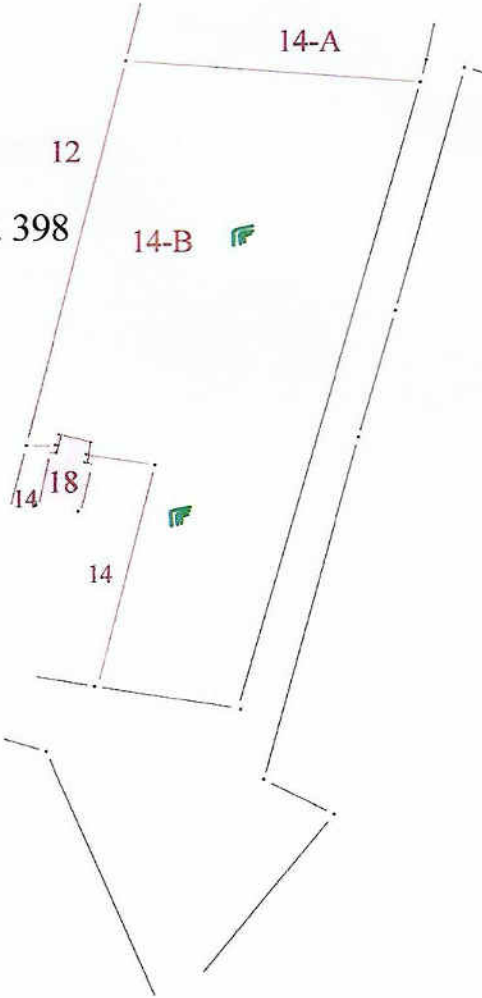

Manoj Naik
 Generated By : Manoj Naik (D'Man Gr.II)
 On : 02-12-2015

Damodar C. Dabholkar
 Compared By: Damodar C. Dabholkar (D'Man Gr.I)



GOVERNMENT OF GOA
 Directorate of Settlement and Land Records
 PANAJI - GOA

Inward No.12116

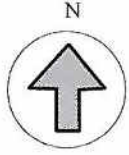

Plan Showing plots situated at
 Village : ANJUNA
 Taluka : BARDEZ
 Survey No./Subdivision No. : 398/ 14-A
 Scale : 1 :1000

Onhe
 A. Matondkar

Inspector of Survey &
 Land Records.

SURVEY No. 398

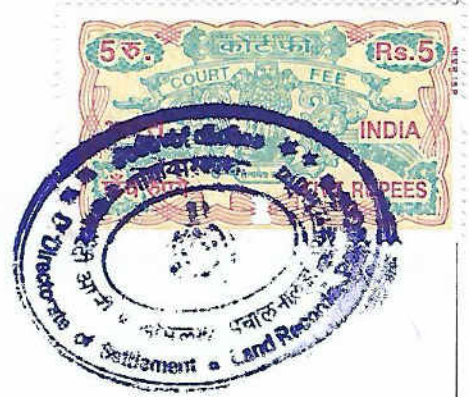

Manoj Naik

Generated By :Manoj Naik (D'Man Gr.II)
 On : 27-11-2015

Damodar C. Dabholkar
 30/11/15

Compared By: Damodar C. Dabholkar (D'Man Gr.I)