



Government of Goa

Form 'D'

See Rule 7

Goa Land Revenue (City Survey) Rules, 1969

Property Card of Margao city

Page No. 1

Date 27/08/2015



Pt Sheet No	Chalta No	Area Sq.Mts	Tenure	Particulars of assessment or rent paid to Government and when due for revision	Category
136	87	645.00			Private

Easements

--- Nil ---

Holders in the origin of the title

(So far as traced) -

[GOVIND SAJI RAICAR]

[ANANTA SAJI RAICAR]

Lessees -

--- Nil ---

Other Encumbrances -

--- Nil ---

Other Remarks -

--- Nil ---

Details -

Mutation Date	Mutation Number	Mutation Type	Name Remarks	New Holder (H), Lessee (L), Encumbrance(E) Other Remarks(R) Easements(A)	Area (Sq.Mts)
08/01/2015	311484	Deed of Sale	M/s WEST END REAL ESTATE BUILDERS AND DEVELOPERS by Virtue of Deed of Sale of Book-1 Document Reg. No MGO-BK1- 03915-2014 at CD Number MGOD79 dated 27-08-2014 registered in the office of the Sub registrar Margao Goa. and by Virtue of Deed of Rectification of Book-1 Document Reg. No MGO-BK1- 04361-2014 at CD Number MGOD79 dated 29-09-2014 registered in the office of the Sub registrar Margao Goa.	H	645.00

[] Bracketed entries indicate Deletion

For any further inquires, please contact the ISLR of the concerned city.

*** END OF REPORT ***



Government of Goa

Form 'D'

See Rule 7

Goa Land Revenue (City Survey) Rules, 1969

Property Card of Margao city

Page No. 1

Date 27/08/2015



Pt-Sheet No Chaffa No

136

150

Area
Sq.Mts

81.00

Tenure

Particulars of assessment
or rent paid to Government
and when due for revision

Category

Private

Easements

--- Nil ---

Holders in the origin of the title

(So far as traced) -

[2- ANANTA SAJI RAICAR]

[a] 1- GOVIND SAJI RAICAR]

Lessees -

---- Nil ----

Other Encumbrances -

---- Nil ----

Other Remarks -

---- Nil ----

Details -

Mutation Date	Mutation Number	Mutation Type	Name Remarks	New Holder (H), Lessee (L), Encumbrance(E) Other Remarks(R) Easements(A)	Area (Sq.Mts)
08/01/2015	311484	Deed of Sale	M/s WEST END REAL ESTATE BUILDERS AND DEVELOPERS by Virtue of Deed of Sale of Book-1 Document Reg. No MGO-BK1- 03915-2014 at CD Number MGOD79 dated 27-08-2014 registered in the office of the Sub registrar Margao Goa. and by Virtue of Deed of Rectification of Book-1 Document Reg. No MGO-BK1- 04361-2014 at CD Number MGOD79 dated 29-09-2014 registered in the office of the Sub registrar Margao Goa.	H	81.00

[] Bracketed entries indicate Deletion

For any further inquires, please contact the ISLR of the concerned city.

*** END OF REPORT ***



Government of Goa

Form 'D'

See Rule 7

Goa Land Revenue (City Survey) Rules, 1969

Property Card of Margao city

Page No. 1

Date 27/08/2015



Pt Sheet No	Chakta No	Area Sq.Mts	Tenure	Particulars of assessment or rent paid to Government and when due for revision	Category
136	151	11.00			Private

Easements

--- Nil ---

**Holders in the origin of the title
(So far as traced) -**

[2- ANANTA SAJI RAICAR]
[a] 1- GOVIND SAJI RAICAR]

Lessees -

---- Nil ----

Other Encumbrances -

--- Nil ---

Other Remarks -

--- Nil ---

Details -

Mutation Date	Mutation Number	Mutation Type	Name Remarks	New Holder (H), Lessee (L), Encumbrance(E) Other Remarks(R) Easements(A)	Area (Sq.Mts)
08/01/2015	311484	Deed of Sale	M/s WEST END REAL ESTATE BUILDERS AND DEVELOPERS by Virtue of Deed of Sale of Book-1 Document Reg. No MGO-BK1- 03915-2014 at CD Number MGOD79 dated 27-08-2014 registered in the office of the Sub registrar Margao Goa. and by Virtue of Deed of Rectification of Book-1 Document Reg. No MGO-BK1- 04361-2014 at CD Number MGOD79 dated 29-09-2014 registered in the office of the Sub registrar Margao Goa.	H	11.00

[] Bracketed entries indicate Deletion

For any further inquires, please contact the ISLR of the concerned city.

*** END OF REPORT ***



GOVERNMENT OF GOA
 Directorate of Settlement and Land Records
 Office of Inspector of Survey and Land Records
 MARGAO - GOA

Inward No:1138



Plan Showing plots situated at
 City : MARGAO
 Taluka : SALCETE
 P.T.SheetNo. 136 / Chalta No.87,104,150 & 151
 Scale : 1 : 500

[Signature]
 23/10/12
 Inspector of Survey &
 Land Records.

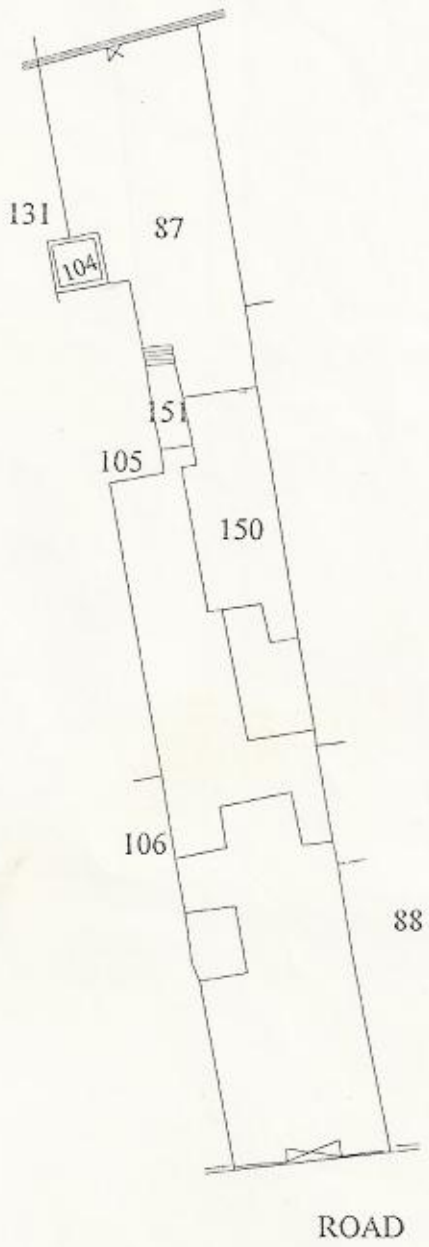

[Signature]
 Generated By : DILIP NAIK
 On : 23-10-2012

[Signature]
 23/10/12
 Compared By: