



**Government of Goa**  
**Directorate of Settlement and Land Records**

**Survey Plan**  
**Bardez Taluka, Pilerne Village**  
**Survey No.: 36 , Subdivision No.: 1**



Scale 1:4000

Reference No.: CBAR123-2923-1077987

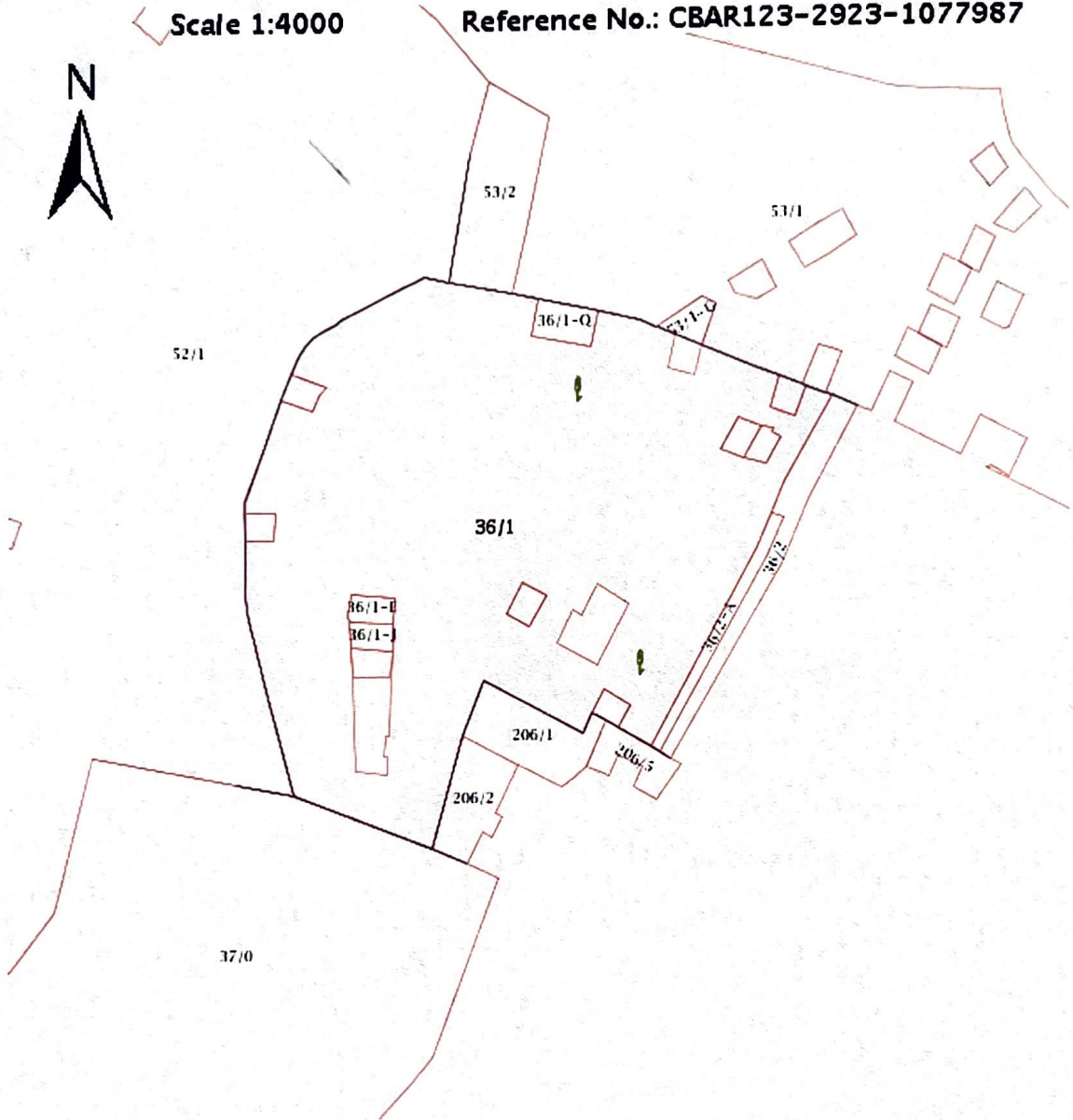

This record is computer generated on 02-02-2023 04:26:16. This record is valid without any signature as per Govt of Goa Notification No. 26/13/2016-RD/8639 dtd 24-Apr-2021. The latest copy of this record can be seen/verified for authenticity on the DSLR website <https://dslr.goa.gov.in/>.

**NOTE: PLAN TO BE PRINTED ON A4 SIZE**