

LENGTH OF PROPOSED COMPOUND WALL = 174.60 RMTS.

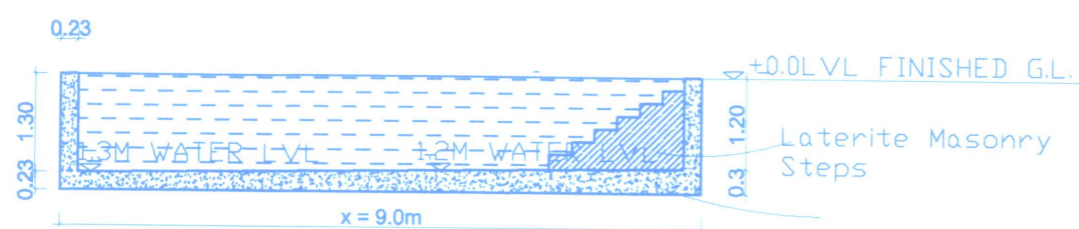

SECTION BB - TYPICAL POOL
Scale:- 1:100

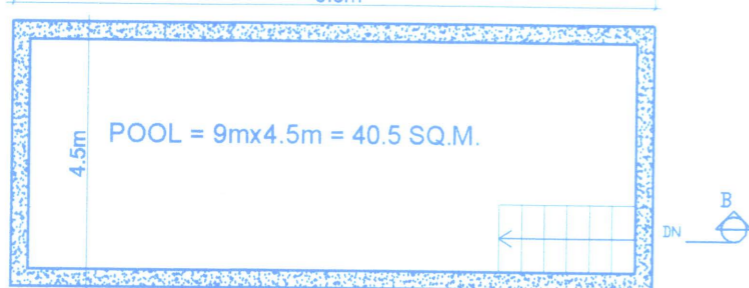

PLAN OF POOL
Scale:- 1:100

01	TOTAL AREA OF SY.NO. 29/10	2000 M2
02	AREA UNDER NATURAL COVER	620.10 M2
03	AREA UNDER NDZ + NATURAL COVER	392.90 M2
04	AREA OF SY.NO.29/10 IN SETTLEMENT (01- 02 - 03) =	987.00 M2
05	AREA FOR ROAD WIDENING	67.0 M2
06	EFFECTIVE PLOT AREA (04 - 05) =	920.0 M2
07	TOTAL AREA OF SY.NO. 29/10	2000 M2
08	AREA OF SY.NO.29/10 IN SETTLEMENT	987.0 M2
09	AREA FOR ROAD WIDENING	67.0 M2
10	EFFECTIVE PLOT AREA	920.0 M2
11	COVERAGE PERMISSIBLE (40 %)	368.0 M2
12	PROPOSED COVERAGE (31.09%)	286.04 M2
13	F.A.R. PERMISSIBLE (80 %)	789.84 M2
14	PROPOSED F.A.R (76.45%)	754.56 M2
14a	GROUND FLOOR FAR	251.52 M2
14b	FIRST FLOOR FAR	251.52 M2
14c	SECOND FLOOR FAR	251.52 M2
15	TOTAL BUILT-UP AREA	885.53 M2
15a	GROUND FLOOR BUA	286.04 M2
15b	FIRST FLOOR BUA	297.24 M2
15c	SECOND FLOOR BUA	302.25 M2

AREA STATEMENT - RESIDENTIAL BLDG

FLOORS	TOTAL B.U.A (sq.mts)	AREA STATEMENT AREA FREE OF F.A.R						NET F.A.R (sq.mts)	
		STAIRS	ATRIUM	CCTV/SER	VER/BALC	TERRACE	PORCH		
GROUND FLOOR	286.04	34.52					34.52	251.52	
FIRST FLOOR	297.24	34.52			11.2		45.72	251.52	
SECOND FLOOR	302.25	34.52			16.21		50.73	251.52	
TOTAL	885.53	= BUA						130.97	FAR = 754.56 M2

COVERAGE = 286.04 SQ.M.

INFRASTRUCTURE TAX AREA STATEMENT - RESIDENTIAL BLDG

FLOORS	NET F.A.R (sq.mts)	AREA STATEMENT AREAS TO BE INCLUDED IN F.A.R						TOTAL B.U.A (sq.mts)	
		STAIRS	ATRIUM	CCTV/SER	VER/BALC	TERRACE	PORCH		
GROUND FLOOR	251.52	34.52					34.52	286.04	
FIRST FLOOR	251.52	34.52			11.2		45.72	297.24	
SECOND FLOOR	251.52	34.52			16.21		50.73	302.25	
TOTAL FAR =	754.56 M2							130.97	BUA = 885.53 M2
RESIDENTIAL BLDG. BUA = 885.53 M2									
POOL = 9mx4.5m = 40.5 SQ.M.									
TOTAL INFRASTRUCTURE TAX AREA = 926.03 SQ.M.									

APPROVED VIDE PERMISSION
o. VP/RM/F-(CM/7/Bldgs/10) 2022-23/103

Date: 29.1.22



Secretary
Village Panchayat Reismagos

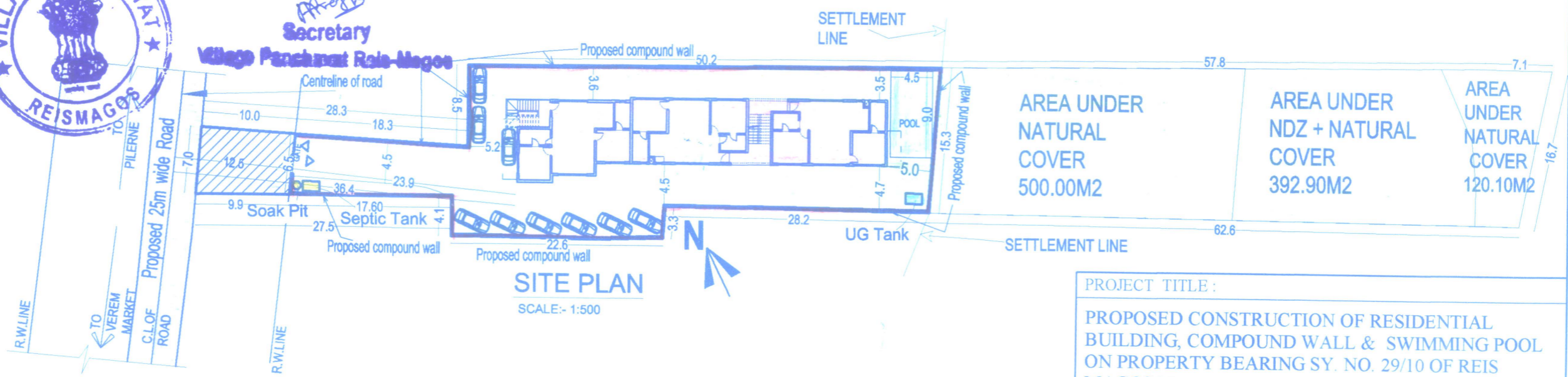

SITE PLAN
SCALE:- 1:500

Approved with condition vide
L. No.: JP/670/KM/TP/24/1342
Dy. Town Planner
Town & Country Planning Dept.
Govt. of Goa, Mapusa

PROJECT TITLE:	
PROPOSED CONSTRUCTION OF RESIDENTIAL BUILDING, COMPOUND WALL & SWIMMING POOL ON PROPERTY BEARING SY. NO. 29/10 OF REIS MAGOS VILLAGE, BARDEZ TALUKA, GOA.	
FOR- RYAGO HOTELS PVT. LTD.	
SUBMISSION DRAWING	SHEET NO.1
OWNER'S SIGN	CONSULTANT SIGN
PARESH GAITONDE BE(CIVIL) AMIE ETY CHARTERED ENGINEER T.C.P. Reg. No. 24105/2000	