

APPROVED FROM PLANNING POINT
 SUBJECT TO CONDITIONS GIVEN
 VIDE ORDER NO: GPPDA/705(TA)/1079/2022
 DATED 5 JAN 2022

AREA STATEMENT

1. AREA OF THE PLOT = 525.00 SMT
2. AREA UNDER ROAD WIDENING = NIL
3. EFFECTIVE AREA OF PLOT = 525.00 SMT
4. F.A.R ALLOWED = (EFFECTIVE PLOT AREA X 1.0) = 525.00 (PERMISSIBLE F.A.R)
5. ACHIEVED F.A.R OF PROPOSED BUILDING = 524.04 SMT = 99.82%
6. PERMISSIBLE COVERED AREA = 40% i.e = 210 SMT
7. COVERED AREA OF PROPOSED BUILDING = 29.54% i.e = 155.13 SMT

[Signature]
 5/1/2022
MEMBER SECRETARY
 Greater Panaji
 Planning & Dev. Authority
 Panaji-Goa

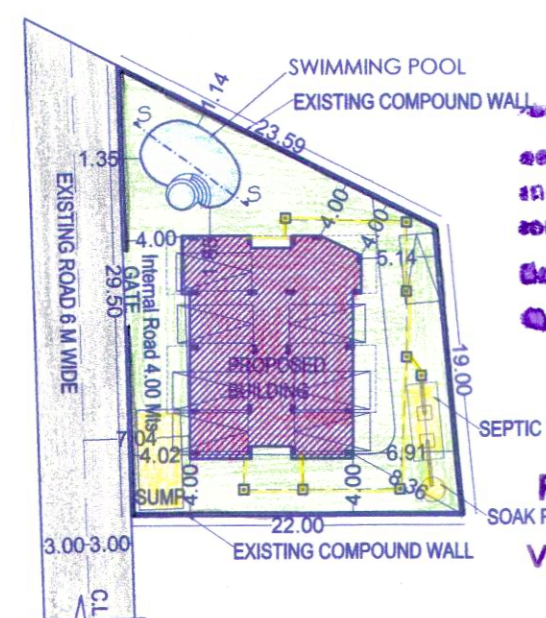

Meeting held on 30/03/2022
 under resolution No. 255
 subject to conditions as per permission
 NPM/Const/10/06/22-23/178
 18/11/2022

ROHIDAS A. PEREIRA
 Secretary
 Village Panchayat of Taleigao

SITE PLAN
 SCALE - 1:500

FLOOR % REFERENCE	USE	TOTAL BUILT UP AREA IN SQ.M.	AREA FREE FROM F.A.R.				TOTAL DEDUCTION AREA IN SQ.M.	NET FLOOR AREA
			BALCONY/VERANDAH	DUCTS	STAIRS/LIFT PASSAGE	TERRACE		
STILT FLOOR	PARKING	155.13	---	4.13	21.43	---	---	
UPPER GROUND	RESIDENTIAL	179.82	25.84	4.13	21.43	0.00	51.40	
FIRST FLOOR	RESIDENTIAL	179.82	20.74	4.13	21.43	0.00	46.30	
SECOND FLOOR	RESIDENTIAL	179.82	25.84	4.13	21.43	0.00	51.40	
THIRD FLOOR	RESIDENTIAL	179.82	20.74	4.13	21.43	0.00	46.30	
TOTAL		874.41	93.16	20.65	107.15	0.00	195.40	

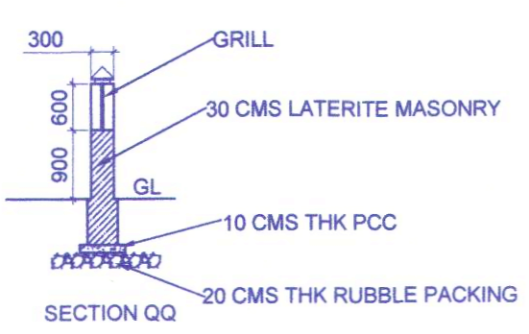
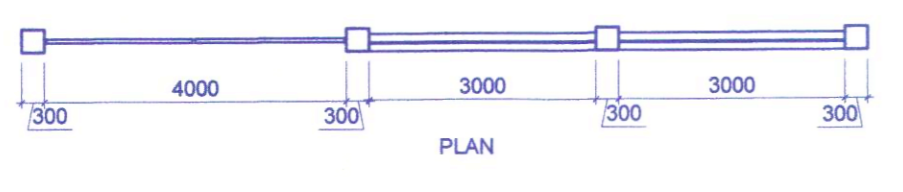
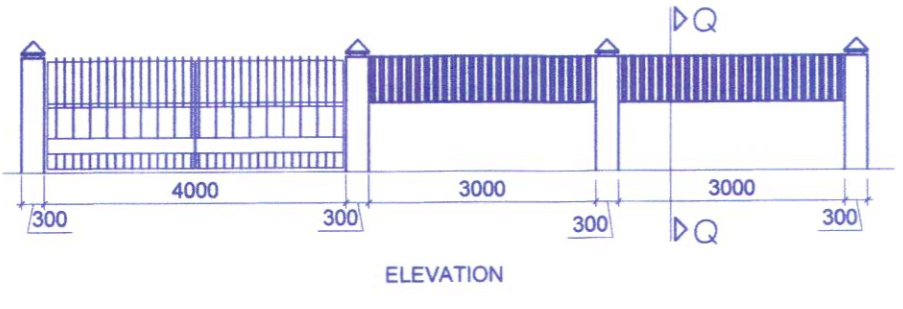

COMPOUND WALL DETAILS
 SCALE - 1:100

9. ADDITIONAL F.A.R
 ADDITIONAL FREE F.A.R AS PER REGULATION 63(K)= 7.5% OF PROPOSED F.A.R
 = 522.74 X 0.075
 = 39.20 SQM

FLOOR	USE	AREA
STILT FLOOR	PASSAGE	---
GROUND FLOOR	PASSAGE	9.18
FIRST FLOOR	PASSAGE	9.18
SECOND FLOOR	PASSAGE	9.18
THIRD FLOOR	PASSAGE	9.18
TOTAL		36.72

Approved with condition vide No.
 PHC/Chimbel/Const/2021-22-2826
 Date: 21-2-22

[Signature]
Medical Officer I/C
 Primary Health Centre
 Chimbeli

11. PARKING DETAILS

FLOOR AREA	USE	NO. OF CAR PARKS/PARKING AREA	
		PROVIDED	REQUIRED
1. 1.25 CAR FOR EVERY DWELLING UNIT - FLOOR AREA 75 SQM UPTO 100 SQM	RESIDENTIAL	1	1.25
2. 1.50 CAR FOR EVERY DWELLING UNIT - FLOOR AREA MORE THAN 100 SQM UPTO 150 SQM	RESIDENTIAL	7	6.00
TOTAL		8	7.25

12. TOTAL LENGTH OF BALCONIES

FLOOR	BUILDING PERIMETER(M)	BALCONY LENGTH(M)	BALCONY AREA(SMT)
GROUND FLOOR	64.43	28.12	25.84
FIRST FLOOR	64.43	24.72	20.74
SECOND FLOOR	64.43	28.12	25.84
THIRD FLOOR	64.43	24.72	20.74
TOTAL	257.72	105.68	93.16

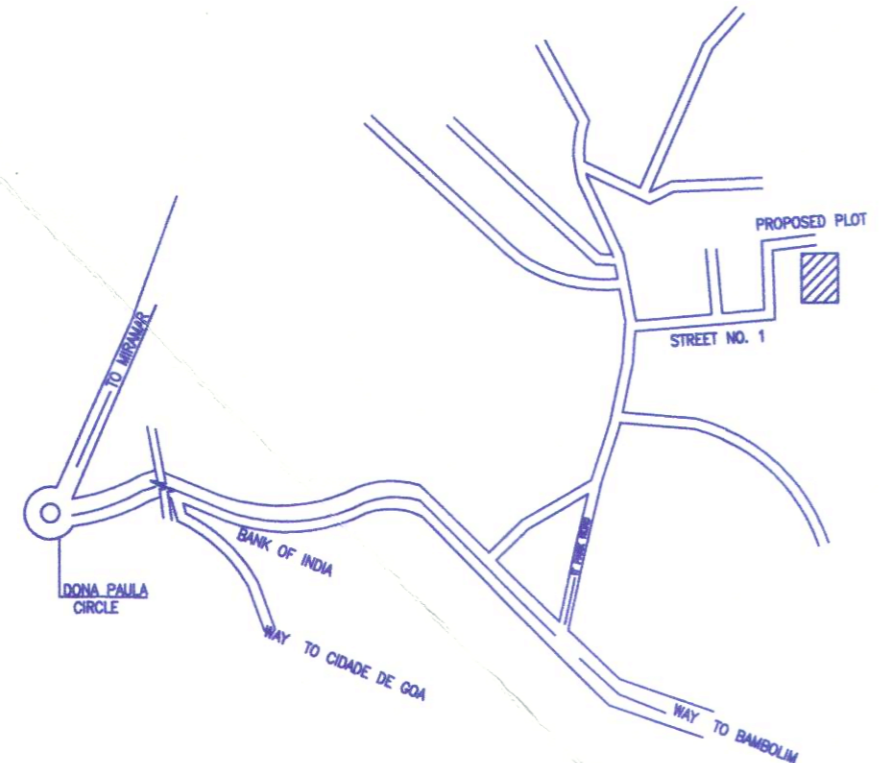

LOCATION PLAN
 NTS.

SCHEDULE OF OPENING		
TYPE	DESCRIPTION	SIZE
D	T.W. FRAME WITH T.W. PANNELED DOOR	1.20X2.10
D1	T.W. FRAME WITH FLUSH SHUTTERS	0.90X2.10
D2	T.W. FRAME WITH FLUSH SHUTTERS	0.80X2.10
SD1	SLIDING DOORS WITH ALUMINIUM FRAME	3.40X2.10
SD2	SLIDING DOORS WITH ALUMINIUM FRAME	3.98X2.10
SD3	SLIDING DOORS WITH ALUMINIUM FRAME	1.76X2.10
FG	FIXED GLASS WITH ALUMINIUM FRAME	1.14X2.10
W	AL. FRAME GLAZED WINDOW	3.40X1.60
W1	AL. FRAME GLAZED WINDOW	2.00X1.00
W2	SLIDING DOORS WITH ALUMINIUM FRAME	1.30X1.00
V	AL. FRAME LOUVERED VENTILATOR	0.60X0.80

APPROVED FROM ELECTRICAL POINT
 SUBJECT TO CONDITION
 STIPULATED WIDE LETTER
 NO. SDE/SID/TECH-10/TCU/21-22/1003dt 07/02/2022

[Signature]
ASSISTANT ENGINEER (O&M)
 O/O THE SUB-DIVISIONAL ENGINEER
 ELECT SUB-DIV-IV
 TALEIGAO

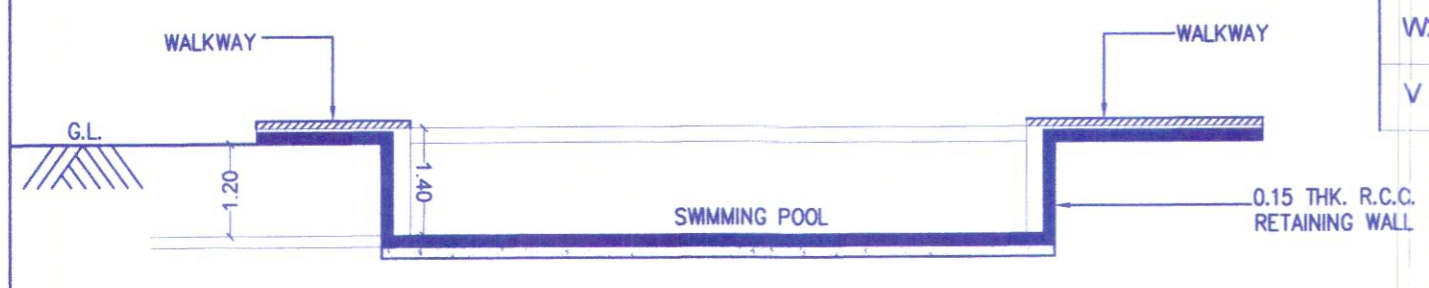

SECTION S-S

SWIMMING POOL DETAILS
 SCALE - 1:100

NOTES: This drawing is copyright property of Architect/Engineer. All dimensions are in meters This drawing is to be read & not to be scaled	NORTH 	Client: Savio Anthony Martins P.O.A HOLDER	Drawing Description: SUBMISSION DRAWING	Architect/Engineer: <i>[Signature]</i> Eng Cedric A. Vaz B.E.(CIVIL) Reg. No. 55065/2011 Panaji-Goa	Project Description: Proposed Residential Complex For Savio Anthony Martins At Dona Paula, Survey No/ Subdivision No: 279/1						
		<table border="1"> <tr> <th>DRAWN</th> <th>CHECKED</th> <th>DRG.NO.</th> <th>DATE</th> </tr> <tr> <td>S.D</td> <td>S.D</td> <td>DP/01</td> <td>8/10/2021</td> </tr> </table>	DRAWN	CHECKED	DRG.NO.	DATE	S.D	S.D	DP/01	8/10/2021	
DRAWN	CHECKED	DRG.NO.	DATE								
S.D	S.D	DP/01	8/10/2021								