

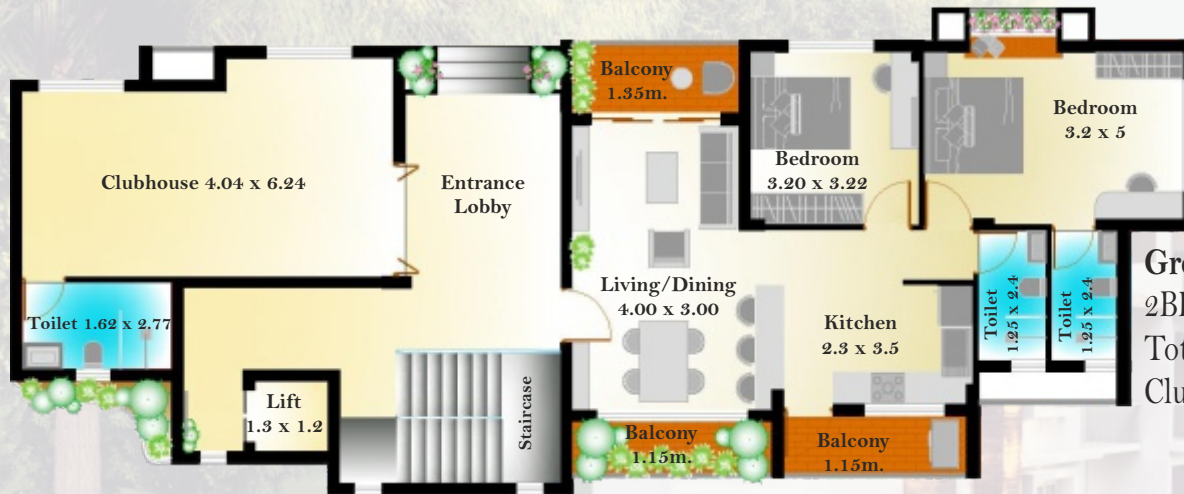

# RAIKAR VASTU

- Gated Complex (Total 8 Units)
- Car Parking
- CCTV Surveillance
- Electric Car Charging Points
- High Speed Elevator (Lift)
- Common Covered Terrace
- Paved internal drive way
- Clubhouse with attached toilet
- JSW Neo Steel 550D
- Ultratech Super Cement 53 grade





### Ground Floor

2BHK

Total Builtup area = 96 sqm

Clubhouse = 40 sqm

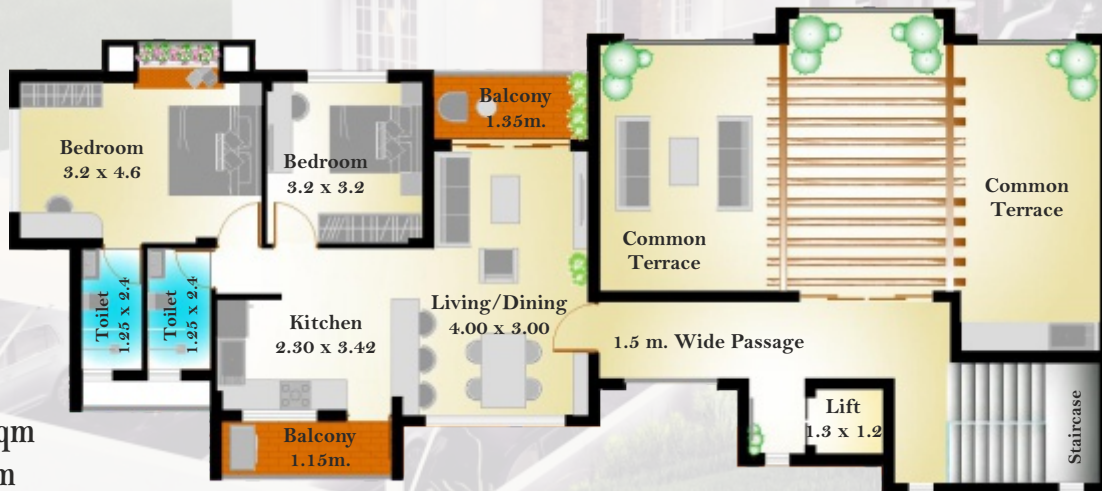

### Second Floor

2BHK

Total Builtup area = 96 sqm

Covered Terrace = 62 sqm



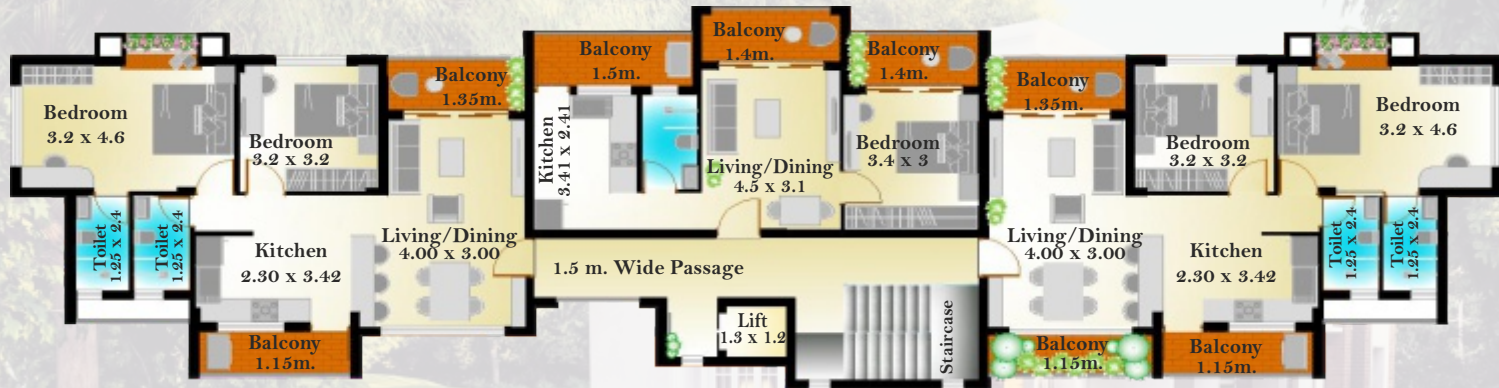

### Upper Ground floor

2BHK - Total Builtup area = 96 sqm

1BHK - Total Builtup area = 71 sqm

2 BHK - Total Builtup area = 96 sqm

### First Floor

2BHK - Total Builtup area = 96 sqm

1BHK - Total Builtup area = 71 sqm

2 BHK - Total Builtup area = 96 sqm

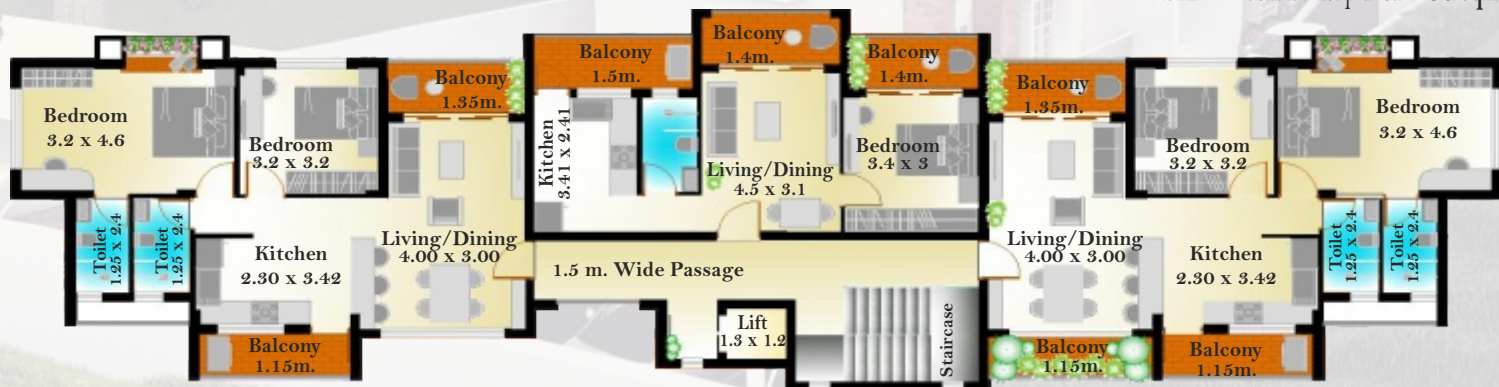



**Location** 

Succoro Bardez Goa.  
From Girim Circle Signal 3 km.  
Green Park 3.5 km.  
Mapusa Market 4 Km.

**Contact Details : 9096162778 | Email : raikarvastu@gmail.com**