

AREA DETAILS FLOOR-WISE											
FLOOR REFERENCE	USE	TOTAL B.U.A (M²)	AREAS FREE FROM FAR (M²)							NET FLOOR AREA (M²)	FAR (%)
			BALCONY VERANDAH	STILT / BASEMENT FLOORS	STAIRCASE / LIFT	Mezzanine	Swimming Pool	OPEN TERRACE	7.5% OF FLOOR AREA Club house / Lobby / Society office		
<b>BLOCK A</b>											
GROUND FLOOR	COMMERCIAL/PARKING	731.51	---	288.88	102.30	---	---	---	---	340.33	3.89
UPPER GROUND FLOOR	RESIDENTIAL	487.17	61.23	---	100.47	95.84	---	---	---	11.67	2.49
FIRST FLOOR	RESIDENTIAL	767.72	122.16	---	93.49	---	---	---	---	25.61	4.92
SECOND FLOOR	RESIDENTIAL	671.36	122.19	---	93.49	---	---	---	---	25.61	4.92
THIRD FLOOR	RESIDENTIAL	734.25	122.16	---	93.49	---	---	---	---	25.61	4.92
FOURTH FLOOR	RESIDENTIAL	391.34	61.25	---	100.46	---	---	---	---	11.67	2.49
<b>BLOCK B</b>											
STILT FLOOR	PARKING	271.83	---	209.68	60.47	---	---	---	---	1.68	0.02
UPPER GROUND FLOOR	RESIDENTIAL	341.84	54.22	---	39.39	---	---	---	---	16.13	2.43
FIRST FLOOR	RESIDENTIAL	349.85	54.22	---	39.39	---	---	---	---	16.13	2.43
SECOND FLOOR	RESIDENTIAL	341.84	54.22	---	39.39	---	---	---	---	16.13	2.43
THIRD FLOOR	RESIDENTIAL	349.85	54.22	---	39.39	---	---	---	---	16.13	2.43
FOURTH FLOOR	RESIDENTIAL	341.84	54.22	---	39.39	---	---	---	---	16.13	2.43
<b>BLOCK C</b>											
STILT FLOOR	PARKING	271.83	---	209.68	60.47	---	---	---	---	1.68	0.02
UPPER GROUND FLOOR	RESIDENTIAL	341.84	54.22	---	39.39	---	---	---	---	16.13	2.43
FIRST FLOOR	RESIDENTIAL	349.85	54.22	---	39.39	---	---	---	---	16.13	2.43
SECOND FLOOR	RESIDENTIAL	341.84	54.22	---	39.39	---	---	---	---	16.13	2.43
THIRD FLOOR	RESIDENTIAL	349.85	54.22	---	39.39	---	---	---	---	16.13	2.43
FOURTH FLOOR	RESIDENTIAL	341.84	54.22	---	39.39	---	---	---	---	16.13	2.43
<b>BLOCK D</b>											
STILT FLOOR	PARKING	502.77	---	445.22	54.19	---	---	---	---	3.36	0.04
UPPER GROUND FLOOR	RESIDENTIAL	596.32	97.41	---	44.16	---	---	---	---	21.86	4.52
FIRST FLOOR	RESIDENTIAL	607.32	97.41	---	44.16	---	---	---	---	21.86	4.52
SECOND FLOOR	RESIDENTIAL	596.32	97.41	---	44.16	---	---	---	---	21.86	4.52
THIRD FLOOR	RESIDENTIAL	607.32	97.41	---	44.16	---	---	---	---	21.86	4.52
FOURTH FLOOR	RESIDENTIAL	596.32	97.41	---	44.16	---	---	---	---	21.86	4.52
<b>BLOCK E</b>											
STILT FLOOR	PARKING	139.51	---	116.17	21.66	---	---	---	---	1.68	0.02
UPPER GROUND FLOOR	RESIDENTIAL	188.83	33.26	---	15.79	---	---	---	---	8.08	1.38
FIRST FLOOR	RESIDENTIAL	177.61	33.26	---	15.79	---	---	---	---	8.08	1.38
SECOND FLOOR	RESIDENTIAL	188.83	33.26	---	15.79	---	---	---	---	8.08	1.38
THIRD FLOOR	RESIDENTIAL	177.61	33.26	---	15.79	---	---	---	---	8.08	1.38
<b>BLOCK F</b>											
STILT FLOOR	PARKING	477.88	---	415.10	59.42	---	---	---	---	3.36	0.04
UPPER GROUND FLOOR	RESIDENTIAL	543.43	88.89	---	49.57	---	---	---	---	18.31	4.21
FIRST FLOOR	RESIDENTIAL	566.28	88.89	---	49.57	---	---	---	---	18.31	4.21
SECOND FLOOR	RESIDENTIAL	543.43	88.89	---	49.57	---	---	---	---	18.31	4.21
THIRD FLOOR	RESIDENTIAL	566.28	88.89	---	49.57	---	---	---	---	18.31	4.21
FOURTH FLOOR	RESIDENTIAL	543.43	88.89	---	49.57	---	---	---	---	18.31	4.21
<b>CLUB HOUSE</b>											
GROUND FLOOR	RESIDENTIAL	59.55	---	---	---	---	---	---	---	59.55	---
FIRST FLOOR	RESIDENTIAL	76.78	---	---	---	---	---	---	---	76.78	---
<b>BLOCK A &amp; OPEN SPACE (BASEMENT)</b>											
BASEMENT FLOOR	PARKING	2358.93	---	2315.44	40.13	---	---	---	---	3.36	0.04
<b>SWIMMING POOL</b>											
GROUND FLOOR	RESIDENTIAL	58.03	---	---	---	---	---	---	---	58.03	---
<b>TOTAL</b>		<b>17950.23</b>	<b>2095.73</b>	<b>4000.17</b>	<b>1805.75</b>	<b>95.84</b>	<b>58.03</b>	<b>788.76</b>	<b>598.50</b>	<b>8509.45</b>	<b>97.38</b>

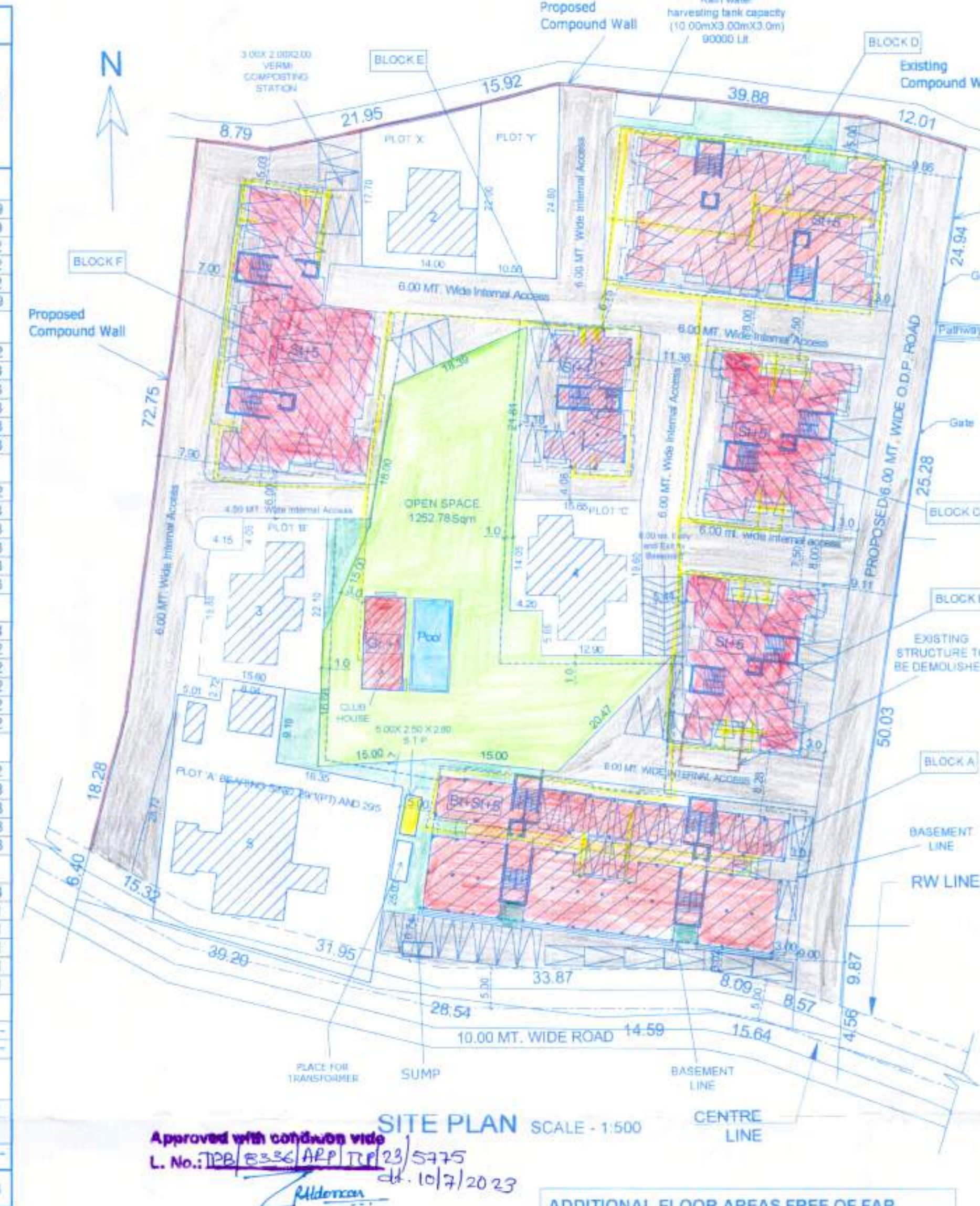

AREA STATEMENT		
BLOCK E	TOTAL AREA OF THE PLOT (S. no. 29 / 1-B)	10075.00 Sqm
STILT FLOOR	DEDUCT AREA OF PLOT A (S. no. 29 / 5)	600.00 Sqm
UPPER GROUND FLOOR	DEDUCT AREA OF PLOT X & Y (S. no. 29 / 2)	410.00 Sqm
FIRST FLOOR	Net Area of the Plot (S. no. 29/1-B)	9065.00 Sqm
SECOND FLOOR	ADD Area of Plot (S. no. 29/3)	125.00 Sqm
THIRD FLOOR	ADD Area of Plot (S. no. 29/4)	150.00 Sqm
FOURTH FLOOR	ADD Area of Plot (S. no. 29/5)	50.00 Sqm
BLOCK F	Area of Amalgamated Plot (S. no. 29/1-B + S. no. 29/3 + S. no. 29/4 + S. no. 29/5)	9390.00 Sqm
STILT FLOOR	Deduct Area Reserved for Plot B (Including Existing Structure S. no. 29/3)	300.00 Sqm
UPPER GROUND FLOOR	Deduct Area Reserved for Plot C (Including Existing Structure S. no. 29/4)	350.00 Sqm
FIRST FLOOR	NET AREA OF THE PLOT	8740.00 Sqm
SECOND FLOOR	AREA DEDUCTED IN ROAD WIDENING	461.20 Sqm
THIRD FLOOR	AREA FOR PROPOSED 6.00 ODP ROAD	660.72 Sqm
FOURTH FLOOR	NET EFFECTIVE PLOT AREA	7618.08 Sqm
CLUB HOUSE	PERMISSIBLE COVERED AREA 40 %	3047.23 Sqm
GROUND FLOOR	COVERED AREA	
FIRST FLOOR	BLOCK A	731.51 Sqm
BLOCK A & OPEN SPACE	BLOCK B	271.83 Sqm
BASEMENT FLOOR	BLOCK C	271.83 Sqm
SWIMMING POOL	BLOCK D	502.77 Sqm
TOTAL BUILT UP AREA	BLOCK E	139.51 Sqm
	BLOCK F	477.88 Sqm
	CLUB HOUSE	59.55 Sqm
FLOOR AREA	TOTAL COVERED AREA	2454.88 Sqm
BLOCK A	COVERED CONSUMED	32.22 %
BASEMENT FLOOR	BUILT UP AREA	
GROUND FLOOR	BLOCK A	
UPPER GROUND FLOOR	GROUND FLOOR	731.51 Sqm
FIRST FLOOR	UPPER GROUND FLOOR	487.17 Sqm
SECOND FLOOR	FIRST FLOOR	767.72 Sqm
THIRD FLOOR	SECOND FLOOR	671.36 Sqm
FOURTH FLOOR	THIRD FLOOR	734.25 Sqm
BLOCK B	FOURTH FLOOR	391.34 Sqm
STILT FLOOR	BLOCK B	
UPPER GROUND FLOOR	STILT FLOOR	271.83 Sqm
FIRST FLOOR	UPPER GROUND FLOOR	341.84 Sqm
SECOND FLOOR	FIRST FLOOR	349.85 Sqm
THIRD FLOOR	SECOND FLOOR	341.84 Sqm
FOURTH FLOOR	THIRD FLOOR	349.85 Sqm
BLOCK C	FOURTH FLOOR	341.84 Sqm
STILT FLOOR	BLOCK C	
UPPER GROUND FLOOR	STILT FLOOR	271.83 Sqm
FIRST FLOOR	UPPER GROUND FLOOR	341.84 Sqm
SECOND FLOOR	FIRST FLOOR	349.85 Sqm
THIRD FLOOR	SECOND FLOOR	341.84 Sqm
FOURTH FLOOR	THIRD FLOOR	349.85 Sqm
BLOCK D	FOURTH FLOOR	341.84 Sqm
STILT FLOOR	BLOCK D	
UPPER GROUND FLOOR	STILT FLOOR	502.77 Sqm
FIRST FLOOR	UPPER GROUND FLOOR	596.32 Sqm
SECOND FLOOR	FIRST FLOOR	607.32 Sqm
THIRD FLOOR	SECOND FLOOR	596.32 Sqm
FOURTH FLOOR	THIRD FLOOR	607.32 Sqm
BLOCK E	FOURTH FLOOR	596.32 Sqm
STILT FLOOR	BLOCK E	
UPPER GROUND FLOOR	STILT FLOOR	139.51 Sqm
FIRST FLOOR	UPPER GROUND FLOOR	188.83 Sqm
SECOND FLOOR	FIRST FLOOR	177.61 Sqm
THIRD FLOOR	SECOND FLOOR	188.83 Sqm
FOURTH FLOOR	THIRD FLOOR	177.61 Sqm
BLOCK F	FOURTH FLOOR	177.61 Sqm
STILT FLOOR	BLOCK F	
UPPER GROUND FLOOR	STILT FLOOR	477.88 Sqm
FIRST FLOOR	UPPER GROUND FLOOR	543.43 Sqm
SECOND FLOOR	FIRST FLOOR	566.28 Sqm
THIRD FLOOR	SECOND FLOOR	543.43 Sqm
FOURTH FLOOR	THIRD FLOOR	566.28 Sqm
CLUB HOUSE	FOURTH FLOOR	543.43 Sqm
GROUND FLOOR	CLUB HOUSE	59.55 Sqm
FIRST FLOOR	GROUND FLOOR	76.78 Sqm
BASEMENT FLOOR	FIRST FLOOR	76.78 Sqm
SWIMMING POOL	BASEMENT FLOOR	58.03 Sqm
GROUND FLOOR	SWIMMING POOL	58.03 Sqm
<b>TOTAL</b>	<b>TOTAL FLOOR AREA</b>	<b>8509.45 Sqm</b>

NUMBER OF APARTMENTS ----- 195  
NUMBER OF SHOPS ----- 12

**PERMISSIBLE SHOP AREA**  
@ 50% of Covered Area = 731.51 X 50% = 365.75 sqm  
AREA UTILISED  
Shop Area consumed = 336.97 sqm (46.06%)

	Block A	Block B	Block C	Block D	Block E	Block F	TOTAL
2 BHK	---	---	---	---	08	---	08
1 BHK + laundry	32	---	---	---	---	---	32
1 BHK	---	20	20	40	---	35	115
STUDIO	---	10	10	10	---	10	40
SHOPS	12	---	---	---	---	---	12
<b>TOTAL</b>	<b>44</b>	<b>30</b>	<b>30</b>	<b>50</b>	<b>08</b>	<b>45</b>	<b>207</b>

**ADDITIONAL FLOOR AREAS FREE OF FAR**  
Add @ 7.5% of FL Area = 8509.45 X 7.5% = 638.20 sqm  
AREA UTILISED Lobby = 598.50 sqm  
TOTAL = 598.50 sqm (7.03%)

Built Up Area - Stilt area - Basement area  
17950.23 - 1684.73 - 2315.44 = 13950.06m²

Built Up Area For Infrastructure Tax  
Shop area 336.97M² + Residential 13613.09M² = 13950.06M²

**CALCULATION FOR SEWAGE TREATMENT PLANT AND WASTE MANAGEMENT**

S No.	BLDG.	No. OF PERSONS
1)	BLOCK - A	32x3 = 96 12x1 = 12 108 Nos.
2)	BLOCK - B	10x2 = 20 20x4 = 80 100 Nos.
3)	BLOCK - C	10x2 = 20 20x4 = 80 100 Nos.
4)	BLOCK - D	10x2 = 20 40x2 = 80 100 Nos.
5)	BLOCK - E	08x4 = 32 Nos.
6)	BLOCK - F	10x2 = 20 35x2 = 70 90 Nos.
7)	CLUB HOUSE	STAFF = 04 Nos.
	<b>TOTAL</b>	<b>534 Nos.</b>

	TOTAL REQUIREMENT	PROVISION PROPOSED
SEWAGE TREATMENT PLANT	534 X 135 Litres/Person = 72090 Litres = 73 M³ volume	5.0M X 4.0M X 3.8M D 76.00 m³ VOLUME
SOLID WASTE VERMI COMPOSTING UNIT	534 X 300 Gms/Person = 160200 Gms = 160.20 Kgs./day = 0.0801 m³ volume (@ 2 Tonnesthr) Total volume = 0.0801 X 310 days = 2.40 m³	3.0M X 2.0M X 2.0M D 12.00 m³ volume

**PARKING DETAILS FOR PROPOSED BUILDING**

BUILDING	FLOOR AREA	USE	UNIT	PARKING REQD.	PARKING PROV.
BUILDING (A)	UP TO 75 SQ.M.	RESIDENTIAL	1BHK+Laundry 32 Nos.	1 X 32 = 32 NOS.	32 NOS.
BUILDING (B)	UP TO 75 SQ.M.	RESIDENTIAL	Studio 10 Nos. 1BHK 20 Nos.	1 X 10 + 1 X 20 = 30 NOS.	30 NOS.
BUILDING (C)	UP TO 75 SQ.M.	RESIDENTIAL	Studio 10 Nos. 1BHK 20 Nos.	1 X 10 + 1 X 20 = 30 NOS.	30 NOS.
BUILDING (D)	UP TO 75 SQ.M.	RESIDENTIAL	Studio 10 Nos. 1BHK 42 Nos.	1 X 10 + 1 X 40 = 50 NOS.	50 NOS.
BUILDING (E)	UP TO 75 SQ.M.	RESIDENTIAL	2BHK 08 Nos.	1 X 08 = 08 NOS.	08 NOS.
BUILDING (F)	UP TO 75 SQ.M.	RESIDENTIAL	Studio 10 Nos. 1BHK 35 Nos.	1 X 10 + 1 X 35 = 45 NOS.	45 NOS.
<b>TOTAL</b>				<b>201.73 NOS.</b>	<b>202 NOS.</b>

**RAIN WATER HARVESTING TANK CAP.**

BLOCK	Requirement
BLOCK A	2 PERSONS/1 BED UNIT x (32) 1BHK = 64 x 200 Ltr./per = 12800 Litres 2 PERSONS/1 SHOP x (12) SHOP = 24 x 200 Ltr./per = 4800 Litres REQUIRED = 17600 Litres
BLOCK B	2 PERSONS/1 BED UNIT x (20) 2BHK = 40 x 200 Ltr./per = 8000 Litres 2 PERSONS/STUDIO x (10) STUDIO = 20 x 200 Ltr./per = 4000 Litres REQUIRED = 12000 Litres
BLOCK C	2 PERSONS/1 BED UNIT x (20) 2BHK = 40 x 200 Ltr./per = 8000 Litres 2 PERSONS/STUDIO x (10) STUDIO = 20 x 200 Ltr./per = 4000 Litres REQUIRED = 12000 Litres
BLOCK D	4 PERSONS/2 BED UNIT x (40) 2BHK = 80 x 200 Ltr./per = 16000 Litres 2 PERSONS/STUDIO x (10) STUDIO = 20 x 200 Ltr./per = 4000 Litres = 20000 Litres
BLOCK E	4 PERSONS/2 BED UNIT x (08) 2BHK = 32 x 200 Ltr./per = 6400 Litres = 6400 Litres
BLOCK F	4 PERSONS/2 BED UNIT x (35) 2BHK = 70 x 200 Ltr./per = 14000 Litres 2 PERSONS/STUDIO x (10) STUDIO = 20 x 200 Ltr./per = 4000 Litres = 18000 Litres
<b>TOTAL</b>	<b>REQUIRED = 86000 Litres PROVIDED = 90000 Litres</b>

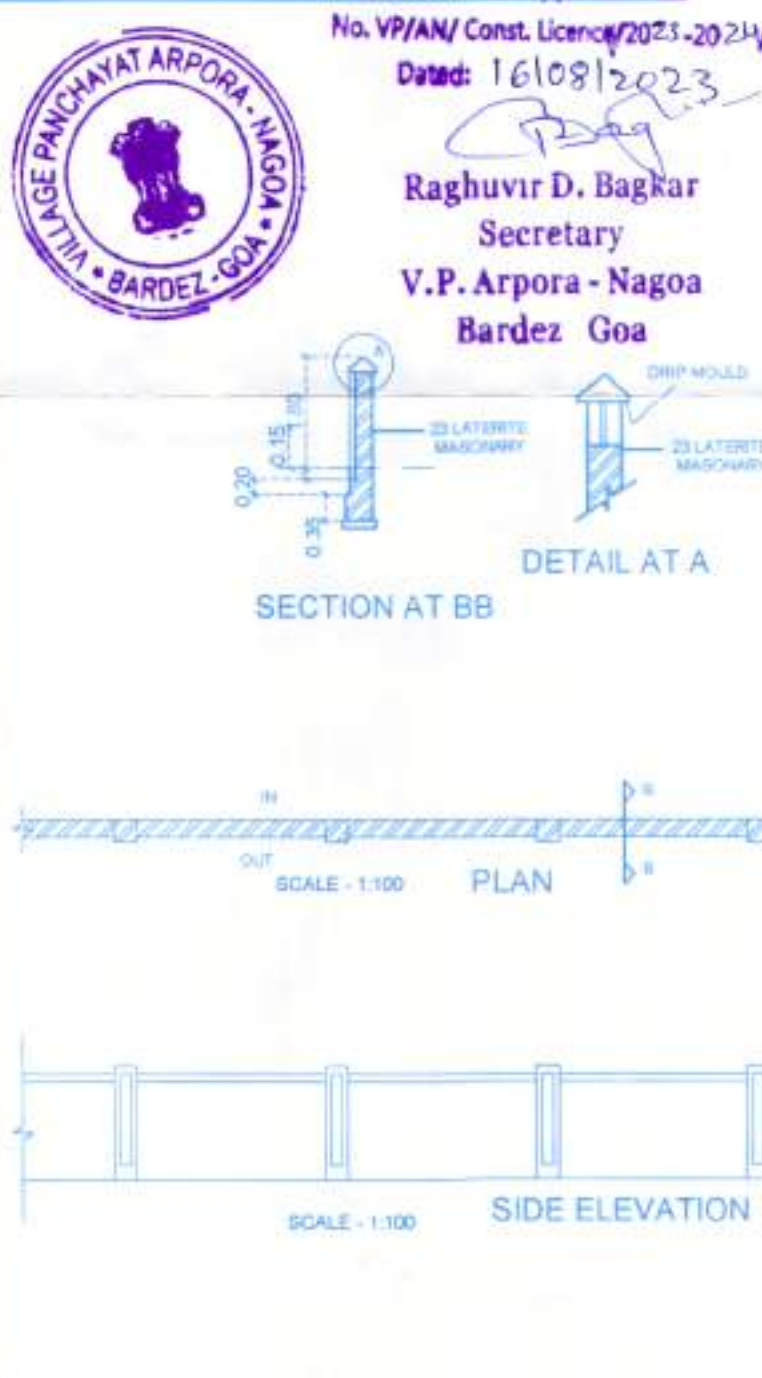

Permission Approved Under  
No. VP/AN/Const. Licen/2021-2024/112  
Date: 16/08/2023  
Raghuvir D. Bagkar  
Secretary  
V.P. Arpora - Nagoa  
Bardez Goa

OWNER: S. SIDDHANT D. NAIK  
201 - A, BATHING PLAZA  
PANJIM - GOA 403 001  
Reg. No: AR/027/2010

ARCHITECT: M/S ULYSIS  
# 201 - A, SECOND FLOOR, MATHIAS PLAZA,  
PANJIM - GOA 403001  
PH. - 91 832 6455050

SCALE 1:100, 1:200, 1:500  
DRG. NO. 01 / 06