

Approved with Condition
 No. 1144/F. Const. Licence/20 20/2021/1900
 Dated: 09/10/2020
 SARFANCH SECRETARY
 V.P. MULGAO, BICHOLIM



1404

AREA DIAGRAM OF OPEN SPACE

Approved with Condition
 No. 1144/F. Const. Licence/20 20/2021/1900
 Dated: 09/10/2020
 Deputy Town Planner
 Town & Country Planning Dept
 Bicholim, Goa

OPEN SPACE	AREA	WASTAGE
OPEN SPACE 1	695	
OPEN SPACE 2	916	62
OPEN SPACE 3	3569	82
OPEN SPACE 4	757	31
OPEN SPACE 5	544	50
OPEN SPACE 6	1090	59
OPEN SPACE 7	590	
EFFECTIVE TOTAL	8161	
TOTAL	8445	

AREA STATEMENT			
PLOT NO	AREA	PLOT NO	AREA
1	370.00	52	269.23
2	300.00	53	269.23
3	300.00	54	268.57
4	300.00	55	270.68
5	338.69	56	271.34
6	339.62	57	271.34
7	341.92	58	271.34
8	344.00	59	269.41
9	344.63	60	270.00
10	343.00	61	271.87
11	345.17	62	271.87
12	347.16	63	271.87
13	346.00	64	270.00
14	345.37	65	270.00
15	358.25	66	271.87
16	341.94	67	271.87
17	346.12	68	271.87
18	343.94	69	270.00
19	345.60	70	455.15
20	345.60	71	250.32
21	346.36	72	259.75
22	347.13	73	318.46
23	347.90	74	292.67
24	348.91	75	307.77
25	305.88	76	324.53
26	269.83	77	379.22
27	267.02	78	410.00
28	352.49	79	308.00
29	351.37	80	331.00
30	350.01	81	314.00
31	348.65	82	391.92
32	347.29	83	306.00
33	345.96	84	270.00
34	345.00	85	270.00
35	347.00	86	270.00
36	342.22	87	270.00
37	334.41	88	270.00
38	305.60	89	270.00
39	269.41	90	285.57
40	271.34	91	310.00
41	290.78	92	310.00
42	286.11	93	300.00
43	271.34	94	300.00
44	271.34	95	300.00
45	269.41	96	319.20
46	320.74	97	291.50
47	322.68	98	392.64
48	302.94	99	456.00
49	355.06	100	276.15
50	267.30	101	289.38
51	269.23	102	280.30
SUB TOTAL	16557.72	103	304.00
SUB-TOTAL	16555.89		
TOTAL	32113.61		

AREA STATEMENT - II	
1 TOTAL PLOT AREA	95000
2 PLOT ACQUIRED BY HOUSING BOARD	28220
3 AREA ACQUIRED FOR SCHOOL	4000
4 AREA OF PLOT A (DUE TO NATURAL SUB.DIV.)	3278
5 AREA UNDER ROAD AND ROAD WIDENING ON NORTH/NORTH EAST SIDE	2324
6 AREA UNDER ROAD WIDENING ON WEST SIDE	2454
7 OPEN SPACES FORMED DUE TO PLOT ACQUIRED FOR SCHOOL	632
8 EFFECTIVE PLOT AREA (1-2-3-4-5-6-7)	54092
9 OPEN SPACE REQUIRED (15% OF 8)	8113.80
10 OPEN SPACE PROVIDED	8161
11 UTILITY SPACE REQUIRED (5%)	2704.6
12 UTILITY SPACE PROVIDED	2709
13 AREA UNDER INTERNAL ROADS	11108.39
14 AREA UNDER PLOTS	32113.61

plot acquired by housing board
 AREA=28220 SQM

ROAD'S	AREA SERVED
6 MTR WIDE ROAD (1)	455.15
6 MTR WIDE ROAD (2)	1547
8 MTR WIDE ROAD (3)	2000
8 MTR WIDE ROAD (4)	1305
8 MTR WIDE ROAD (5)	2710
10 MTR WIDE ROAD (6)	2644
8 MTR WIDE ROAD (7)	1638
8 MTR WIDE ROAD (8)	1777
10 MTR WIDE ROAD (9)	2971
10 MTR WIDE ROAD (10)	2354
8 MTR WIDE ROAD (11)	2541
8 MTR WIDE ROAD (12)	1271.04
8 MTR WIDE ROAD (13)	7213.94
8 MTR WIDE ROAD (14)	1382.36
TOTAL	31809.49

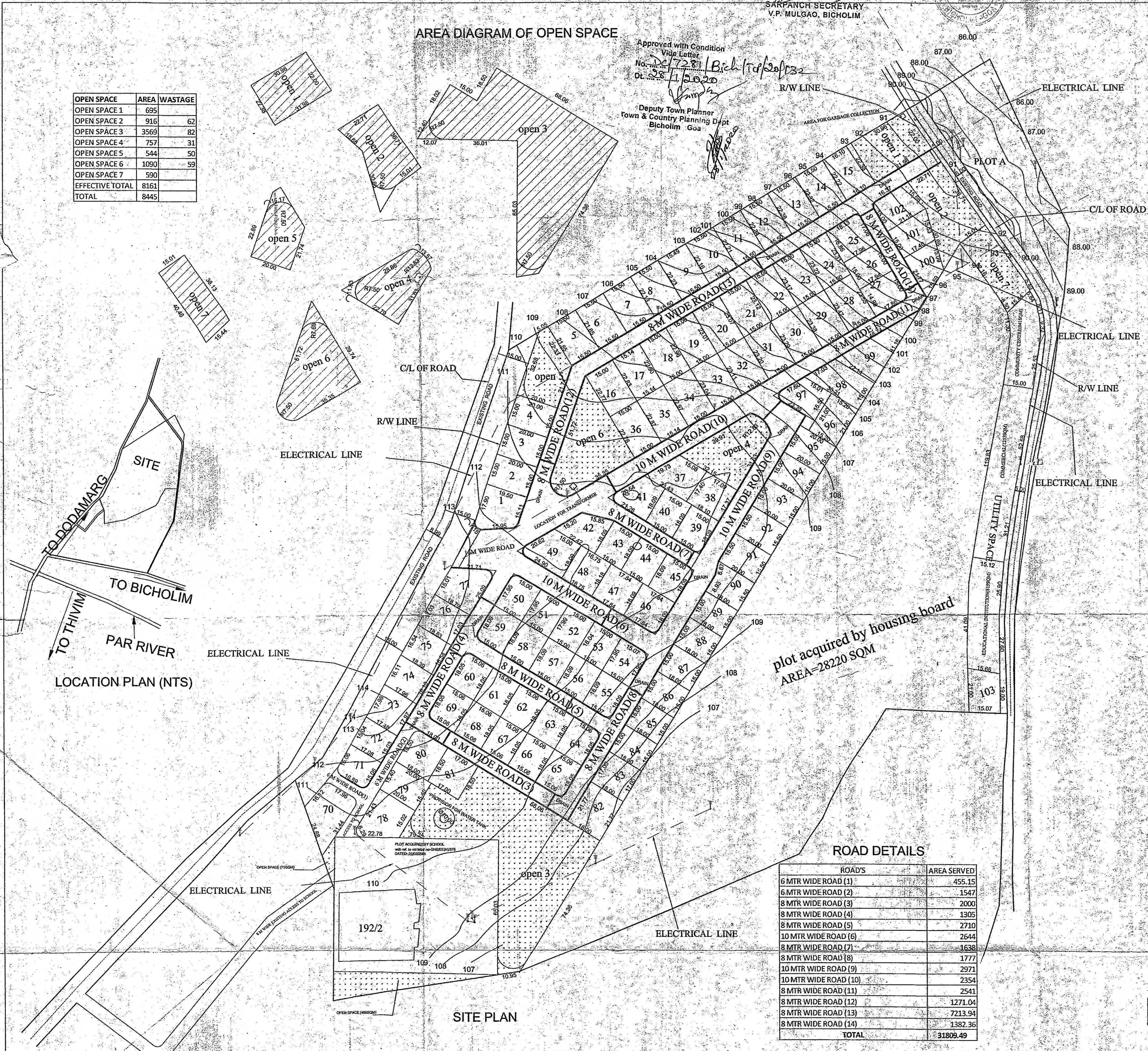
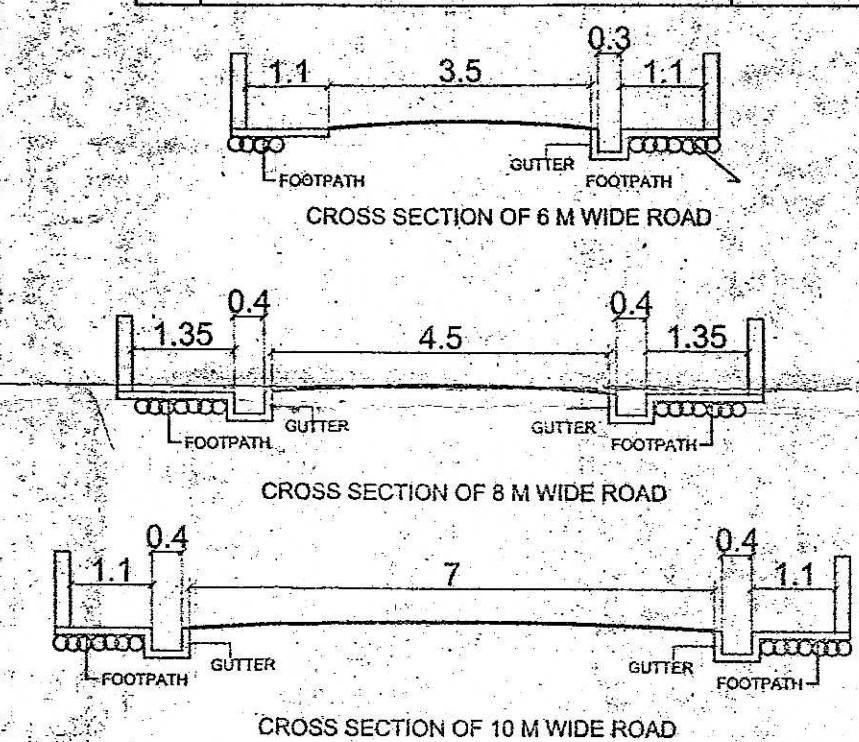

THIS DRAWING IS THE PROPERTY OF M/S. D. PRABHU AND THEIR CONSULTANTS AND NOT TO BE USED OR COPIED WITHOUT THEIR PERMISSION.

NOTES:
 ALL DIMENSIONS SHALL BE CHECKED & CORRELATED WITH THE STRUCTURAL DRAWINGS AND ANY AMBIGUITY SHALL BE IMMEDIATELY BROUGHT TO THE NOTICE OF THE ARCHITECT BEFORE COMMENCEMENT OF THE WORK.
 ALL DIMENSIONS ARE IN MM UNLESS OTHERWISE STATED.
 ALL ROOM DIMENSIONS ARE IN CM UNLESS OTHERWISE STATED.

SR	NO	ZONE	NO	DATE	ZONE
5			6		
3			4		
1			2		

TOWN PLANNER SIGN
 SNEHALATA S. PEDNEKAR
 Town Planner
 Reg. No. TP/001/2010

APPLICANT SIGN
 LLP
 Idm. No. AAB-3970

ARCHITECT'S SIGN & SEAL
 Devendra D. Prabhu
 ARCHITECT
 COA Reg. No. CA/2001/28558
 TCP Reg. No. AR/016/2019

LOCATION: MULGAO
 STATUS: SUBMISSION
 FILE NAME: 3/sid/pbhau/nalk/assnora/plot 010719.dwg
 NORTH: [Symbol]
 DRAWN: D.P.
 CHECKED: D.P.
 DATE: 15/05/2018
 SCALE: 1:1000 ON A1
 SHEET NUMBER: 01

TITLE: SUB DIVISION
 ARCHITECT: devendra d prabhu (D.Arch)
 architect, interior designer
 29-first floor, Maytra Morod, Mapusa-Goa
 ph:9422434007
 TOWN PLANNER: SNEHALATA S. PEDNEKAR (B.Arch, M.Tech, LLB) Masters
 Regional Planning-C.E.P.T.
 F-13, ANGARKI, OPP. PONDIA FIRE STATION
 PONDIA GOA, 403002

PROJECT: PROPOSED SUB DIVISION OF PLOTS LAND BEARING SURVEY NO: 192/1(PART) SITUATED AT MULGAO VILLAGE OF BICHOLIM TALUKA FOR M/S. OMNIMIND SYNERGIES LLP.