



GOVERNMENT OF GOA
Directorate of Settlement and Land Records
Office of Inspector of Survey and Land Records
MAPUSA - GOA

Inward No: 9865



Plan Showing plots situated at
Village : REVORA
Taluka : BARDEZ
Survey No./Subdivision No. : 25/ 3
Scale : 1 :1000

Rajesh R. Pai
(Rajesh R. Pai Kuchelkar)
Inspector of Survey &
Land Records.

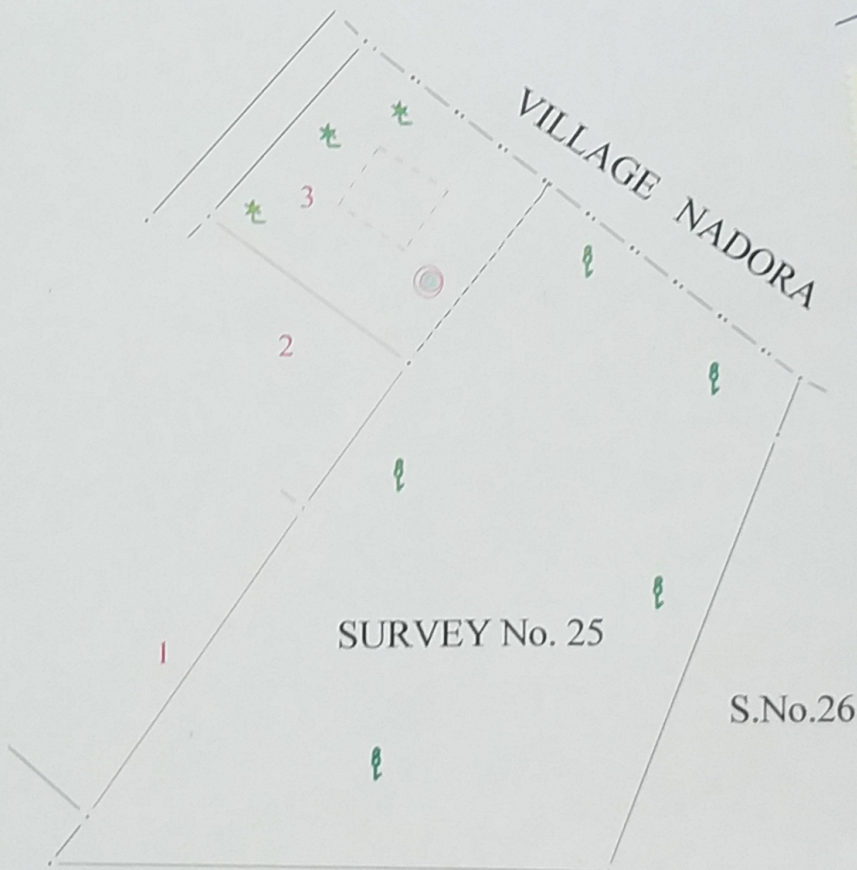
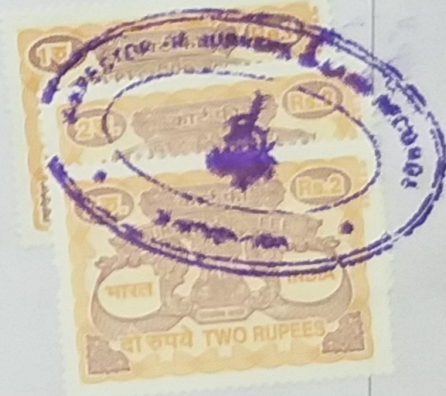

Pratap

Generated By : Pratap Moulekar (D'Man Gr. II)
On : 12-10-2018

Pratap Moulekar
Compared By: