



Approved with condition vide  
 L. No. 716/5092/SID/TQM/20-53  
 Hazarale 20/1/20  
 Dy. Town Planner  
 Town & Country Planning Dept.  
 Govt. of Goa, Mapusa

AREA STATEMENT :

01	AREA OF THE PLOT	2750.00 SQ.M.
02	AREA FOR ROAD WIDENING	0.00 SQ.M.
03	NET EFFECTIVE PLOT AREA	2750.00 SQ.M.
04	PERMISSIBLE COVERAGE (40%)	1100.00 SQ.M.
05	PROPOSED COVERAGE (27.52%)	756.83 SQ.M.
06	PERMISSIBLE FAR (60%)	1650.00 SQ.M.
07	PROPOSED FAR (49.93%)	1373.10 SQ.M.
08	GROUND FLOOR AREA	749.62 SQ.M.
09	FIRST FLOOR AREA	623.48 SQ.M.
10	TOTAL FAR CONSUMED (8+9)	1373.10 SQ.M.

SITE PLAN  
 SCALE 1:500

AREA STATEMENT FOR TYPICAL VILLA

FLOORS	TOTAL B.U.A (sq.mts)	AREA STATEMENT AREA FREE OF F.A.R			NET F.A.R (sq.mts)	PROP F.A.R (sq.mts)
		STAIRCASE	TERRACE	TOTAL		
GROUND FLOOR	130.83	-	-	-	130.83	
FIRST FLOOR	151.15	-	30.08	30.08	121.07	
TOTAL X 4	281.98	-	30.08	30.08	251.90	
TOTAL	1127.92	-	120.32	120.32	1007.60	
GROUND FLOOR	233.51	7.21	-	7.21	226.30	
FIRST FLOOR	146.41	7.21	-	7.21	139.20	
TOTAL	379.92	14.42	-	14.42	365.50	
GRAND TOTAL	1507.84	14.42	120.32	134.74	1373.10	32.70%

PROPOSED INFRASTRUCTURE TAX AREA = 1387.52 M<sup>2</sup>  
 SWIMMING POOL AREA = 86.40 M<sup>2</sup>  
 TOTAL PROPOSED INFRASTRUCTURE TAX AREA = 1387.52 + 86.40 = 1473.92 M<sup>2</sup>

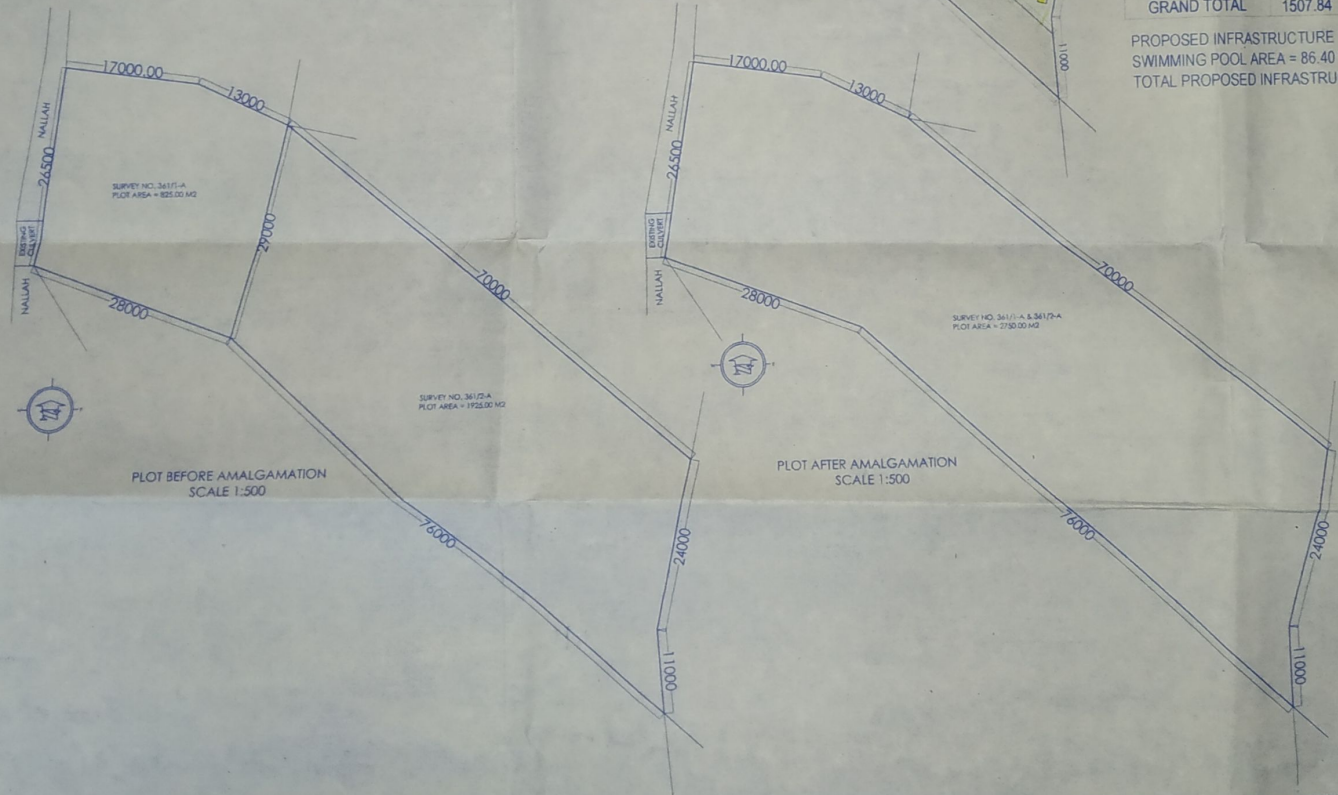

PLOT BEFORE AMALGAMATION  
 SCALE 1:500

PLOT AFTER AMALGAMATION  
 SCALE 1:500

PROJECT TITLE:	
PROPOSED AMALGAMATION OF PLOTS BEARING SY. NO. 361/1-A, 361/2-A & 362/6 AND PROPOSED CONSTRUCTION OF RESIDENTIAL VILLAS ON PLOT BEARING SURVEY NO. /SUB/DIV. NO. 361/1-A, 361/2-A & 362/6. SITUATED AT SIOLIUM VILLAGE, BARDEZ TALUKA GOA.	
FOR- REALCON RESIDENCY LLP	
SUBMISSION DRAWING	
OWNER SIGN	CONSULTANT SIGN
PARISH GAITONDE B.E. CIVIL ENGINEER RCC CONSULTANT, GOVT. VALUER CHARITABLE ENGINEER BT-15, Sampal Trade Centre, Nr. Millers Road, Puna, PUNE, GOA. Ph: 9423927 Mob: 9822102782	