

APPLIED FOR RERA REGISTRATION FOR THE PROJECT "IMPERIAL GOA PHASE 1" SEPARATELY.

PLOT AREA
24,019.00 SQ.MTRS

IMPERIAL GOA PHASE 2
APPLIED FOR RERA REGISTRATION

PHASE - 1

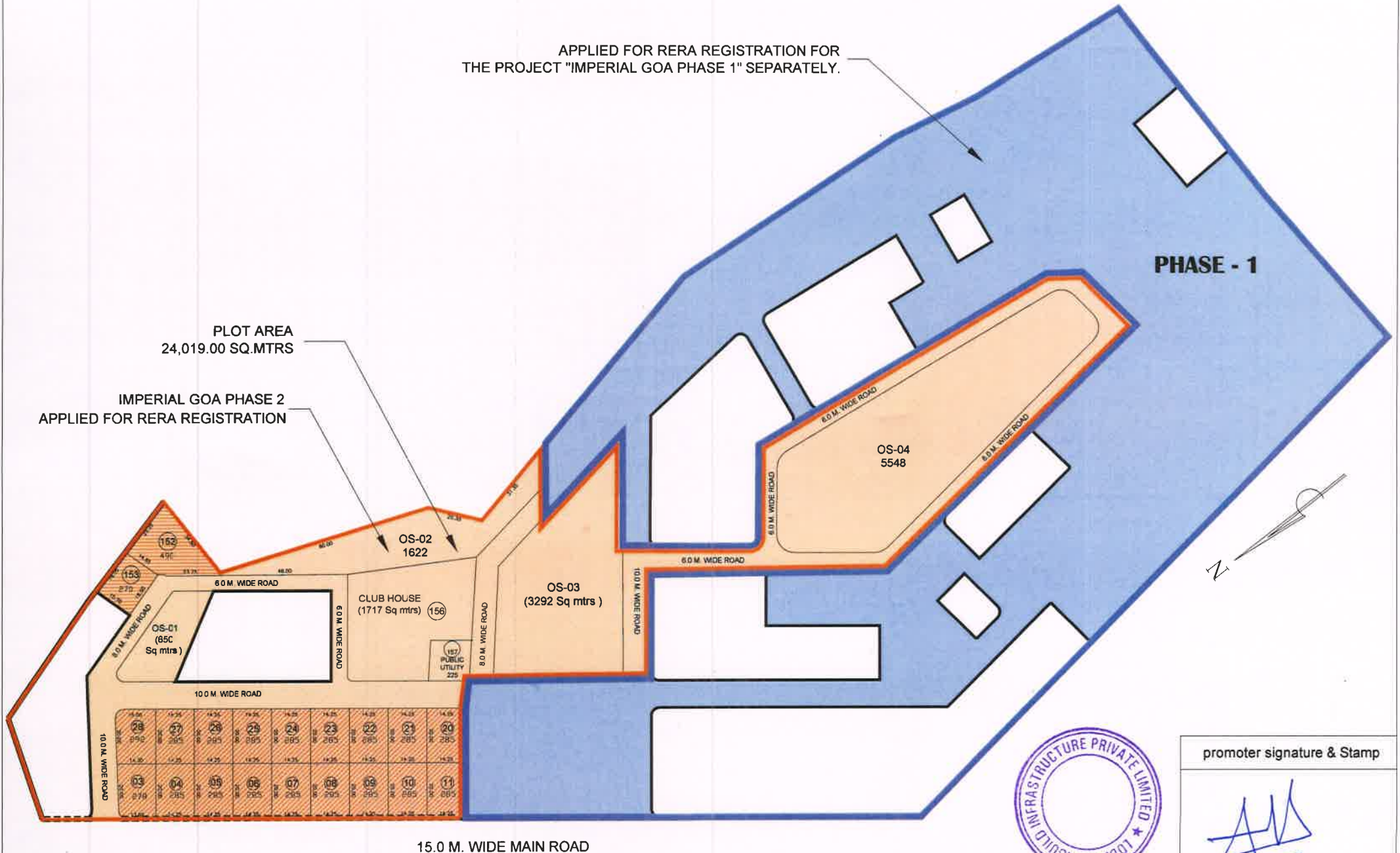

promoter signature & Stamp

SUB-DIVISION OF PLOTTING A PROJECT "IMPERIAL GOA PHASE 2" BEING DEVELOPED BY LODHA LANDBUILD INFRASTRUCTURE PRIVATE LIMITED ON S. NO. 20/1A, OF BAINGUINIM VILLAGE TALUKA TISWADI, DISTRICT NORTH GOA, GOA, PIN CODE-----