

LOCATION MAP

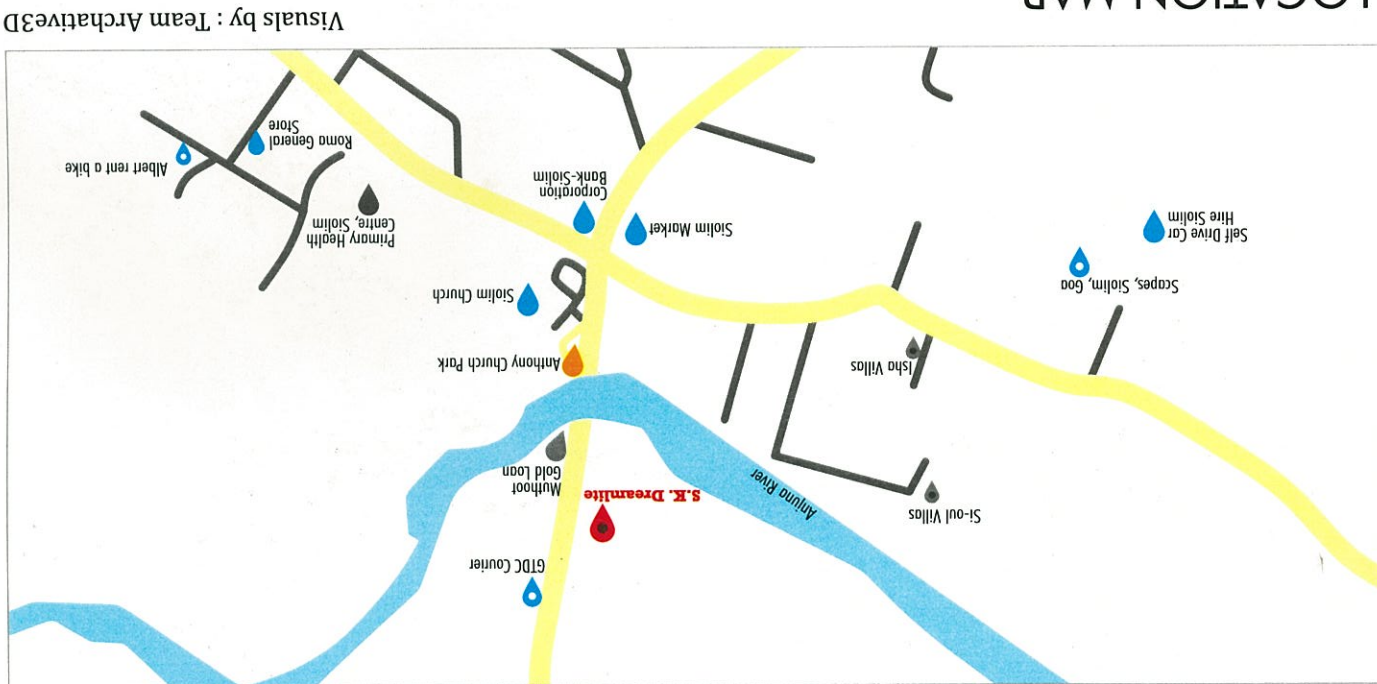

Visuals by : Team Archatrive3D

Kiran Pednekar - 8605450252
for bookings Contact -

www.saikiranrealestates.com
info@saikiranrealestates.com

Bardez Goa
#6 Stay Well Apartment,
Sonarwada, Verla, Canca,

Office Address

Constructions



Proprietor - Dattaram Pednekar

RCC Consultant - Parash Gaitonde

Architect - Prashant Gaonkar

Siolim, Bardez, Goa.

Opposite St. Anthony Church

Baman Waddo,

Site Address

Siolim - Goa

S.K. Dreamlite

Project by

S.K. Constructions

S.K. Dreamlite

Siolim - Goa



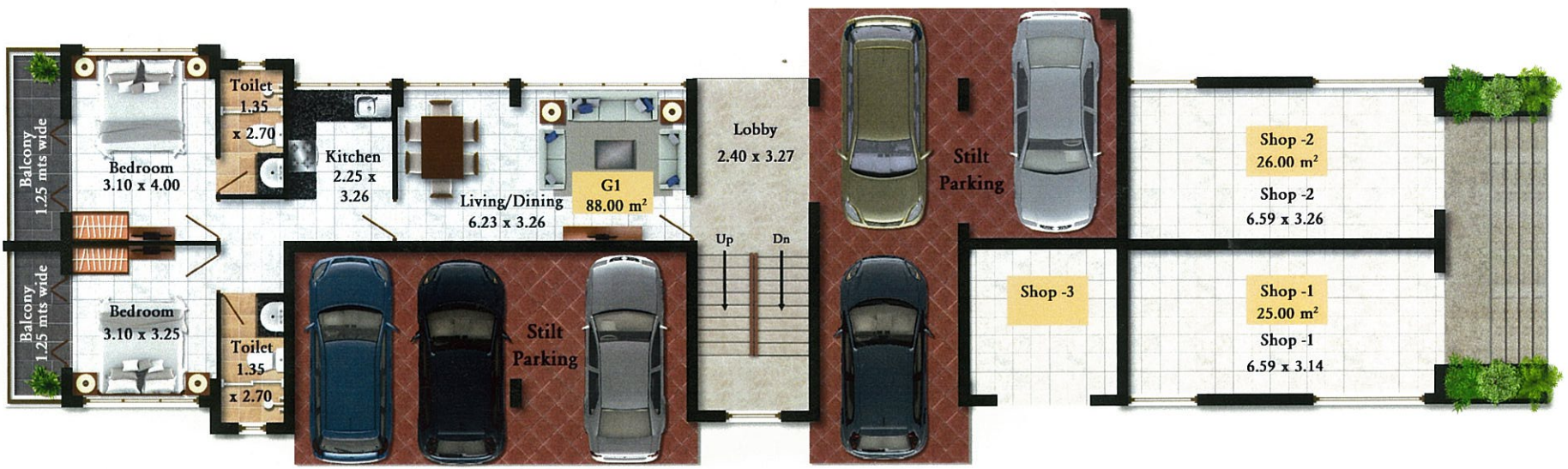

Ground Floor

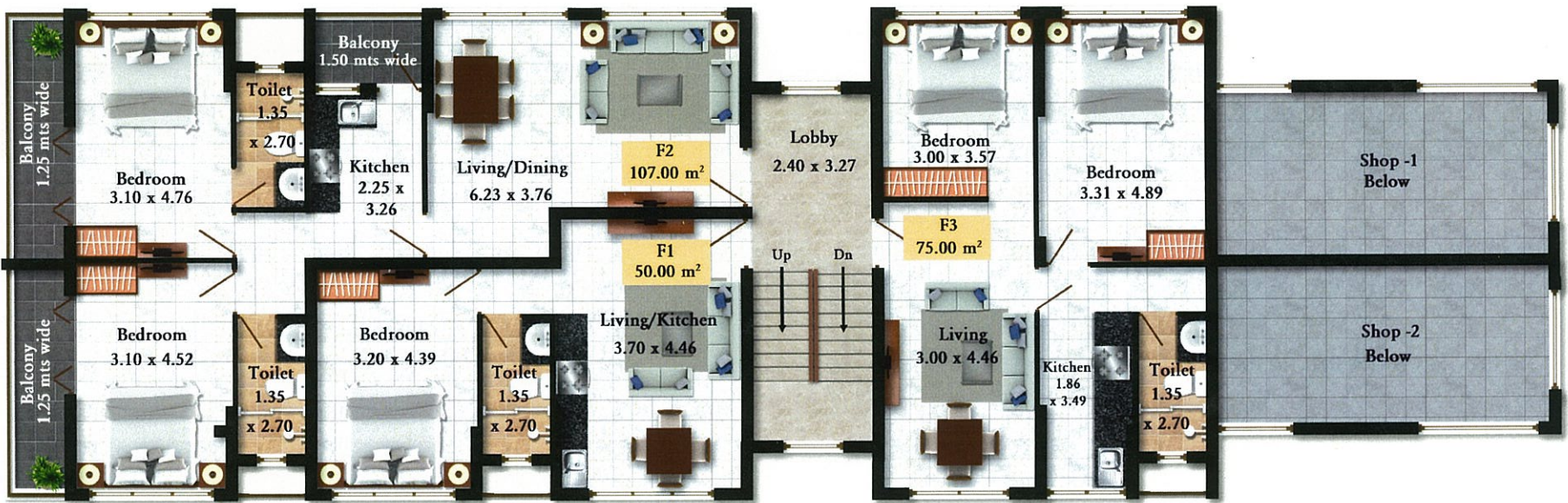

First Floor

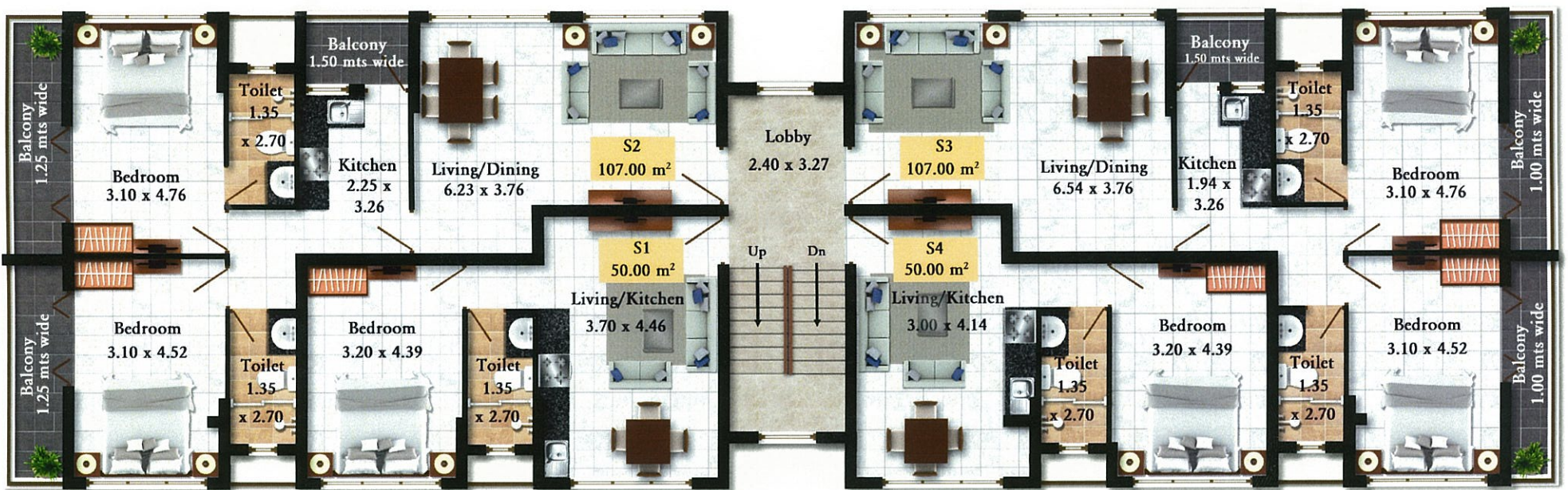

Second Floor

Amenities

Stilt Parking | 24 x 7 Security

Specifications

- | Anodized Aluminum Sliding Windows | Branded Modular Switches | A. C Points Provision |
- | Concealed wiring with circuit breaker | Vitrified Flooring Tiles |
- | Wall Care Putty Smooth | Finished walls with OBD paint |