

Completed Building - G
Completion certificate no. NGPDA/M/1053/253 / 17 Dated 28 - 04 - 2017
Plot area belongs to Building - G (School) - 991.00M²

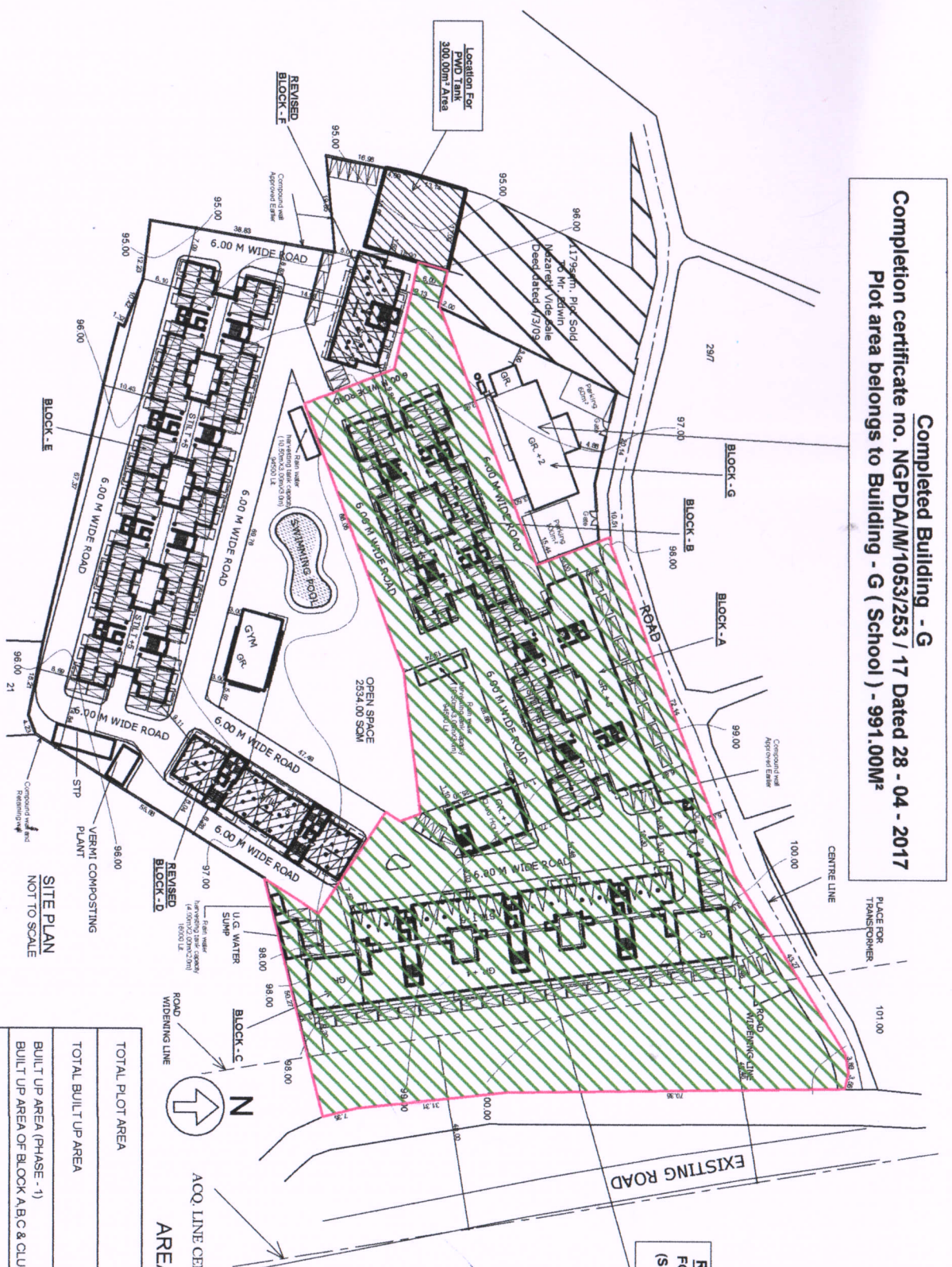

RAJ ENCLAVE (PHASE - 1)
FOR RERA REGISTRATION PURPOSE
(SHARE IN LAND OF BLOCK A, B & C)
AREA = 9864.86 M²

AREA STATEMENT	
TOTAL PLOT AREA	17761.00 Sq.mt
TOTAL BUILT UP AREA	29464.27 Sq.mt
BUILT UP AREA (PHASE - 1)	16366.13 Sq.mt
BUILT UP AREA OF BLOCK A, B, C & CLUBHOUSE	
SHARE IN LAND OF RAJ ENCLAVE (PHASE - 1)	17761.00 X 16366.13 / 29464.27 = 9864.86 Sq.mt

NOTE : THIS PLAN IS ONLY FOR THE PURPOSE OF REGISTRATION OF RAJ ENCLAVE UNDER RERA.

PLAN SHOWING PROPORINATE OF LAND AREA EXCLUSIVELY FOR RAJ ENCLAVE OF PHASE - 1 (BLOCK - A, BLOCK - B & BLOCK C) OF RESIDENTIAL BUILDINGS ON THE PLOT BEARING PT. S. 8 CHALTA NO. 1 SITUATED AT MAPUSA CITY OF BARDEZ TALUKA.

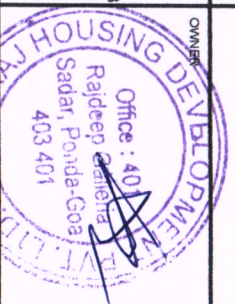

OWNER

ARCHITECT
AR. SIDDHARTH D. NAIK
201 - A, MATTHIAS PLAZA
PANAJI - GOA 403 001
REG. NO : AR/0027/2010
COA NO :CA/97 / 21749

M/S ULYSIS

201 - A, SECOND FLOOR, MATTHIAS PLAZA, PANAJIM - GOA 403001
 PH. - 91 832 2421950