

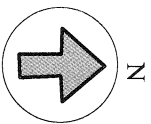

GOVERNMENT OF GOA  
Directorate of Settlement and Land Records  
Office of Inspector of Survey and Land Records  
MARGAO-GOA



Plan Showing plots situated at  
Village : MARGAO  
Taluka : SALCETE  
P.T.sheet No.239/ Chalka No.14  
Scale : 1:500

Inspector Of Survey & Land Records  
Margao-Goa

  
( A.V. VAIGANKAR )

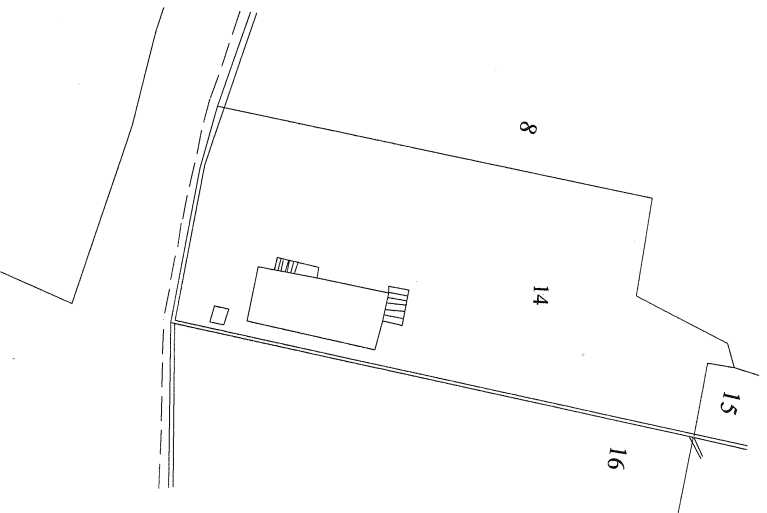
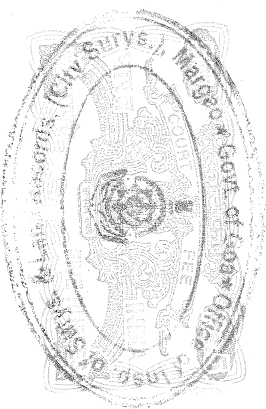

Generated By : DILIP NAIK  
On : 10-08-2015



Compared By: ( D.C. Dabholkar )

  
10/08/15



Government of Goa  
Form 'D'  
See Rule 7

Goa Land Revenue (City Survey) Rules, 1969  
Property Card of Margao city

Page No. 1  
Date 18/04/2016

| Pt Sheet No | Chalta No | Area<br>Sq.Mts | Tenure | Particulars of assessment<br>or rent paid to Government<br>and when due for revision | Category |
|-------------|-----------|----------------|--------|--|----------|
| 239         | 14        | 441.00         | --     |  | Private  |

Easements

----- Nil -----

Holders in the origin of the title  
(So far as traced) -

M/S AKAR CREATIONS PVT. LTD.

Lessees -

----- Nil -----

Other Encumbrances -

----- Nil -----

Other Remarks -

----- Nil -----

| Details - | Mutation<br>Date | Mutation<br>Number | Mutation<br>Type | Name<br>Remarks | New Holder (H),<br>Lessee (L),<br>Encumbrance(E)<br>Other Remarks(R)<br>Easements(A) | Area<br>(Sq.Mts) |
|-----------|------------------|--------------------|------------------|-----------------|--|------------------|
|           |                  |                    |                  | ----- Nil ----- |  |                  |

[ Bracketed entries indicate Deletion  
For any further inquires, please contact the ISLR of the concerned city.

\*\*\* END OF REPORT \*\*\*

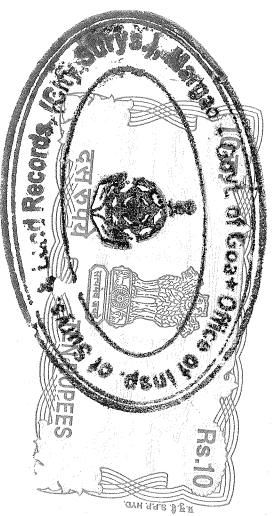

*Handwritten signature*  
Inspector of Surveys and  
Records  
(City Survey)  
Margao - Goa

**CERTIFIED COPY**  
I certify that the Inspector of Survey and Land  
Records, City Survey, Margao  
has applied for and obtained  
from the Registrar, Margao  
a copy of the original  
of the title deed  
of the land  
situated at  
No. 14  
Chalta No. 14  
Pt. Sheet No. 239  
of the City Survey  
Margao, Goa.  
Dated this 18th day of April 2016.  
Inspector of Survey and  
Records  
Margao, Goa.

by Receipt No. 1965 of 18/4/16  
Inspector  
Margao - Goa