

SITE PLAN

SHOWING PROPOSED CONVERSION OF LAND FOR M/S ROYAL BUILDERS & REAL ESTATE DEVELOPERS IN PROPERTY BEARING SURVEY NO. 94/3-U AT VARCA, SALCETE, GOA

 PROP. AREA FOR CONVERSION = 1375.00 SQM

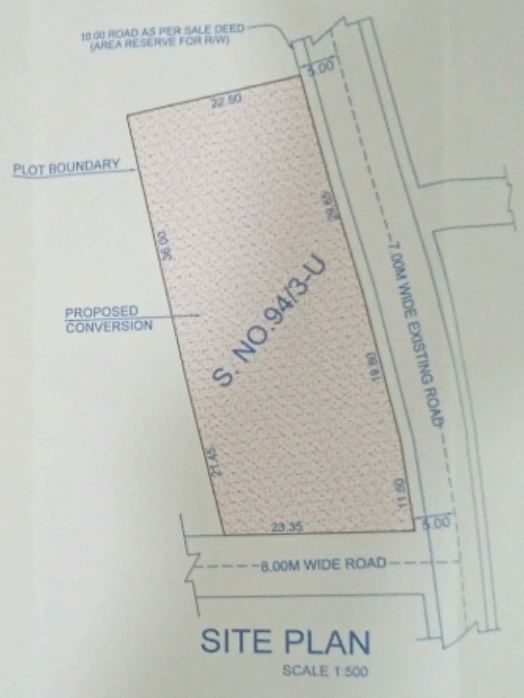

OWNER'S SIGN.

Eg. RUPESH N. VELIP
R.E.(Civil)
Reg. No. ER/2046/2019
PWD Reg. No. 612/99

ENGINEER SIGN.