

# Casa Maria

KUCHELIM - MAPUCA - GOA



ROAD FACING DOUBLE HEIGHT SHOWROOMS & SPACIOUS APARTMENTS

A Project by  
TOLANI DEVELOPERS PVT. LTD.

# Goa . . . escape to a world away from your world

Known for its pristine long stretches of sandy shores, Goa's coastal belt boasts of azure blue waters and palm fringed beaches. The ideal destination for a holiday home, Goa's beaches have a wide range of activities for the whole family. Enjoy Long leisrely walks on sun drenched golden sands revelling in breath taking sunsets while your children dash around, build sand castles and and are entertained with a myraid of adventure and water sports.

Goa's delectable cuisine bekons you to savour delicious sea food, local concoctions and a wide range of authentic traditional fare.



Tropical Cuisine



Music Festivals



Colorful Carnivals



Historical Monuments

The ideal **Holiday** destination !

# Casa Maria

KUCHELIM - MAPUCA - GOA



Modern & Contemporary  
Elevation Style

M/s Prianna Developers, a trusted name in construction bring you their latest project, "Casa Maria" a scheme of road facing shops and apartments at Kuchelim- Mapuca - Goa.

Nestled in the residential enclave of Kuchelim, overlooking the bustling city of Mapuca and close to the NH-17 highway, the homes are ideally located within 12 km of all the famous beaches in North Goa and in close proximity of all facilities like Schools, Professional Colleges, Markets, Bus stop, Hospitals, Banks, Mapuca city, everything being at a close distance from the project.

So come and be a part of "Casa Maria", the perfect gift for your family and a wise investment for the future!

## Premium Lifestyle Amenities

- Exclusive Terrace Apartments
- Automatic 4-passenger elevator
- Provision for washing machine in Utility Balcony
- Battery Backup for lifts
- Invertor for Common lighting

## Project Specifications

**STRUCTURE :** RCC framed structure.

**WALLS :** Laterite stone / brick walls plastered on both surfaces. Cement mortar plastering inside and outside walls. Double coat exterior plastering with waterproof treatment.

Internal walls within the unit finished with Birla Wall Care Putty and painted in plastic paint.

**PAINTING :** Exterior walls rendered with weatherproof paint of Asian/Dulux/ equivalent make.

**DOORS:** Main door – Teak wood for main door frames and main doors with brass fittings and branded main door lock. Internal – Flushed doors finished with laminate. External – Heavy duty powder coated aluminium / UPVC of approved make. Toilet doors – Flushed doors with laminate. Superior quality hardware.

**WINDOWS :** Powder Coated Aluminium/ UPVC windows with glazed panels of plain glass.

**FLOORING :** Flooring in living / dining, passage, bed rooms with polished nano technology vitrified tiles. Kitchen and bathroom with anti skid vitrified tiles.

**TOILETS :** Flooring in anti skid vitrified tiles & dado upto 7' height. C.P fitting of Jaguar / Kohler / equivalent. Concealed plumbing with first class sanitary ware of Jaquar/ Hindware / Kohler or equivalent. Exhaust fan will be provided.

**KITCHEN :** Granite cooking platform with stainless steel sink. Dado upto 2' above the kitchen platform. Exhaust fan will be provided.

**INTERNAL ELECTRIFICATION :** Copper wiring laid in concealed PVC conduits with good quality switches of Anchor/ Crabtree/ equivalent make. TV and Telephone points will be provided in living and bed room. Invertor Provision.

# STILT FLOOR PLAN

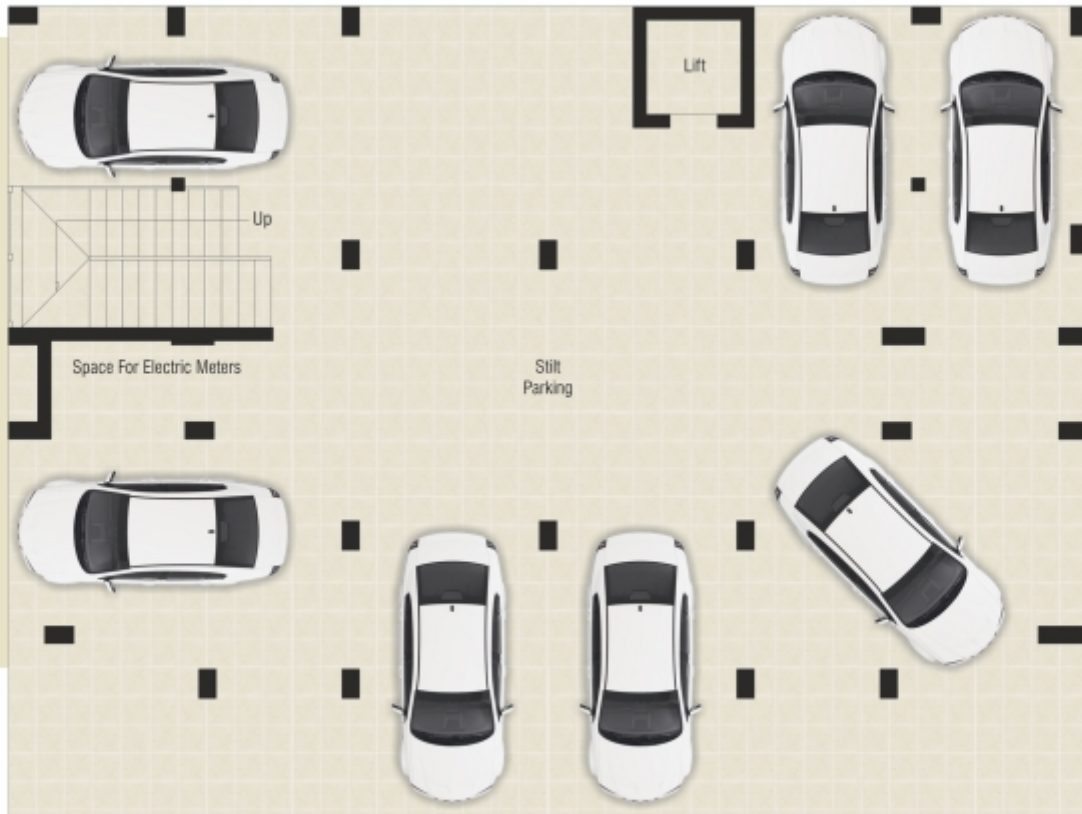

# GROUND FLOOR PLAN

# FIRST FLOOR PLAN





SECOND FLOOR PLAN



THIRD FLOOR PLAN

Ideally located very close to Mapuca city, the homes are in close proximity of all the ultra modern amenities like Schools, Colleges, Markets, Bus stop, Hospitals, Municipality bldg, Banks, Football ground everything being at a walking distance from the project.



## LOCATION MAP (not to scale)



### Approximate distances

- Mapuca Bus stand - 2.6 Km
- Schools - 1 Km
- Hospitals - 500 mts
- Bus stop - 100 mts
- Municipality - 1.5 Km
- Mapuca Court - 1.5 Km
- Church - 1 Km
- Temple - 800 mts

## FOR BOOKINGS CONTACT

### TOLANI DEVELOPERS PVT. LTD.

Lourchem Barda, chalta No-62/2a, Mapusa, Bardez, North Goa, Goa, 403507

Contact : [+91 8888299777](tel:+918888299777) , [+91 8329192099](tel:+918329192099)

Email : [stanleydcosta100@gmail.com](mailto:stanleydcosta100@gmail.com)

## Consultants

Architect : Rahul Sardesai, Panaji, Goa. 9923439101 | RCC Consultant : Paresh Gaitonde, Panaji, Goa. 9822102782