

Mapusa Goa

2 & 3 BHK FOR SALE



Introducing MFA's Rosmar

A luxurious residential project nestled in the heart of Mapusa. Rising majestically over 8 floors, this high-rise development offers a blend of sophistication and comfort, catering to your discerning lifestyle needs. Choose from our meticulously crafted 2BHK and 3BHK residences, each thoughtfully designed to maximize space and enhance livability. Whether you seek the cozy intimacy of a 2BHK or the added space and flexibility of a 3BHK, Rosmar has the perfect home for you.

Experience modern living at its finest with premium amenities and facilities designed to elevate your everyday life. Every aspect of Rosmar is designed to provide you with an unparalleled living experience.

Discover the epitome of urban living in Mapusa with MFA's Rosmar. Welcome home to luxury, comfort, and convenience.



TYPICAL FLOOR PLAN

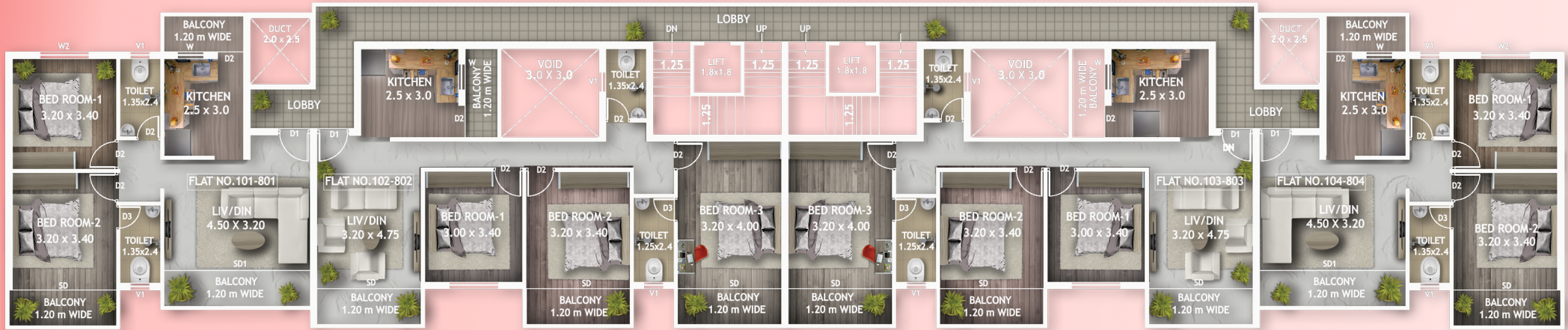

1ST FLOOR TO 8TH FLOOR PLAN
SCALE - 1:100

FLOOR PLANS & SPECIFICATIONS

Structure

R.C.C. framed earthquake resistant structure of approved design.

Flooring

Vitrified flooring of premium brand

Doors & Windows

All doors of good quality local teak or equivalent with Sal wood doorframes. Maintenance free powder coated aluminum sliding /casement open able windows on granite window sills with 10mm MS square bar grill.

Electricals

Sufficient electrical points with modular switches and universal sockets of premium brand. RCCB provision for shock proof electrical installation. Concealed A/c piping and drainage for hall and bedrooms. Inverter provision for every flat with 3 phases connection. Concealed provision for telephone cable TV and DTH

Bathrooms

Antiskid flooring. Glazed/ceramic tiles for full height. Geyser and exhaust fan provisions. Toughened glass shower enclosure. Stainless steel anti pest floor gratings. Premium brand sanitary ware in white colour. Brass chromium plated fittings of premium brand.

Kitchen

Black granite kitchen counter with single bowl stainless steel sink, Water filter provision. Designer dado for wall backing the counter Chimney/ Exhaust provision. Modular kitchen with complete trolleys below the kitchen platform.

Walls

Light weight AAC block masonry /laterite/ block masonry. Wall finish Internal wall finish is gypsum/ cement plaster with premium grade acrylic emulsion. External wall finish is with sand faced double coat plaster with weatherproof paint (Apex or valent)



GET IN TOUCH WITH US

MARIO FERNANDES & CO
6 Comunidade Ghor
2nd Floor, Angod Mapusa
Goa, India - 403 507
Mobile: 9359319887 / 9822124122
Email: mariofernandes.goa@gmail.com
Website: www.mfagoa.com
www.goahomes.in



MARIO FERNANDES & Co.

ARCHITECTS ♦ ENGINEERS ♦ CONSULTANTS ♦ DEVELOPERS