

**PARKING REQUIREMENTS**

NO. OF UNITS	NO. OF CAR PARKS REQ.	NO. OF CAR PARKS PROVIDED
60	60	60

**AREA CALCULATIONS**

FLOOR	STILL FL.	7.5% AREA FREE OF F.A.R.
FIRST FL.	688.55 sq.m	22.58 sq.m
SECOND FL.	688.55 sq.m	-
THIRD FL.	688.55 sq.m	-
FOURTH FL.	688.55 sq.m	-
FIFTH FL.	688.55 sq.m	-
<b>TOTAL B.U.A.</b>	<b>3442.75 sq.m</b>	<b>138.48 sq.m</b>

**AREA STATEMENT**

1	AREA OF THE PLOT	= 1111.00 SQ.M
2	AREA FOR ROAD WIDENING	= 225.00 SQ.M
3	EFFECTIVE AREA OF THE PLOT (1-2)	= 886.00 SQ.M
4	ZONE	= S1
5	PERMISSIBLE COVERAGE (40%)	= 354.40 SQ.M
6	PROPOSED COVERAGE	= 834.17 SQ.M
7	PERMISSIBLE F.A.R (100%)	= 3445.00 SQ.M
8	PROPOSED B.U.A	= 3442.75 SQ.M
9	COVERAGE CONSUMED	= 93.90 %
10	F.A.R. CONSUMED	= 93.93%
11	PERMISSIBLE AREA FREE OF F.A.R FOR INFRASTRUCTURAL FACILITIES (7.5% OF PROPOSED B.U.A)	= 258.20 SQ.M
12	PROPOSED AREA FREE OF F.A.R FOR INFRASTRUCTURAL FACILITIES (7.5% OF PROPOSED B.U.A)	= 83.28 SQ.M
13	AREA FREE OF F.A.R (S&M)	= 628.26 SQ.M
14	AREA FREE OF F.A.R (Balconies, Foyers)	= 1360.85 SQ.M
15	LENGTH OF COMPOUND WALL	= 175.05 M

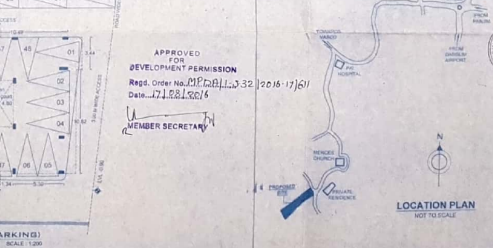
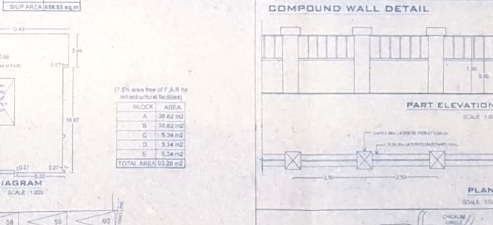
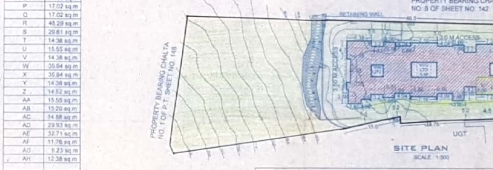

**BOOK - WINDOW SCHEDULE**

ZONE	TYPE	NO.	AREA (sq.m)	PERCENTAGE (%)
Z-1	W	W1	1.20	1.20
		W2	0.80	0.80
		W3	1.50	1.50
		W4	1.00	1.00
		W5	1.20	1.20
		W6	1.50	1.50
		W7	1.00	1.00
		W8	1.20	1.20
		W9	1.50	1.50
		W10	1.00	1.00
Z-2	W	W11	1.20	1.20
		W12	0.80	0.80
		W13	1.50	1.50
		W14	1.00	1.00
		W15	1.20	1.20
		W16	1.50	1.50
		W17	1.00	1.00
		W18	1.20	1.20
		W19	1.50	1.50
		W20	1.00	1.00

**APPROVED FOR DEVELOPMENT PERMISSION**  
Regd. Order No. M/2011/J-32 (2016-17/20)  
Date: 17/02/2016

**MEMBER SECRETARY**

**OWNER:** Arav Jain Shakti

**ARCHITECT:** VISHVA TAPADIA ARCH/0221/2011

**DATE:** 30-06-2016

**SCALE:** 1:200

**PROJECT:** MICHON'S REGINA PROPOSED RESIDENTIAL DEVELOPMENT ON PLOT OF BEARING CHALTA NO. 124 OF P.T. SHEET NO. 142 AT VASCO DIST. COA.

**NOTE:** Ref. Order No. M/2011/J-32/13-12/18 DATED 04/03/11

VISHVA TAPADIA  
138 Ligon, Oranada, Alca, Debalim, Goa-28  
Email: vishva\_tapadia@gmail.com, Ph: 9037327008

COPYRIGHT 2016 BY THE ARCHITECT. ALL RIGHTS RESERVED. NO PART OF THIS DRAWING SHOULD BE REPRODUCED OR DISTRIBUTED IN ANY FORM OR BY ANY MEANS OR STORED IN A DATABASE OR ANY RETRIEVABLE SYSTEM, WITHOUT THE PRIOR PERMISSION OF THE ARCHITECTS.