



CHRYSANTHE
SUITES
estilo patio phase II

Chrysanthe Suites rises up with 2BHK apartments, which is Phase III of the project Estilo Patio. Beautifully planned layouts with minimum loading between carpet and salable area.



ESTILO MODERNO
REALTY PVT. LTD.

A Dr. Sagar Salgaocar INITIATION

RERA ID: PRGO10190905
www.rera.goa.gov.in

01



concept

Chrysanthe is a native flower of North East Europe, Symbolizing - optimism, joy and expresses cheerfulness with its yellow radiance.

Estilo Moderno Realty thus seeks to exclusively build buoyant luxury spaces along beautifully sculpted landscapes, with a guarantee of uncompromising quality. Our mission is to serve the real estate needs of our clients with the utmost professionalism, prompt personalized customer service and unfailing attention to detail in quality control.



**WHERE COMFORT
MEETS STYLE**
CHRYSANTHE SUITES

Chrysanthe Suites stand out with alluring 2BHK apartments, in a weave of beautiful, luxurious European-style villas, that are located in Sancoale, South Goa. The breathtaking views of blue skies and the refreshingly fresh air, serve a splendid platter of pure Goan delight. Designed to provide a sense of holistic living, Chrysanthe apartments are the perfect escape from the hustle and bustle that are part of a busy life. Lavish spaces, a beautiful Zuari river view, 24x7 security, housekeeping services, bicycles to scale the beautiful landscape, a roof-top infinity pool and a clubhouse, together enhance this experience.

02

Living
in

CHRYSANTHE
SUITES
estilo patio phase II

Lifestyle

The greatest luxury of life is - peaceful breathing and only place to get that is at Chrysanthe Suites, Goa



BALCONY

"It's a place which is a new world in its own."
Chrysanthe Suites has serene view of Zuari river that keep you refresh.



BEDROOM

"Your private world with an equal dose of luxury and aesthetic appeal, where you rest your spirit and be yourself."

BATHROOM

"Wash away your trouble with some bubbles."



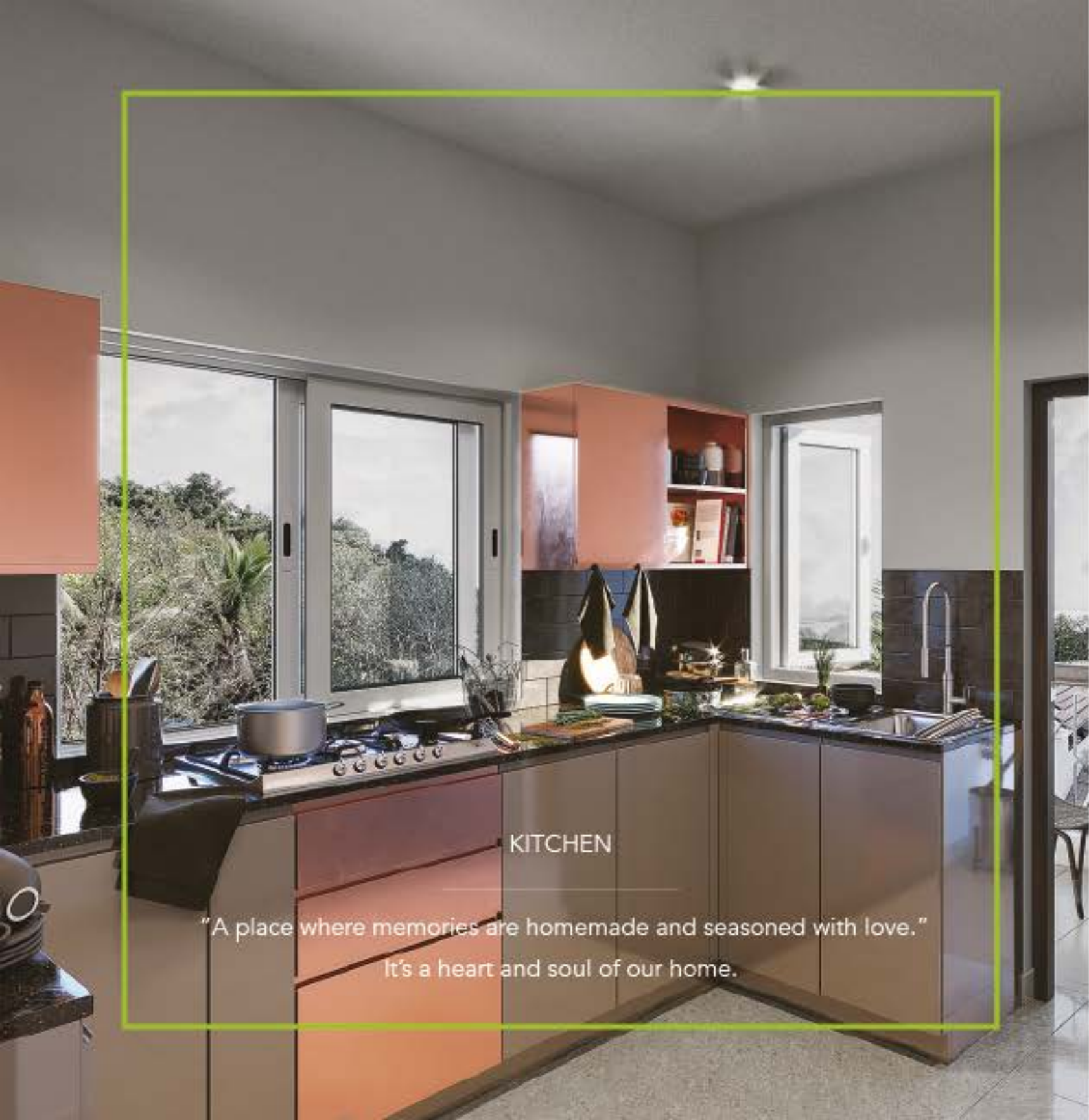

KITCHEN

"A place where memories are homemade and seasoned with love."
It's a heart and soul of our home.



LIVING ROOM

"From celebrating joy to sharing laughs, bringing
your family and friends together."

TYPE A CORNER UNIT

- . Carpet Area as per RERA
- . Built up Area
- . External Wall, Balcony Area / Terrace
- . Common Area (Lift, Lobby & Staircase shared)

Saleable Area
Net Usable Area

Area in sqmt.	Area in sqft.
-73.00 sqmt.	-785.77 sqft.
-98.30 sqmt.	-1058.10 sqft.
-9.40/15.90 sqmt.	-101.18/171.15 sqft.
-11.15 sqmt.	-120.02 sqft.
-109 sqmt.	-1178 sqft.
-89 sqmt.	-958 sqft.

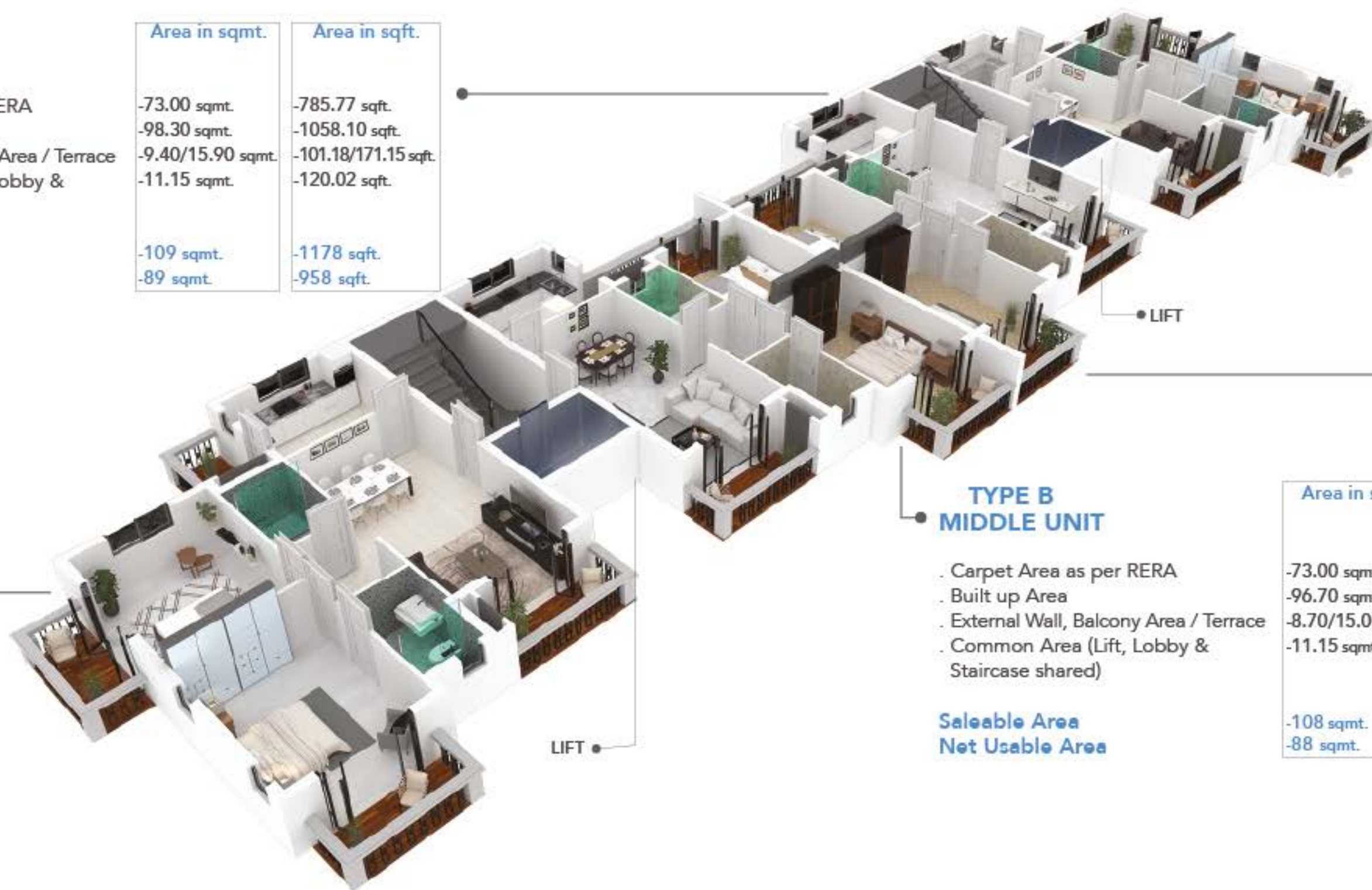

TYPE B MIDDLE UNIT

- . Carpet Area as per RERA
- . Built up Area
- . External Wall, Balcony Area / Terrace
- . Common Area (Lift, Lobby & Staircase shared)

Saleable Area
Net Usable Area

Area in sqmt.	Area in sqft.
-73.00 sqmt.	-785.77 sqft.
-96.70 sqmt.	-1040.87 sqft.
-8.70/15.00 sqmt.	-93.65/161.46 sqft.
-11.15 sqmt.	-120.02 sqft.
-108 sqmt.	-1166 sqft.
-88 sqmt.	-947 sqft.

Full Floor Plan



**TYPE A
CORNER UNIT PLAN**

Net Usable Area: 89 sqmt. / 958 sqft.
Saleable Area : 109 sqmt. / 1178 sqmt.



**TYPE B
CENTER UNIT PLAN**

Net Usable Area: 88 sqmt. / 947 sqft.
Saleable Area : 108 sqmt. / 1166 sqft.

MATERIALS & FINISHES FOR APARTMENTS

DOORS & WINDOWS

Main Door shall be of marine grade flush panel with veneer and wooden beading and shall have Mortise Locks.
All the other doors shall be the Flush door with laminate.
White colour UPVC French doors and windows.

PLUMBING

CPVC piping for hot water and PVC piping for cold water line.



KITCHEN

Kitchen Platform will be of granite top with Composite material sink.

PAINTING

Internal walls to be painted with Emulsion paints.

External walls to be painted with Weatherproof Cement paint.





WASHROOM AND WC

The toilet flooring shall be of non-skid ceramic tiles and the walls will have contemporary tiling systems. Concealed plumbing with Grohe or equivalent tap fittings shall be provided along with American Standard or equivalent sanitary ware.

TILING / FLOORING

Vitrified in living / Dining/ Bedroom and Kitchen , Non-Skid Tiles in Balcony / Open Sit – outs.



ELECTRIFICATION

Each Apartment shall have 3 phase power supply.
Concealed conduits shall be provided of RR cable / KEI cables or equivalent.
Adequate number of light points, fan points, power points, switches and sockets of Legrand / equivalent.
Wiring provisions for TV sets in Living Room & Bedrooms shall be made.
Provision for Inverter for each apartment shall be made.



PLASTER

Internal

Single coat plaster / Gypsum Plaster.

External

Double coat plaster.

STRUCTURE

R.C.C frame structure with M20 / M25 grade concrete.



MASONRY

All external walls shall be constructed with 23 cm thick Light Weight AAC blocks. Internal walls shall be of 10 cm thick with light Weight AAC block.



03

Experience

The premium luxury apartments boast top notch in-house , 24X7 security, housekeeping services, a bicycle facility, infinity pool and a clubhouse that make it a truly majestic experience. Further, Chrysanthe delivers on the promise of quality. Each home is certified by the Indian Green Building Council.

Gym & Recreational Plan



Gym Area: 41 sqmt. / 441 sqft.
Recreational Area: 33 sqmt. / 355 sqft.



INFINITY POOL

"Swim away your worries and stress in our top floor swimming pool watching over the Zuari river."



MEMBER OF GREEN BUILDING COUNCIL

An Eco-conscious Living

We are a certified member of the Indian Green Building Council. Green building rating brings together a host of sustainable practices and solutions to reduce the environmental impacts. We are committed to building a better environment. Our aim is to emerge as distinguished eco-conscious luxury realtors renowned for delivering with passion and expertise that goes beyond exclusive properties.



#CHRYSANTHESUITES

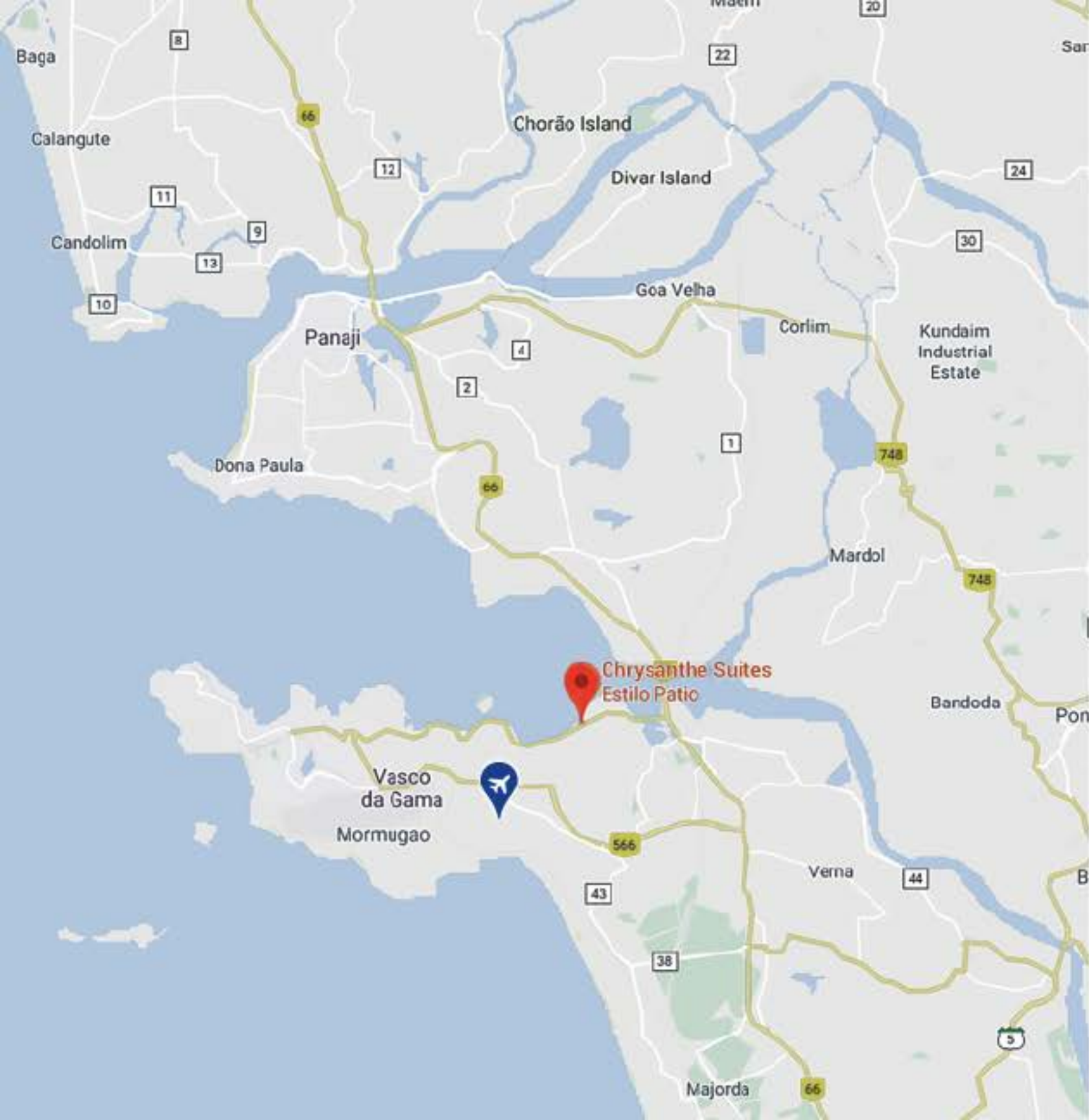

LOCATION

Estilo Patio- Chrysanthe Suites merely a 10-minute drive by the picturesque Zuari riverside road from Dabolim airport.

- Equidistant 25 mins drive from the chic sophistication of the lively capital city Panjim, and the bustling commercial capital Margao.
- 10 Mins drive to Port town Vasco city, all the main modern shopping facilities, SMRC Hospital, Schools, Colleges, BITS Pilani, many renowned dining places and Bogmalo Beach.
- Within 45 Mins drive to prominent beaches of Goa like Calangute, Baga In North & 30 Mins to Colva beach in South.

Luxury homes
have shifted to

CHRYSANTHE
SUITES
estilo patio phase II

have you?





SOLD OUT

Villa Armeria

Phase I of the Estilo Patio project seems as European as the flower itself which is found in abundance along the coast of Portugal and Southern Spain.

SOLD OUT

Villa Bellis

Phase II villas are all beautifully designed, leaving you spoilt for choice. The European characteristics & architectural charm has been carefully imbibed with attention.

ONGOING

Chrysanthe Suites

Chrysanthe Suites rises up with 2BHK apartments, which is Phase III of the project Estilo Patio. Beautifully planned layouts with minimum loading

Estilo Moderno Realty Pvt. Ltd. Near St. John of the Cross Convent,
Sarфона, Sancoale, Goa.

+91 83084 33200 / +91 88050 24874
sales@estilomodernorealty.com

Disclaimer

All the furniture, interiors & cars shown are of indicative nature & they do not form the part of an legal offer or contract and does not represent the actual use.