

DETAIL OF BOUNDARY WALL
N.T.S.

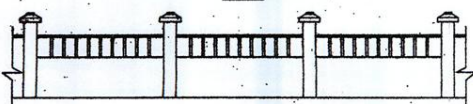

ELEVATION

Licence issued under No. A/30113-18 dated 27/09/2017
Subject to the conditions stipulated therein.

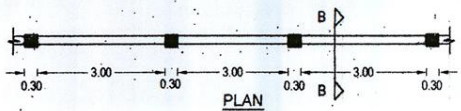
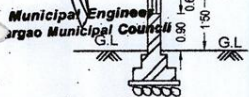

SECTION AT BB

Municipal Engineer
Margao Municipal Council

CHIEF OFFICER,
MARGAO MUNICIPAL COUNCIL

PROPOSED
COMPOUND WALL

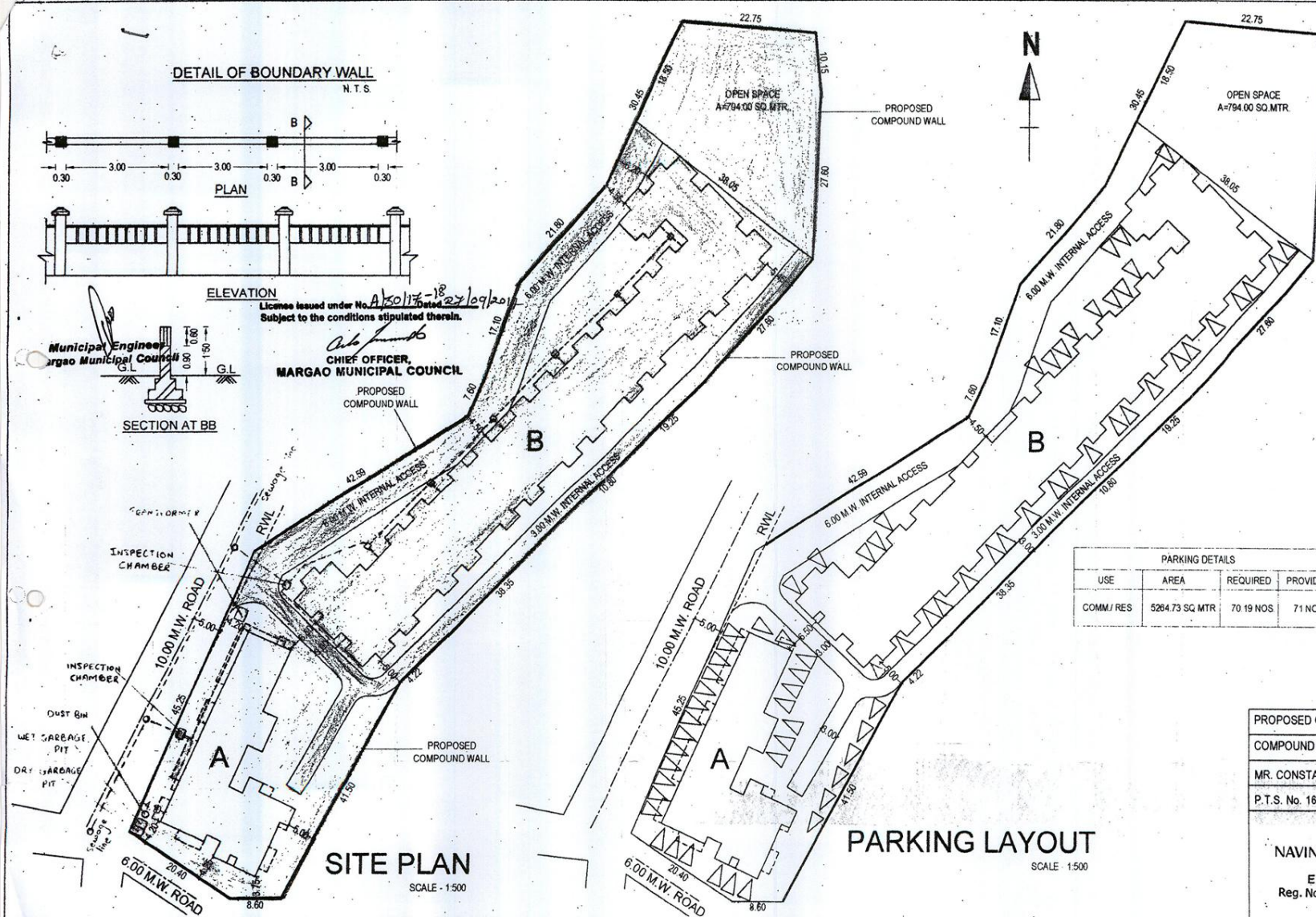

SITE PLAN

SCALE - 1:500

PARKING LAYOUT

SCALE - 1:500

| PARKING DETAILS | | | |
|-----------------|-----------------|-----------|----------|
| USE | AREA | REQUIRED | PROVIDED |
| COMM / RES | 5284.73 SQ. MTR | 70 19 NOS | 71 NOS |

AREA STATEMENT

| | | |
|--|---------------|---------|
| 01 Area of the Plot | 5290.00 | Sq.mts. |
| 02 Deduction for Area within road widening / proposed | 15.00 | Sq.mts. |
| 03 Net effective area of plot | 5275.00 | Sq.mts. |
| 04 Covered area of the Building | 1771.52 | Sq.mts. |
| 05 Plot coverage of the Building (in %) | 33.58 % | |
| 06 Area reserved for open space | 794.00 | Sq.mts. |
| Balcony area & covered area over footways floor-wise & total on all floors (307.78 + 534.60) | | |
| | 842.38 | Sq.mts. |
| BUILDING A | | |
| 07 (a) Floor area consumed on ground floor | 370.85 | Sq.mts. |
| (b) Floor area consumed on upper gr. floor | 334.00 | Sq.mts. |
| (c) Floor area consumed on first floor | 334.00 | Sq.mts. |
| (d) Floor area consumed on second floor | 334.00 | Sq.mts. |
| 08. Total floor area consumed | 1372.85 | Sq.mts. |
| BUILDING B | | |
| 09 (a) Floor area consumed on ground floor | 972.97 | Sq.mts. |
| (b) Floor area consumed on upper gr. floor | 972.97 | Sq.mts. |
| (c) Floor area consumed on first floor | 972.97 | Sq.mts. |
| (d) Floor area consumed on second floor | 972.97 | Sq.mts. |
| 10. Total floor area consumed | 3891.88 | Sq.mts. |
| 11 Total floor area of both the building (8 + 10) | 5284.73 | Sq.mts. |
| 12 F A R consumed | 99.52 % | |
| 13 Front set back | 4.10 | Mts. |
| 14 Rear set back | 4.22 | Mts. |
| 15 Distance between two buildings | 6.60 | Mts. |
| 16 Height of plinth | 0.30 & 0.60 | Mts. |
| 17 Height of Building | 13.85 & 11.50 | Mts. |
| 18 Height of compound wall | 1.50 | Mts. |
| 19 Length of compound wall | 321.76 | Mts. |

AREA FOR INFRASTRUCTURAL TAX
Development Permission Order
Subject To Conditions Vide Order
No. SGPDA/P/5962/1935/1A-18
Dated 28/09/2017

Member Secretary

PROPOSED COMMERCIAL / RESIDENTIAL BUILDING 'A' & RESIDENTIAL BUILDING 'B' AND
COMPOUND WALL FOR MR. JOAO TADEU FRANCISCO ANTONIO MENINO GOMES DA CRUZ &
MR. CONSTANCIO XAVIER JUDE MACBETH CRUZ, IN PLOT BEARING CH. No. 8 OF
P.T.S. No. 162, SITUATED AT MARGAO SALCETE-GOIA

NAVINT S. ARSEKAR
B. E. (Civil)
ENGINEER
Reg. No. ER/0019/2010

ENGINEER

OWNER