

PROPOSED COVERED AREA (B1 TO B4) 4 nos	3467.68 M2
PROPOSED COVERED AREA (C1 TO C7) 7nos	4387.95 M2
PROPOSED COVERED AREA (D1) 1 nos	866.92 M2
PROPOSED COVERED AREA (CLUB HOUSE-1)	200.00 M2
TOTAL PROPOSED COVERED AREA	14,648.55 M2
PROPOSED FLOOR AREA (S1)-	
PROPOSED F.A.R (A1 TO A4) 4 nos	17865.96 M2
PROPOSED F.A.R (B1 TO B4) 4 nos	13011.92 M2
PROPOSED F.A.R (C1 TO C7) 7nos	16425.50 M2
PROPOSED F.A.R (D1) 1 nos	3079.38 M2
TOTAL PROPOSED F.A.R	50,382.76 M2
PROPOSED BUILT UP AREA (S1)-	
PROPOSED B.U.A (A1 TO A4) 4 nos	19404.00 M2
PROPOSED B.U.A (B1 TO B4) 4 nos	18889.76 M2
PROPOSED B.U.A (C1 TO C7) 7nos	26592.30 M2
PROPOSED B.U.A (D1) 1 nos	4722.44 M2
PROPOSED B.U.A (BASEMENT PARKING)	36753.15 M2
PROPOSED B.U.A (CLUB HOUSE-1)	200.00 M2
TOTAL PROPOSED B.U.A	1,06,561.65 M2

PROPOSED COVERED AREA (S4)-	
PROPOSED COVERED AREA (TYPE-A)125	9612.50 M2
PROPOSED COVERED AREA (TYPE-B)52	3998.80 M2
TOTAL PROPOSED COVERED AREA	13,611.30 M2
PROPOSED FLOOR AREA (S4)-	
PROPOSED F.A.R (TYPE-A)125	15000.00 M2
PROPOSED F.A.R (TYPE-B) 52	7196.80 M2
TOTAL PROPOSED F.A.R	22,196.80 M2
PROPOSED BUILT UP AREA (S4)-	
PROPOSED B.U.A (TYPE-A)125	20993.75 M2
PROPOSED B.U.A (TYPE-B) 52	8733.40 M2
TOTAL PROPOSED B.U.A	29,727.15 M2

NOS	OPEN SPACE (S1)	AREA
C1	PROPOSED OPEN SPACE-1	1375.00 M2
C2	PROPOSED OPEN SPACE-2	1548.76 M2
C3	PROPOSED OPEN SPACE-3	1620.00 M2
C4	PROPOSED OPEN SPACE-4	3075.00 M2
C5	PROPOSED OPEN SPACE-5	1895.00 M2
TOTAL PROPOSED OPEN SPACE		9513.76 M2

NOS	OPEN SPACE (S1)	AREA	PERMISSIBLE F.A.R (5%) FREE ON OPEN SPACE
C1	PROPOSED OPEN SPACE-1	4415.00 M2	220.75 M2
C2	PROPOSED OPEN SPACE-2	1895.00 M2	0.00 M2
C3	PROPOSED OPEN SPACE-3	1895.00 M2	0.00 M2
C4	PROPOSED OPEN SPACE-4	575.00 M2	0.00 M2
TOTAL PROPOSED OPEN SPACE		8780.00 M2	220.75 M2

SWIMMING POOL AREA	
D1 SWIMMING POOL	60.00 M2
TOTAL	60.00 M2

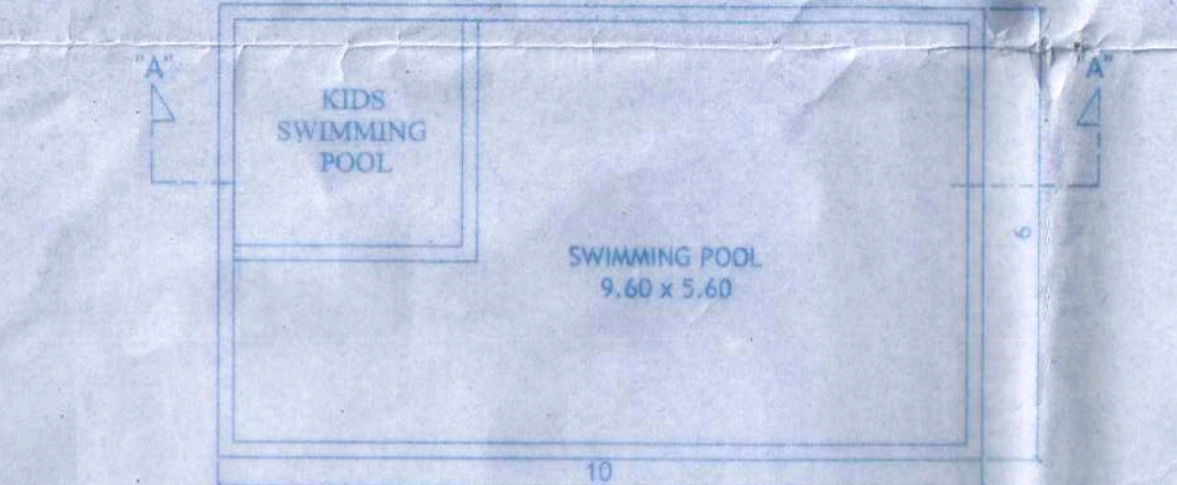
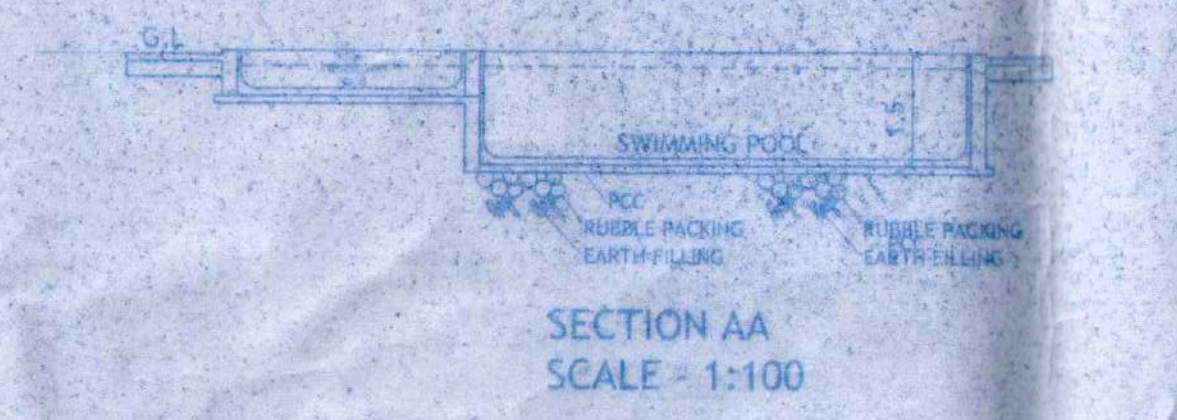

CAR PARKING STATEMENT	
A BLOCK (A1 A2 A3 A4) COMMERCIAL (04 BLOCK)	
1 REQUIRED PARKING (448 4950+00 CARS X 4 BLOCK)	=350 Cars
2 PROVIDED PARKING (BASEMENT PARKING)	=257 Cars
3 PARKING PROVIDED (SURFACE PARKING)	=105 Cars
4 PARKING PROVIDED (VALET PARKING)	=177 Cars
5 PARKING PROVIDED (BASEMENT + SURFACE+VALET PARKING)	=533 Cars
B BLOCK (B1 B2 B3 B4) APARTMENT UNITS (04 BLOCK)	
6 REQUIRED PARKING (1068 x 98 UNITS X 4 BLOCK)	=864 Cars
7 PARKING PROVIDED (STILT PARKING)	=86 Cars
8 PARKING PROVIDED (BASEMENT PARKING)	=273 Cars
9 PARKING PROVIDED (SURFACE PARKING)	=102 Cars
10 PARKING PROVIDED (VALET PARKING)	=97 Cars
11 PARKING PROVIDED (STILT + BASEMENT + SURFACE + VALET PARKING)	=458 Cars
C BLOCK (C1 C2 C3 C4 C5 C6 C7) APARTMENT (07 BLOCK)	
12 REQUIRED PARKING (1048 x 64 UNITS X 7 BLOCK)	=448 Cars
13 PARKING PROVIDED (STILT PARKING)	=210 Cars
14 PARKING PROVIDED (BASEMENT PARKING)	=139 Cars
15 PARKING PROVIDED (VALET PARKING)	=110 Cars
16 PARKING PROVIDED (STILT + BASEMENT+VALET PARKING)	=456 Cars
D BLOCK (D1) APARTMENT/COMMUNITY HALL UNITS (01 BLOCK)	
17 REQUIRED PARKING (1068 x 90 UNITS X 1 BLOCK)	=90 Cars
18 REQUIRED PARKING (102,250+18 CARS X 1 BLOCK)	=104 Cars
19 TOTAL REQUIRED PARKING	=194 Cars
20 PARKING PROVIDED (STILT PARKING)	=24 Cars
21 PARKING PROVIDED (BASEMENT PARKING)	=170 Cars
22 PARKING PROVIDED (VALET PARKING)	=22 Cars
23 PARKING PROVIDED (STILT + BASEMENT + VALET PARKING)	=196 Cars
E TYPE-A ROW HOUSE (08BLOCK/120 VILAS)	
24 REQUIRED PARKING (1068 x 120 VILAS)	=120 Cars
25 PARKING PROVIDED	=129 Cars
F TYPE-B ROW HOUSE (08BLOCK/52 VILAS)	
26 REQUIRED PARKING (1068 x 52 VILAS)	=52 Cars
27 PARKING PROVIDED	=52 Cars
G PARKING REQUIRED	
10% VISITORS PARKING	=193 Cars
TOTAL PARKING REQUIRED	=4193 Cars
H PARKING PROVIDED	
BASEMENT PARKING (2+15+4+2)	=209 Cars
STILT PARKING (7+13+2)	=130 Cars
ROW HOUSE (25+2)	=117 Cars
SURFACE PARKING (1+3)	=110 Cars
VALET PARKING (4+10+15+2)	=279 Cars
TOTAL PARKING PROVIDED	=1733 Cars

AREA STATEMENT		
AREA UNDER SR. NO.13 / 1-C		
A	TOTAL PLOT AREA	113468.00 M2
B	AREA OF PLOT (S1)	63340.00 M2
C	AREA OF PLOT (S4)	44415.00 M2
D	AREA OF PLOT (A2)	5713.00 M2
E	AREA UNDER (S1)	63340.00 M2
F	AREA UNDER R/W	3216.00 M2
G	AREA UNDER O.D.P ROAD	1700.00 M2
H	NET PLOT AREA (E-F-G)	58424.00 M2
I	PERMISSIBLE COVERAGE (40%) (Hx40%)	23369.60 M2
J	F.A.R PERMISSIBLE (0.80) (Ex0.80)	50672.00 M2
K	APPROVED COVERED AREA	20179.17 M2
L	APPROVED COVERAGE (K/Hx100)	35.00 %
M	PROPOSED REVISED COVERED AREA	14648.55 M2
N	PROPOSED REVISED COVERAGE(M/Hx100)	25.07 %
O	AREA UNDER (S4)	44415.00 M2
P	AREA UNDER O.D.P ROAD	1700.00 M2
Q	NET PLOT AREA (O-P)	42715.00 M2
R	PERMISSIBLE COVERAGE (40%) (Qx40%)	17086.00 M2
S	F.A.R PERMISSIBLE (0.50) (Ox0.50)	22207.50 M2
T	APPROVED COVERED AREA	13773.15 M2
U	APPROVED COVERAGE (T/Qx100)	32.84 %
V	PROPOSED REVISED COVERED AREA	13611.30 M2
W	PROPOSED REVISED COVERAGE (X/Qx100)	31.86 %
A1	F.A.R PERMISSIBLE - S1+S4 (J+S)	72,879.50 M2
A2	APPROVED F.A.R - S1+S4	67,869.33 M2
A3	PROPOSED F.A.R - S1+S4	4,950.23 M2
A4	TOTAL F.A.R (APP.+PRO.) S1+S4 (A2+A3)	72,579.56 M2
B1	REQUIRED OPEN SPACE 15% (S1)(Hx15%)	8763.60 M2
B2	TOTAL AVAILABLE OPEN SPACE (S1)	8780.00 M2
B3	REQUIRED OPEN SPACE 15% (S4)(Tx15%)	6407.25 M2
B4	TOTAL AVAILABLE OPEN SPACE (S4)	9313.75 M2

REF:-TIS/6697/PAN/TCP/11/1100
DATED:-08/07/2011

SITE PLAN

ARCHITECTS:
CLIENTS:

OWNER:
M/S. NAIKNAVER CONSTRUCTION.PVT.LTD.

PROJECT:
PROPOSED REVISION ON S.NO. 13/1-C
AT VILLAGE PANELIM, TAL. TISWADI GOA, INDIA

DWG: SITE PLAN, COMPOUND WALL & AREA STATEMENT

DRG NO: DRN BY: V.G
JOB NO: CHKD BY: B.S.
SCALE: 1:100, 1:500 DATED: 18-01-10

ARCHITECTS:
SOARES & ASSOCIATES

D1	PERMISSIBLE 7.50% ADDITIONAL F.A.R FOR SERVICES & LOBBY ETC. (S1) 50382.76 x 7.50 %	3778.70 M2
D2	PROPOSED 7.50% ADDITIONAL F.A.R FOR SERVICES, LOBBY, CLUB HOUSE, ETC.	2466.39 M2

Please Check Letter No. TIS/6697/PAN/11/1100 dated 08/07/2011 regarding the Plan.

Town & Country Planning Dept
Govt. of Goa
Tiswadi, Panaji, Goa



SITE PLAN
SCALE: 1:500



Medical Offices AA
Pharmacy Health Centre