

Please check order No. PN/36751/aird/94/3 & 94/3-A  
2025/6505 dated 01/09/2025  
 recording the plans

*[Signature]*  
 Dy. Town Planner  
 Town & Country Planning Dept.,  
 South Goa Dist. Office Margao -Goa

This plan is approved by Def. Res. No. 3/20  
10/09/2025  
 v.p./aird/07/2025-24/629  
19/09/2025

*[Signature]*  
 Secretary  
 V.P. Guirdolim



SITE PLAN BEFORE AMALGAMATION  
 SCALE 1:1000

SITE PLAN AFTER AMALGAMATION  
 SCALE 1:1000

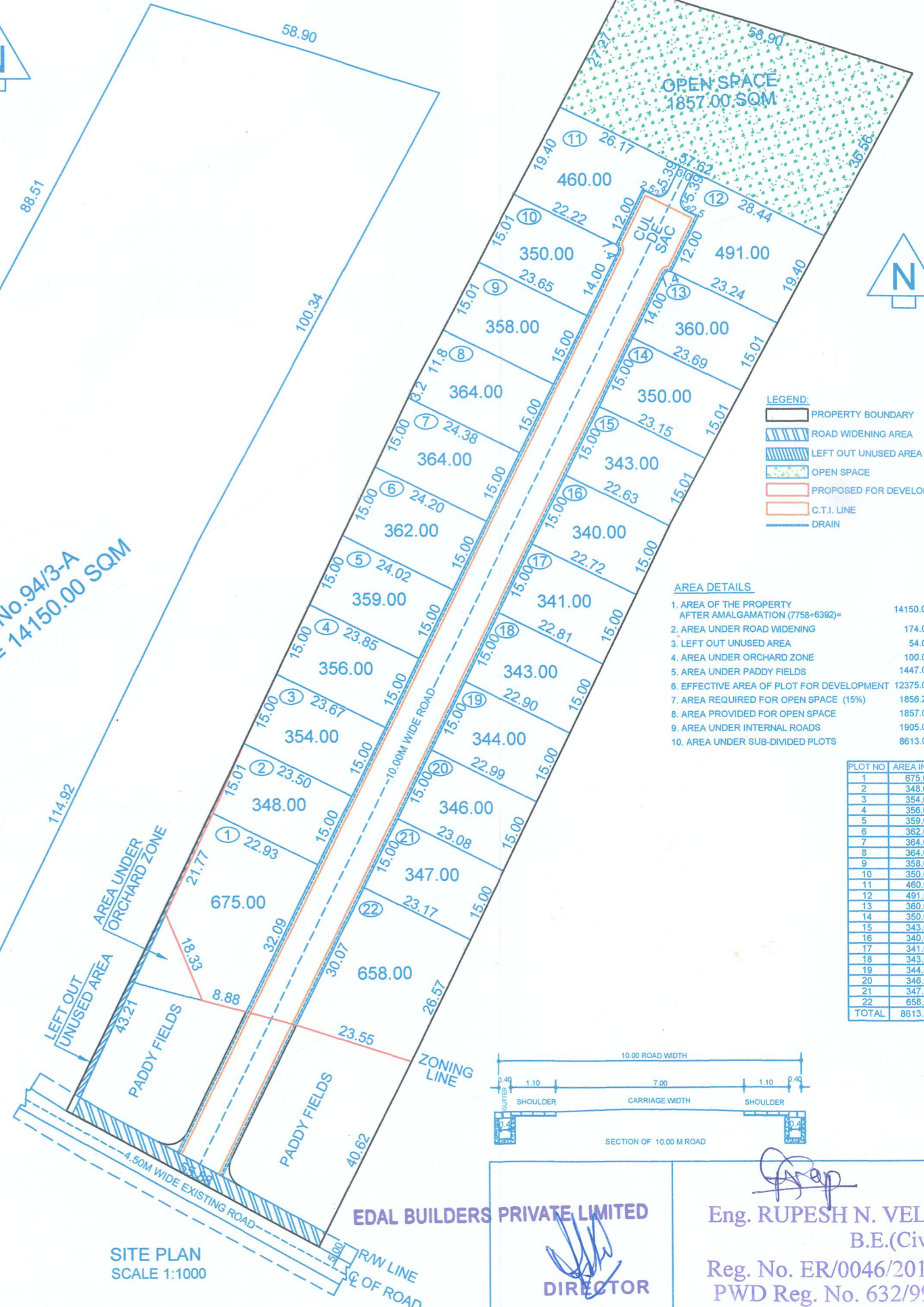

- LEGEND:
- PROPERTY BOUNDARY
  - ROAD WIDENING AREA
  - LEFT OUT UNUSED AREA
  - OPEN SPACE
  - PROPOSED FOR DEVELOPMENT
  - C.T.I. LINE
  - DRAIN

AREA DETAILS

1. AREA OF THE PROPERTY AFTER AMALGAMATION (7758+6392)=	14150.00 SQM
2. AREA UNDER ROAD WIDENING	174.00 SQM
3. LEFT OUT UNUSED AREA	54.00 SQM
4. AREA UNDER ORCHARD ZONE	100.00 SQM
5. AREA UNDER PADDY FIELDS	1447.00 SQM
6. EFFECTIVE AREA OF PLOT FOR DEVELOPMENT	12375.00 SQM
7. AREA REQUIRED FOR OPEN SPACE (15%)	1856.25 SQM
8. AREA PROVIDED FOR OPEN SPACE	1857.00 SQM
9. AREA UNDER INTERNAL ROADS	1905.00 SQM
10. AREA UNDER SUB-DIVIDED PLOTS	8613.00 SQM

PLOT NO	AREA IN SQM
1	675.00
2	348.00
3	354.00
4	356.00
5	359.00
6	362.00
7	364.00
8	364.00
9	358.00
10	350.00
11	460.00
12	491.00
13	360.00
14	350.00
15	343.00
16	340.00
17	341.00
18	343.00
19	344.00
20	346.00
21	347.00
22	658.00
TOTAL	8613.00

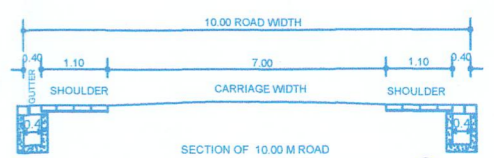

SITE PLAN SCALE 1:1000

EDAL BUILDERS PRIVATE LIMITED

DIRECTOR

*[Signature]*  
 Eng. RUPESH N. VELIP  
 B.E.(Civil)  
 Reg. No. ER/0046/2010  
 PWD Reg. No. 632/99

ENGINEER SIGN

OWNER'S SIGN

PLAN SHOWING PROPOSED AMALGAMATION & SUB-DIVISION OF PLOTS (PROVISIONAL NOC) IN PROPERTY BEARING S. NO.94/3 & 93/3-A AT VILLAGE GUIRDOLIM OF SALCETE TALUKA, GOA FOR M/S. EDAL BUILDERS PRIVATE LIMITED.