



OFFICE OF THE ADDITIONAL COLLECTOR-III, NORTH GOA DISTRICT,
MAPUSA - GOA.

No. 4/67/CNV/AC-III/2021/758

Dated : - 29/06/2021.

Read: Application dated 04/09/2019 received from Leander Nehru Alvares H. No. 492, Silvawaddo, Parra, Bardez - Goa, received u/s 32 of LRC 1968.

SANAD

SCHEDULE-II

(See Rule 7 of the Goa Land Revenue (Conversion of use of land and non-agricultural Assessment) Rules, 1969).

Whereas an application has been made to the Collector of North Goa (Hereinafter referred to as "the Collector" which expression shall include any officer whom the Collector shall appoint to exercise and perform his powers and duties under this grant) under section 32 of the Goa Land Revenue Code, 1968 (hereinafter referred to as "the said code which expression shall, where the context so admits include the rules and orders there under by Leander Nehru Alvares H. No. 492, Silvawaddo, Parra, Bardez-Goa, being the occupant of the plot registered under Survey No. 205/25 & 27 situated at parra, Bardez Taluka (hereinafter referred to as "the applicant, which expression shall, where the context so admits include his/her heirs, executors, administrators and assigns) for the permission to use the plots of land (hereinafter referred to as the "said plot") described in the Appendix I hereto, forming a part under Survey Nos. 205/25 & 27 admeasuring 1160 Sq. mtrs be the same a little more or less for the purpose of Residential with 60 F.A. R.

Now, this is to certify that the permission to use for the said plots is hereby granted, subject to the provisions of the said Code, and rules thereunder, and on the following conditions, namely :-

1. Levelling and clearing of the land - The applicant shall be bound to level and clear the land sufficiently to render suitable for the particular non-agricultural purpose for which the permission is granted, to prevent insanitary conditions.

2. Assessment - The applicant shall pay the non-agricultural assessment when fixed by the Collector under the said Code and rules thereunder with effect from the date of this Sanad.

3. Use - The applicant shall not use the said land and building erected or to be erected thereon for any purpose other than Residential without the previous sanction of the Collector.

4. Liability for rates - The applicant shall pay all taxes, rates and cesses liable on the said land.

5. Penalty clause - (a) If the applicant contravenes any of the foregoing conditions, the Collector may, without prejudice to any other penalty to which the applicant may be liable under the provisions of the said Code, continue the said plot in the occupation of the applicant on payment of such fine and assessment as he may direct.

(b) Notwithstanding anything contained in sub-clause (a) it shall be lawful for the Collector to direct the removal or alteration of any building or structure erected or used contrary to the provisions of this grant within such time as specified in that behalf by the Collector, and on such removal or alteration not being carried out, recover the cost of carrying out the same from the applicants as arrears of land revenue.

6. a) If any information furnished by the applicant for obtaining the Sanad is found to be false at a later stage, the Sanad issued shall be liable to be withdrawn without prejudice to the legal action that may be taken against the applicant.

b) If any dispute arises with respect to the ownership of the land, the Sanad granted shall stand revoked and the construction/development carried out shall be removed at the cost and risk of the applicant.

c) The necessary road widening set-back is to be maintained before any development in the land

d) Traditional access passing through the plot, if any, shall be maintained.

e) No trees shall be cut except with prior permission of the competent authority.

7. Code provisions applicable - Save as herein provided the grant shall be subject to the provisions of the said Code and rules there under.

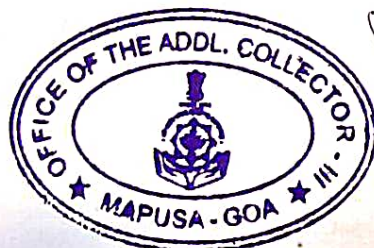

Cont..2/

...2...
APPENDIX - I

Length and Breadth		Total Superficial Area	Forming (part of) Survey No. or Hissa No.	BOUNDARIES				
North to South	East to West			North	South	East	West	
1	2	3	4	5				
19.50 mts	13.00 mts	225 Sq.mts	S.No. 205/27	S.No. 205/24	S.No. 205/28	S.No. 205/22, 23	S.No. 205/24, 26	NIL
75.75 mts	10.50 mts	935 Sq.mts	S.No. 205/25 (Part)	S.No. 205/25	S.No. 205/24	S.No. 205/17, 18, 19, 20, 21 & 22	S.No. 205/8, 24	NIL
Total Area 1160 Sq Mts								
Village PARRA Taluka : BARDEZ								

Remarks :-

1. The applicant has paid conversion fees of Rs.87,000/- (Rupees Eighty Seven Thousands Only) vide e-challan No.202100558723 dated 23/06/2021.
2. The Conversion has been recommended by the Mamlatdar of Bardez Taluka vide his report No. MAM BAR CI-I/Conv/2021/1718 dated 26/03/2021.
3. As per NGPDA Certificate No. NGPDA/Tech0Gen/Par/3056/2021 dated 03/03/2021 the plot fall in settlement Zone with FAR-60.
4. The Survey Nos. 205/27 & 25 (Part) of Parra Village is not included in the Private Forest identified by Sawant, Karapurkar and Thomas Committee.
5. This Sanad is issued for conversion of an area for Residential purpose only . The development/construction in the plot shall be governed as per laws/rules in force.
6. Traditional access, passing through the plot, if any shall be maintained.
7. Mundkarial rights and Mundkarial area should not be disturbed and should be protected if any.

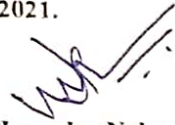

In witness whereof the ADDITIONAL COLLECTOR III OF NORTH GOA District, has hereunto set his hand and the seal of this Office on behalf of the Governor of Goa and by Leander Nehru Alvares H. No 492, Silvawaddo, Parra, Bardez-Goa, here also hereunto set his/ her hand on this 29th day of June 2021.

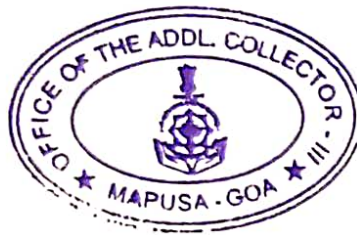
Leander Nehru Alvares
Applicant

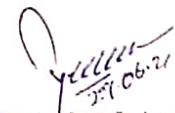

(Mahadev J. Araundekar)
Additional Collector III
North Goa District,
Mapusa-Goa

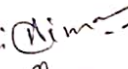

Name and Signature of Witnesses

1. Adv. Humeraiman Mansur Ali 
2. Pranay. P. Chodankar 

Complete address of Witnesses

1. H.No. 93/D, Angad waddo, Mapusa.
2. H.No: 46/Acoi Karanvade Mapusa

We declare that Leander Nehru Alvares H. No. 492, Silvawaddo, Parra, Bardez-Goa, who has signed this Sanad is, to our personal knowledge, the person he/She represents themselves to be, and that he/She has affixed his/her signature hereto in our presence.

1. Adv. Humeraiman Mansur Ali 
2. Pranay. P. Chodankar 

To.

1. The Town Planner, Town and Country Planning Department Mapusa-Goa
2. The Mamlatdar of Bardez Taluka.
3. The Inspector of Survey and Land Records, Mapusa - Goa
4. The Sarpanch village Panchayat, Parra, Bardez-Goa.



GOVERNMENT OF GOA
 Directorate of Settlement and Land Records
 Inspector of surveys & land records.
 MAPUSA - GOA

PLAN

OF THE LAND BEARING SUB-DIV. No. 25(PART) & 27 OF SURVEY No. 205 SITUATED AT PARRA VILLAGE OF BARDEZ TALUKA APPLIED BY LEANDER NEHRU ALVARES CONVERSION OF USE OF LAND FROM AGRICULTURAL INTO NON- AGRICULTURAL PURPOSE, VIDE CASE NO. 4/67/CNV/AC-III/2021/583 DATED 07-05-2021 FROM THE OFFICE OF THE ADDITIONAL COLLECTOR -III, MAPUSA - BARDEZ GOA.



SCALE : 1:1000

	AREA PROPOSED FOR CONVERSION IN S.No. 205/27	225 Sq. Mts.
	AREA PROPOSED FOR CONVERSION IN S.No. 205/25(PART)	935 Sq. Mts.
TOTAL AREA		1160 Sq. Mts.

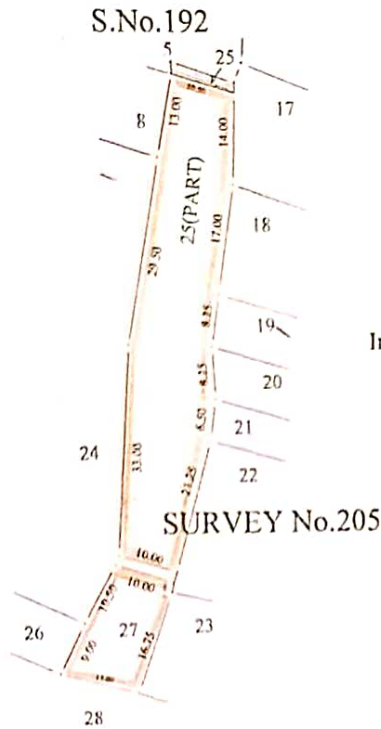

(RAJESH R. PAIKUCHI-KAR)
 Inspector of Surveys And Land Records
 City Survey, Mapusa



PREPARED BY

Raju A. Shetye

RAJU A. SHETYE
 Field Surveyor

VERIFIED BY:

Yogesh Mashelkar

ADDITIONAL COLLECTOR - III YOGESH MASHELKAR
 North Goa District, Head Surveyor
 Mapusa - Goa

SURVEYED ON: 07/06/2021

FILE NO: 8/CNV/MAP/188/2021