

No. 9-02(75)-DSLRL-14/3399

Government of Goa,
Directorate of Settlement &
Land Records, Panaji-Goa.
Dated: - 12th March, 2014.

CERTIFICATE

This is to certify that the Lote Reservado no. of **Comunidade of Sancoale** of **Mormugao** Taluka corresponds to new Survey number of **Sancoale** Village of **Mormugao** Taluka as shown below:

| Sr.no | Lote Reservado No. | Corresponding new Survey No. |
|-------|--|---|
| 1. | XXIV (PART) of Comunidade of Sancoale of Mormugao Taluka | S. No. 198/1 (PART) S. No. 197/1 (PART) of Sancoale of Mormugao Taluka |

The corresponding New Survey no. with respect to the old cadastral no. is determined by superimposing new survey map on old cadastral map and do not involve any field work. As such the verification of corresponding new Survey no. may differ on ground.

This certificate is issued at the written request of **Deliala Fernandes, R/o 801, Anand Square B, Near Sanjeevani Hospital, Baina, Vasco-da-Gama**, for personal record & use.



(A. S. Talaulikar)
Supdt. of Survey & Land Records
Panaji – Goa.

Scale: - 1:4000
 Lote Reservado No: - XXIV (Part)

14340

PLANTA



DO LOTE RESERVADO Nº 66, RESERVA
 PARA PASTAGEM, OITEIRO QUE FICA AC
 ENTE DE GADGALATE LÍMITES DE DA
 LIM, PERTENCENTE À COMUNIDADE DE
 SANCOALE DO CONCELHO DE MORMUGÃO
 E SITONA MESMA ALDEIA E BEM ASSIM
 DO LOTE RESERVADO Nº XXIV

Amimaya
 14/2/14
 Settlement Office:
 Panaji

ESCALA DE $\frac{1}{4000}$ OU 0,001 POR 4,0

| | | |
|--------------|-----------|-------------|
| L.R. Nº LXVI | AREA | 133,4578 |
| | PERIMETRO | 5785,85 NM. |
| L.R. Nº XXIV | AREA | 27,4554 |
| | PERIMETRO | 2808,45 |

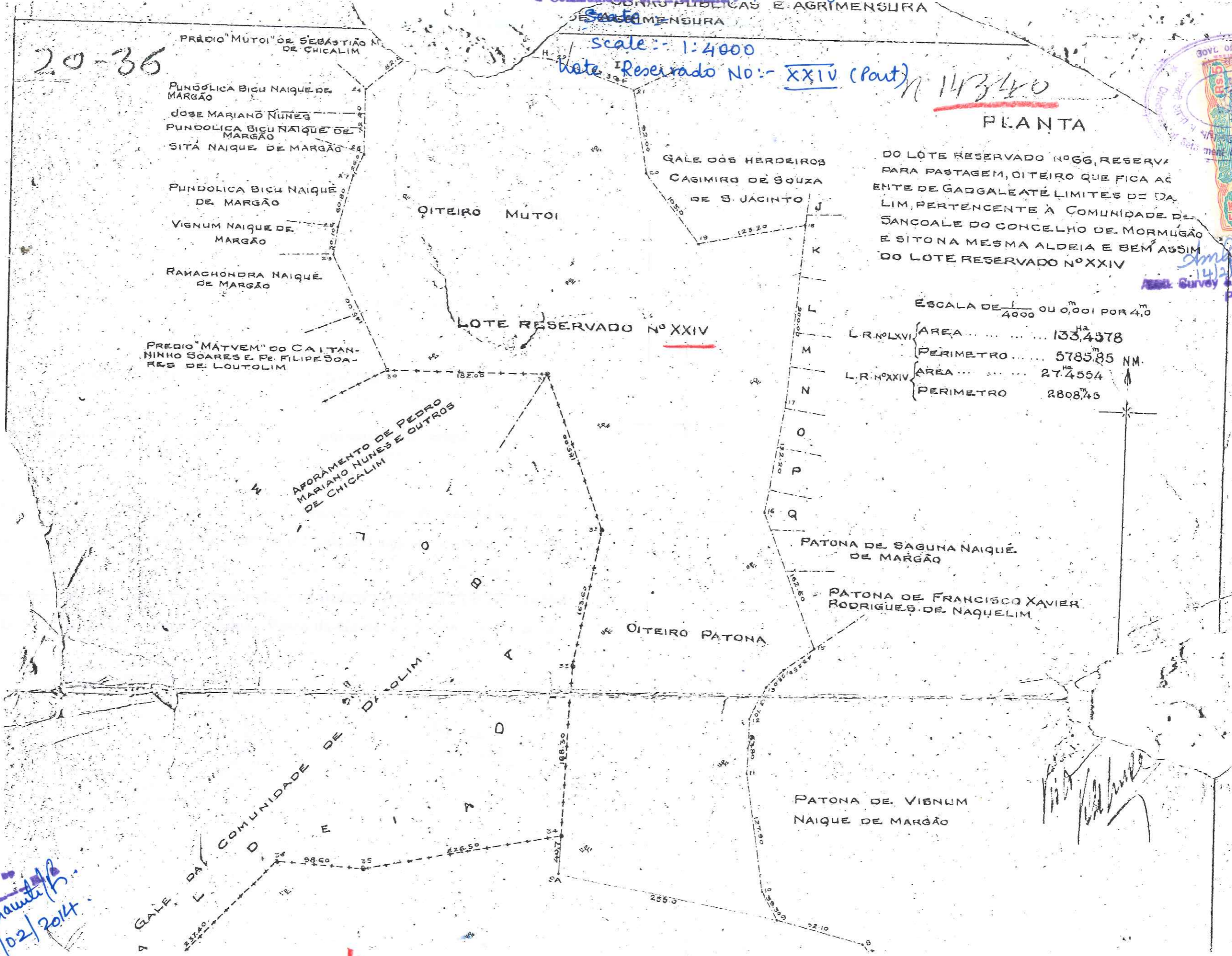

20-36

Compared by
A.A. Khawate
 13/02/2014