

APPLIED FOR RERA REGISTRATION FOR THE PROJECT "IMPERIAL GOA PHASE 1" SEPARATELY.

PLOT AREA  
24,019.00 SQ.MTRS

IMPERIAL GOA PHASE 2  
APPLIED FOR RERA REGISTRATION

PHASE - 1

OS-04  
5548

OS-02  
1622

CLUB HOUSE  
(1717 Sq mtrs)

OS-03  
(3292 Sq mtrs)

OS-01  
(85C  
Sq mtrs)

157  
PUBLIC  
UTILITY  
229

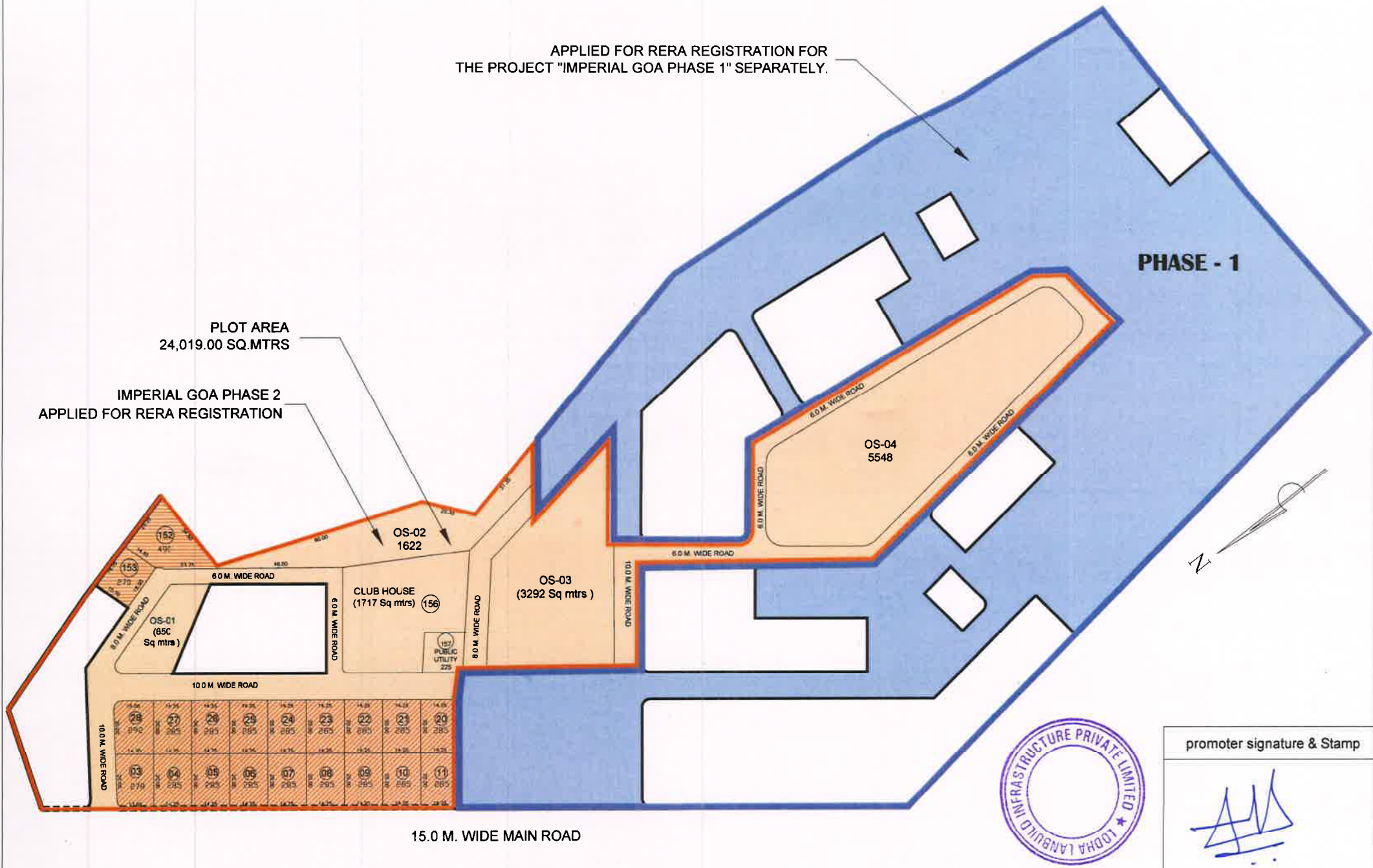
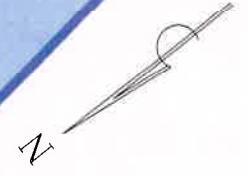

15.0 M. WIDE MAIN ROAD



promoter signature & Stamp

SUB-DIVISION OF PLOTTING A PROJECT "IMPERIAL GOA PHASE 2" BEING DEVELOPED BY LODHA LANDBUILD INFRASTRUCTURE PRIVATE LIMITED ON S. NO. 20/1A, OF BAINGUINIM VILLAGE TALUKA TISWADI, DISTRICT NORTH GOA, GOA, PIN CODE-----