

Completed Building - G
 Completion certificate no. NGPDA/M/1053/253 / 17 Dated 28 - 04 - 2017
 Plot area belongs to Building - G (School) - 991.00M²

RAJ ENCLAVE (PHASE - 1)
 REGISTERED UNDER GOA RERA
 VIDE REGISTRATION NO. PRGO11190946
 AREA = 9864.86 MF

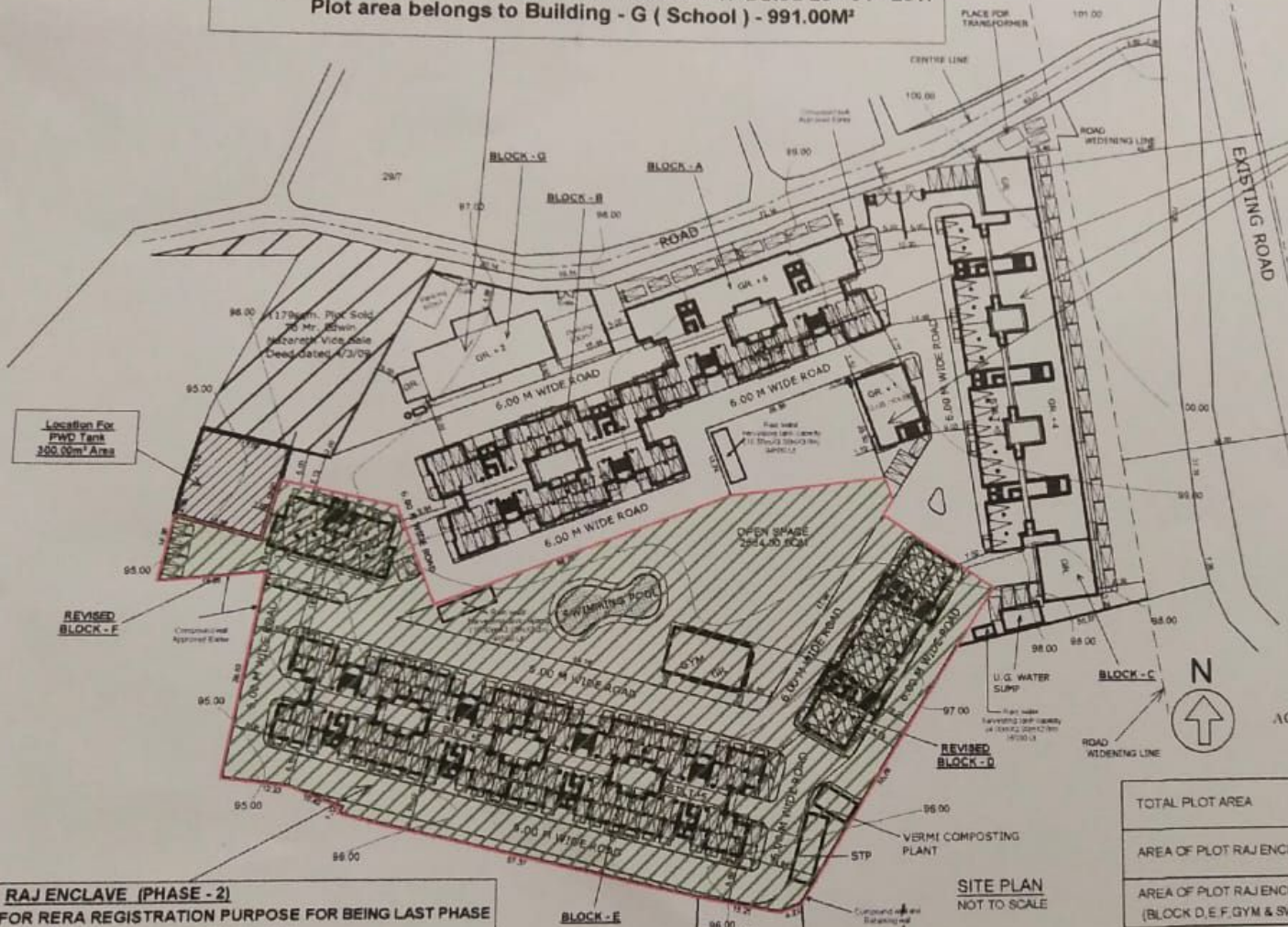

Location For
 PWD Tank
 300.00m² Area

RAJ ENCLAVE (PHASE - 2)
 FOR RERA REGISTRATION PURPOSE FOR BEING LAST PHASE
 (SHARE IN LAND OF BLOCK D, E & F)
 AREA = 7896.14 M²

AREA STATEMENT

TOTAL PLOT AREA	17761.00 Sq.mt
AREA OF PLOT RAJ ENCLAVE (PHASE -1)	(-) 9864.86 Sq.mt
AREA OF PLOT RAJ ENCLAVE (PHASE -2) (BLOCK D, E, F, GYM & SWIMMING POOL)	= 7896.14 Sq.mt

NOTE : THIS PLAN IS ONLY FOR THE PURPOSE OF REGISTRATION OF RAJ ENCLAVE UNDER RERA.

PLAN SHOWING PROPORTINATE OF LAND AREA EXCLUSIVELY FOR RAJ ENCLAVE OF PHASE -2
 (BLOCK - D , BLOCK - E & BLOCK F) OF RESIDENTIAL BUILDINGS ON THE PLOT BEARING PT.S.
 B, CHALTA NO 1 SITUATED AT MAPUSA CITY OF BARDEZ TALUKA.

OWNERS
 OFFICE : 401
 Rajdeep Galleria
 Sadar, Ponda-Goa
 403 401

ARCHITECT
 AR. SIDDHARTH D. NAIK
 201 - A, MATHIAS PLAZA
 PANAJI - GOA 403 001
 REG. NO : AR/0027/2010
 COA NO :CA/97 / 21749

M/S ULYSIS
 # 201 - A, SECOND FLOOR, MATHIAS PLAZA
 PANAJIM - GOA 403001
 PH. - 91 832 2421950