

Approved from Planning Point  
 Subject to Conditions laid down in  
 office order no. P.D.A./G.A./E.O/107-08/2007/759 dated 07/10/07

Assistant Engineer  
 SDI, Div V (Bldgs. North) P.W.D.  
 Panaji - Goa.

APPROVED FROM PLANNING POINT  
 SUBJECT TO CONDITIONS GIVEN  
 VIDE ORDER No. NG PDA/ 755/1705/07  
 DATED

5 OCT 2007

MEMBER SECRETARY  
 NORTH GOA  
 PLANNING & DEV. AUTHORITY  
 PANJIM - GOA

8

AREA STATEMENT

1. AREA OF PLOT M-9 = 576 m<sup>2</sup>
2. AREA OF PLOT M-10 = 397 m<sup>2</sup>
3. AREA OF PLOTS  
 M9, MID AFTER  
 AMALGAMATION = 953 m<sup>2</sup>.

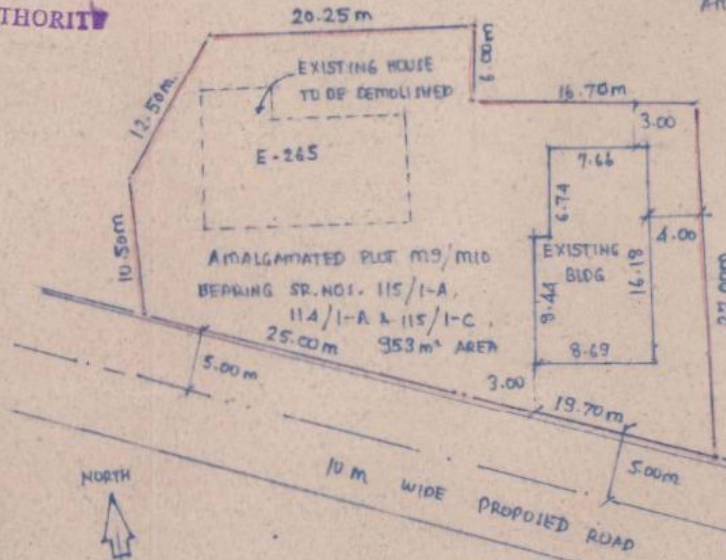
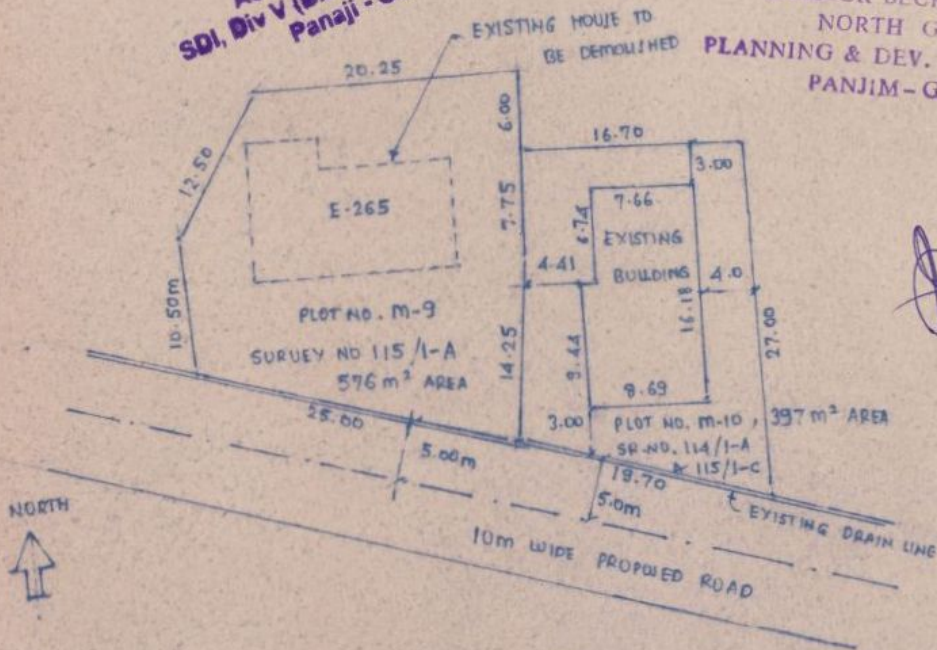

APPROVED FROM ELECTRICAL POINT  
 SUBJECT TO CONDITIONS LAIN  
 STIPULATED IN LETTER  
 No. AE-IT (M) P.N.I. TECH/48

Assistant Engineer  
 Elect. Sub. Div  
 Panaji - Goa

PLAN SHOWING PLOT FORMED

PLAN OF PLOTS M-9 & M-10  
 PRIOR TO AMALGAMATION

SCALE 1:500

Is issued subject to the  
 conditions laid down in the  
 office order No. P.D.A./G.A./E.O/107-08/2007/759  
 Dated: 28-11-07

Health Officer  
 Urban Health Centre Panaji

BY AMALGATION OF PLOT NOS. M-9 & M-10  
 No. 811389

SCALE 1:500

Passed and approved in V.P.  
 meeting held on 14/12/07  
 under resolution No. 261 subject to  
 conditions as per permission  
 No. VP/16/cont-6/96/07-08/1792  
 29-12-07



Secretary  
 Village Panchayat of Taleigao

PROPOSED AMALGAMATION OF PLOT NOS. M-9 & M-10 BEARING SURVEY NOS.  
 115/1-A, 114/1-A, 115/1-C OF TALEIGAO VILLAGE, TISWADI, GOA

OWNER  
 1. *[Signature]*  
 2. *[Signature]*

ARCHT. ENGR.  
 M. Saleem Shah & Associates  
 Architects & Engineers  
 PPDA/ENG/30