

AREA STATEMENT		
a	TOTAL PLOT AREA	2400.00 m ²
b	AREA UNDER ROAD WIDENING	360.00 m ²
c	NET PLOT AREA	2040.00 m ²
d	PERMISSIBLE COVERED AREA (c x 40%)	816.00 m ²
e	PERMISSIBLE F.A.R (a x 1.00)	2400.00 m ²
f	EXISTING BUILDING TO BE DEMOLISH	88.70 m ²
g	PROPOSED COVERED AREA	815.30 m ²
h	PROPOSED COVERAGE (g/c)	39.96 %
i	PROPOSED F.A.R	2397.50 m ²
j	F.A.R CONSUMED (i/a)	0.99

AREA CALCULATION :-

FLOORS	TOTAL B.U.A (sq.m.)	AREA STATEMENT FOR FREE OF F.A.R.				GROSS F.A.R (sq.m.)	LES ADDIT F.A.R
		STAIRS/LIFT (sq.m.)	BALCONY (sq.m.)	TERRACE (sq.m.)	PARKING (sq.m.)		
BASEMENT FLOOR	595.70	18.60	---	---	569.70	7.40	4
GROUND FLOOR	815.30	30.80	---	---	477.30	307.20	4
1st FLOOR	939.70	30.80	237.10	7.30	---	664.50	30
2nd FLOOR	932.40	30.80	237.10	---	---	664.50	30
3rd FLOOR	932.40	30.80	237.10	---	---	664.50	30
4th FLOOR	487.50	30.80	57.10	191.40	---	208.20	20
TOTAL	4703.00	172.60	768.40	198.70	1047.00	2516.30	118

PARKING STATEMENT :-
COMMERCIAL = 303.0/50 = 7cars
TOTAL FLATS = 32 nos = 32 cars
REQUIRED PARKING = 7 + 32 = 39 cars
PARKING PROVIDED = 39 + 7 = 46 cars

Approved with Conditions
 Vide Letter
 No. DD/2180/BICH/TCP-1
 Dt. 30/03/2015
[Signature]
 Deputy Town Planner
 Town & Country Planning Dept.
 Bicholim - Goa *[Signature]*

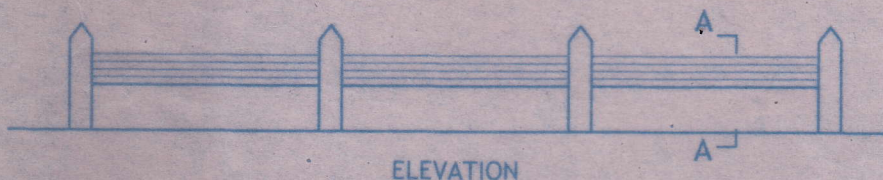

ELEVATION

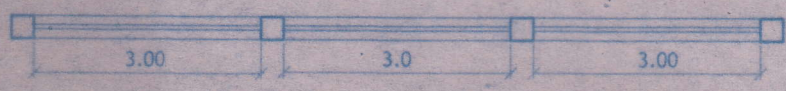

PLAN

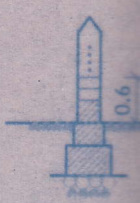

SECTION A

COMPOUND

Scale-1:

Approved with condition
 Vide letter No.
 Dated

DWG NO - 1/4

Approved with condition:
 Vide No. AE/SD-III(O&M)/Tech-4(NOC)
 127/ Dtd. 15/05/2015

Walele
HEALTH OFFICER
 Community Health Centre
 Valpoi Sattari

City
ASSISTANT ENGINEER
 Div VI Works Div X
 (PHE) P.W.D.
 VALPOI GOA

[Signature]
Assistant Engineer
 Elect. Sub Div - III
 Valpoi - Goa.

City
ASSISTANT ENGINEER
 SD- III W.D-XXIV (PHE)
 P.W.D., VALPOI, SATTARI GOA

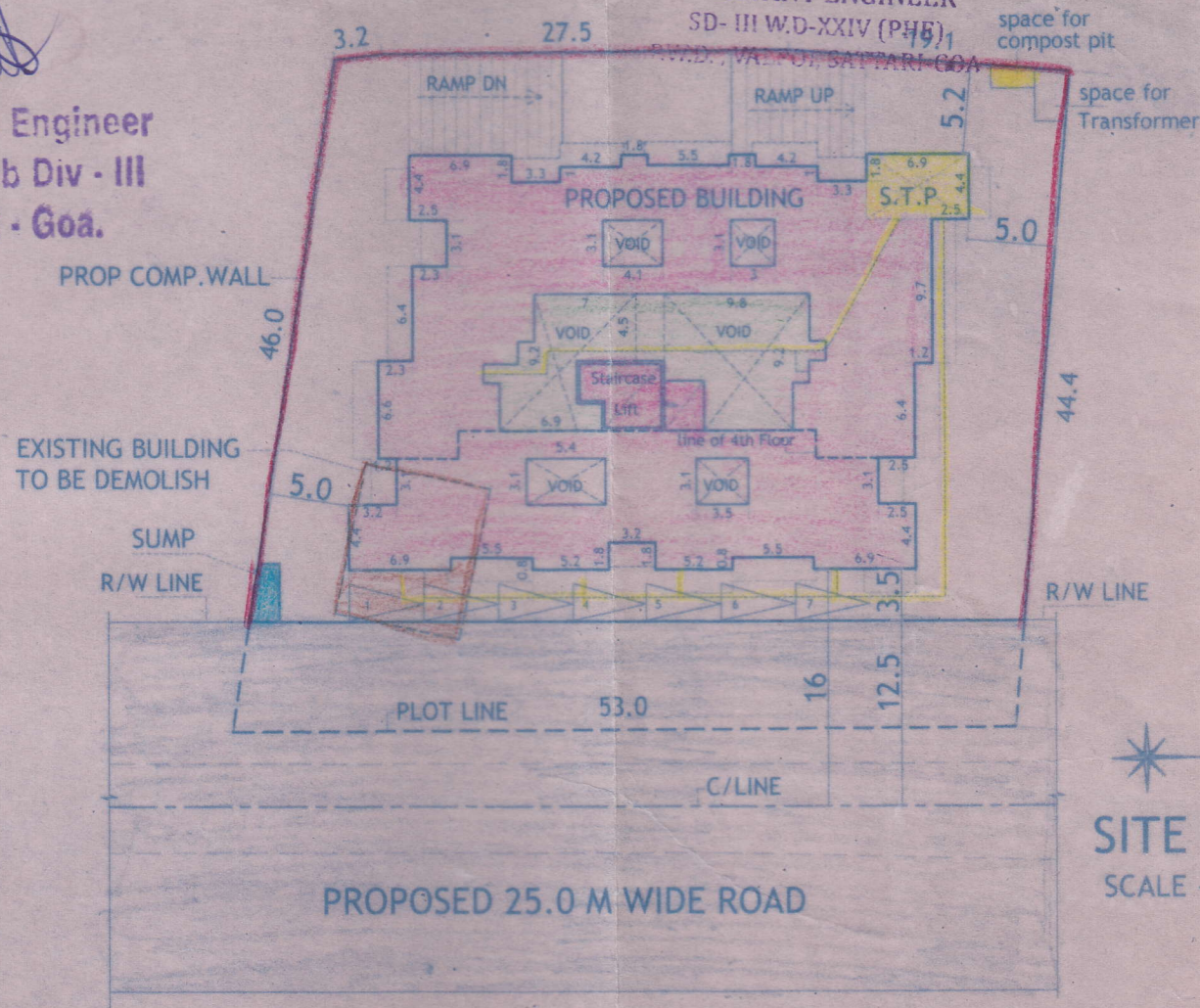

N
SITE PLAN
 SCALE - 1:500

NET F.A.R (sq.m.)	3.20
	303.00
	634.50
	634.50
	634.50
	187.80
	2397.50

Approved only construction up to 01/2015-16 dated 10/05/15 as per the condition.

CHIEF OFFICER
 VALPOI MUNICIPAL COUNCIL
 VALPOI GOA

MUNICIPAL ENGINEER
 VALPOI MUNICIPAL COUNCIL
 VALPOI GOA

PROJECT:
 PROPOSED CONSTRUCTION ON PLOT BEARING, SY.NO/Sub Div No-22/4, SITUATED AT NANUS VILLAGE, SATTARI TALUKA, GOA.

OWNER:
MR. NAZIR KHAN

ARCHITECT'S SIGNATURE:
[Signature]
Bryan J. Soares
 Reg. No. CA/89/12085
 AR/0031/2010

CLIENT'S SIGNATURE:
[Signature]

DRN BY: S.A
CHKD BY: B.S
JOB NO: 594/14
DATED: 02.07.14

DRGS:
 SITE PLAN, COMP WALL
 AREA STATEMENT
 SCALE - 1:100, 1:500

ARCHITECTS:
SOARES & ASSOCIATES
 G-1, VIKAS BUILDING,
 18TH JUNE ROAD,
 PANJIM, GOA.
 PH./FAX: 2228040, 2430010
 e-mail: soares88@gmail.com

AREA STATEMENT		
A	TOTAL PLOT AREA	2400.00 m ²
B	AREA UNDER ROAD WIDENING	360.00 m ²
C	NET PLOT AREA	2040.00 m ²
D	PERMISSIBLE COVERED AREA (C x 40%)	816.00 m ²
E	PERMISSIBLE F.A.R (A x 1.00)	2400.00 m ²
F	EXISTING BUILDING TO BE DEMOLISH	88.70 m ²
G	PROPOSED COVERED AREA	815.30 m ²
H	PROPOSED COVERAGE (G/C)	39.96 %
I	PROPOSED F.A.R	2397.50 m ²
J	F.A.R CONSUMED (I/G)	0.99

NOTION :

TOTAL B.U.A (sq.m.)	AREA STATEMENT FOR FREE OF F.A.R			GROSS F.A.R (sq.m.)	LESS ADDITIONAL F.A.R 7.5%	NET F.A.R (sq.m.)
	STAIRS/LIFT (sq.m.)	BALCONY (sq.m.)	TERFACE/PARKING (sq.m.)			
595.70	19.65	-	569.79	7.40	4.20	1.20
816.30	30.80	-	477.30	307.30	4.20	303.00
939.70	30.80	237.10	7.30	64.50	20.00	44.50
932.40	30.80	237.10	-	64.50	30.00	34.50
487.50	30.80	237.10	-	64.50	30.00	34.50
703.00	173.60	764.40	194.70	1047.00	1310.30	118.80

EXISTENT :
 102.0' x 70.0'
 11.000' x 37.000'
 100.0' x 7.0' x 39.000'
 100.0' x 7.0' x 46.000'

Approved with Conditions
 No. DD/2180/B/C/HT (P/S) 490
 Dt. 30/03/2015
 Deputy Town Planner
 Town & Country Planning Dept.,
 Bicholim - Goa

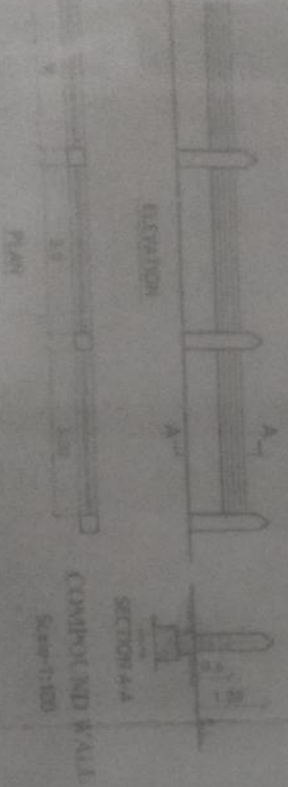

Assistant Engineer
 Elect. Sub Div - III
 Vaipol - Goa.



PROPOSED CONSTRUCTION ON PLOT BEARING, SV NO/SUB DIV NO-22/4, SITUATED AT NANUS VILLAGE, SATARI TALUKA, GOA

OWNER
MR. NAZIR KHAN

PROJECT
 PROPOSED CONSTRUCTION ON PLOT BEARING, SV NO/SUB DIV NO-22/4, SITUATED AT NANUS VILLAGE, SATARI TALUKA, GOA

DESIGN
 SITE PLAN, COMP WALL
 AREA STATEMENT

DATE: 05-07-14 SCALE: 1:100 1:500

CHIEF OFFICER
 MUNICIPAL COUNCIL, BICHOLIM
 Bicholim - Goa

By **Bryan J. Soares**
 Reg. No. CN/89/12/015
 AR/003/12/010

ARCHITECTS
SOARES & ASSOCIATES
 041-9044 848100
 10TH FLOOR, GOA
 PASEM, GOA
 PASEM, GOA
 PASEM, GOA