

AREA CALCULATION---BUILDING "A"

Development Permission No. 2147/2014-25  
 Subject to the conditions of the plan  
 Date: 18.10.2014

CHIEF OFFICER,  
 MARGAO MUNICIPAL COUNCIL

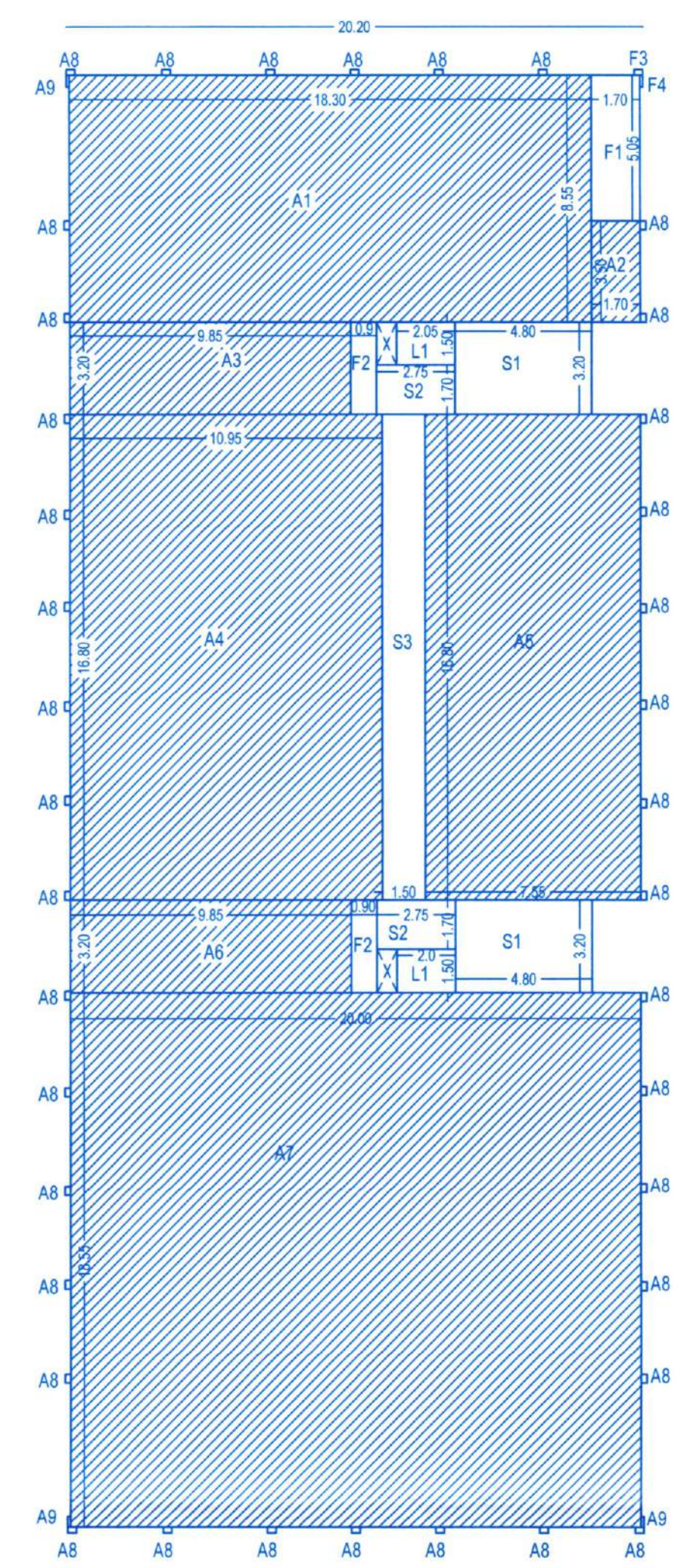

**FAR**

A1 =18.30X8.55 =156.47 M<sup>2</sup>  
 A2 =1.70X3.50 =5.95M<sup>2</sup>  
 A3 =9.85X3.20 =31.52M<sup>2</sup>  
 A4 =10.95X16.80 =183.96M<sup>2</sup>  
 A5 =7.55X16.80 =126.84M<sup>2</sup>  
 A6 =9.85X3.20 =31.52M<sup>2</sup>  
 A7 =20.00X18.55 =371.00M<sup>2</sup>  
 39A8 =39.00X20.30 =792.30M<sup>2</sup>  
 39A9 =30.10X10.40 =313.04M<sup>2</sup>

**TOTAL** =909.72M<sup>2</sup>

**STAIRCASE**

S1 =2X4.80X3.20 =30.72M<sup>2</sup>  
 S2 =2X2.75X1.70 =9.35M<sup>2</sup>  
 S3 =1.50X16.80 =25.20M<sup>2</sup>

**TOTAL** =65.27M<sup>2</sup>

**LIFT**

L1 =2X2.05X1.50 =6.15M<sup>2</sup>  
**TOTAL** =6.15M<sup>2</sup>

**FOYER**

F1 =1.70X5.05 =8.59M<sup>2</sup>  
 F2 =2X0.90X3.20 =5.76M<sup>2</sup>  
 F3 =0.30X3.20 =0.96M<sup>2</sup>  
 F4 =0.10X3.20 =0.32M<sup>2</sup>

**TOTAL** =14.45M<sup>2</sup>

**COVERED AREA** =FAR+STAIRCASE+LIFT+FOYER  
 =909.72+65.27+6.15+14.45  
 =995.59M<sup>2</sup>

**TOTAL BUILT UP AREA** =FAR+STAIRCASE+LIFT+FOYER  
 =909.72+65.27+6.15+14.45  
 =995.59M<sup>2</sup>

GROUND FLOOR PLAN

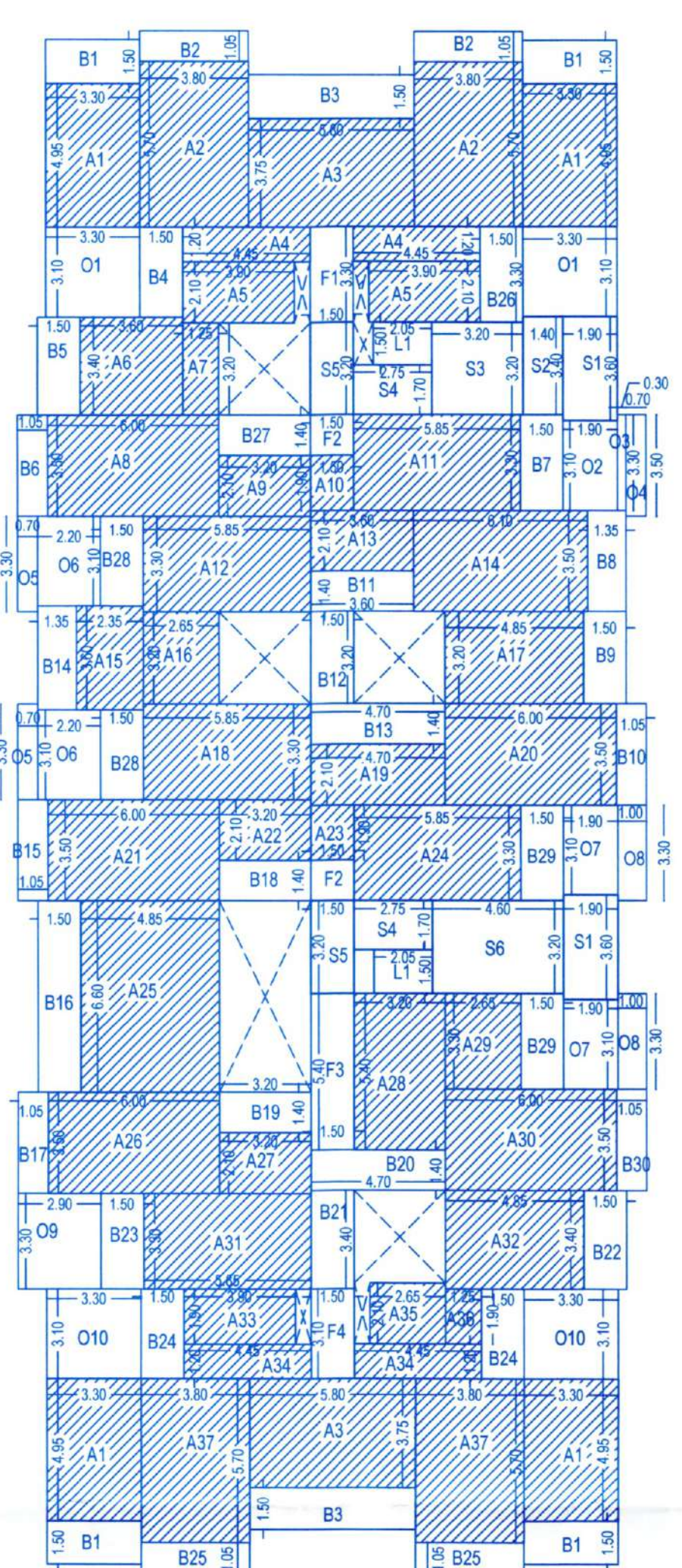

**FAR**

4A1 =4X3.30X4.95 =65.34M<sup>2</sup>  
 2A2 =2X3.80X5.70 =43.32M<sup>2</sup>  
 2A3 =2X5.80X3.75 =43.50M<sup>2</sup>  
 2A4 =2X4.45X1.20 =10.68M<sup>2</sup>  
 2A5 =2X3.90X2.10 =16.38M<sup>2</sup>  
 A6 =3.60X3.40 =12.24M<sup>2</sup>  
 A7 =1.25X3.20 =4.00M<sup>2</sup>  
 A8 =6.00X3.50 =21.00M<sup>2</sup>  
 A9 =3.20X2.10 =6.72M<sup>2</sup>  
 A10 =1.50X1.90 =2.85M<sup>2</sup>  
 A11 =5.85X3.30 =19.31M<sup>2</sup>  
 A12 =5.85X3.30 =19.31M<sup>2</sup>  
 A13 =3.60X2.10 =7.56M<sup>2</sup>  
 A14 =6.10X3.50 =21.35M<sup>2</sup>  
 A15 =2.35X3.60 =8.46M<sup>2</sup>  
 A16 =2.65X3.20 =8.48M<sup>2</sup>  
 A17 =4.85X3.20 =15.52M<sup>2</sup>  
 A18 =5.85X3.30 =19.31M<sup>2</sup>  
 A19 =4.70X2.10 =9.87M<sup>2</sup>  
 A20 =6.00X3.50 =21.00M<sup>2</sup>  
 A21 =6.00X3.50 =21.00M<sup>2</sup>  
 A22 =3.20X2.10 =6.72M<sup>2</sup>  
 A23 =1.50X1.90 =2.85M<sup>2</sup>  
 A24 =5.85X3.30 =19.31M<sup>2</sup>  
 A25 =4.85X6.60 =32.01M<sup>2</sup>  
 A26 =6.00X3.50 =21.00M<sup>2</sup>  
 A27 =3.20X2.10 =6.72M<sup>2</sup>  
 A28 =3.20X5.40 =17.28M<sup>2</sup>  
 A29 =2.65X3.30 =8.75M<sup>2</sup>  
 A30 =6.00X3.50 =21.00M<sup>2</sup>  
 A31 =5.85X3.30 =19.31M<sup>2</sup>  
 A32 =4.85X3.40 =16.49M<sup>2</sup>  
 A33 =3.90X1.90 =7.41M<sup>2</sup>  
 2A34 =2X4.45X1.20 =10.68M<sup>2</sup>  
 A35 =2.65X2.10 =5.57M<sup>2</sup>  
 A36 =1.25X1.90 =2.38M<sup>2</sup>  
 2A37 =2X3.80X5.70 =43.32M<sup>2</sup>

**TOTAL** =638.00M<sup>2</sup>

**STAIRCASE**

S1 =2X1.90X3.60 =13.68M<sup>2</sup>  
 S2 =1.40X3.40 =4.76M<sup>2</sup>  
 S3 =3.20X3.20 =10.24M<sup>2</sup>  
 S4 =2X2.75X1.70 =9.35M<sup>2</sup>  
 S5 =2X1.50X3.20 =9.60M<sup>2</sup>  
 S6 =4.60X3.20 =14.72M<sup>2</sup>

**TOTAL** =62.35M<sup>2</sup>

**LIFT**

L1 =2X2.05X1.50 =6.15M<sup>2</sup>  
**TOTAL** =6.15M<sup>2</sup>

FIRST FLOOR PLAN

**TOTAL BUILT UP AREA** =FAR+STAIRCASE+LIFT+FOYER  
 =638.00+62.35+6.15+19.59+21.90  
 =923.99M<sup>2</sup>

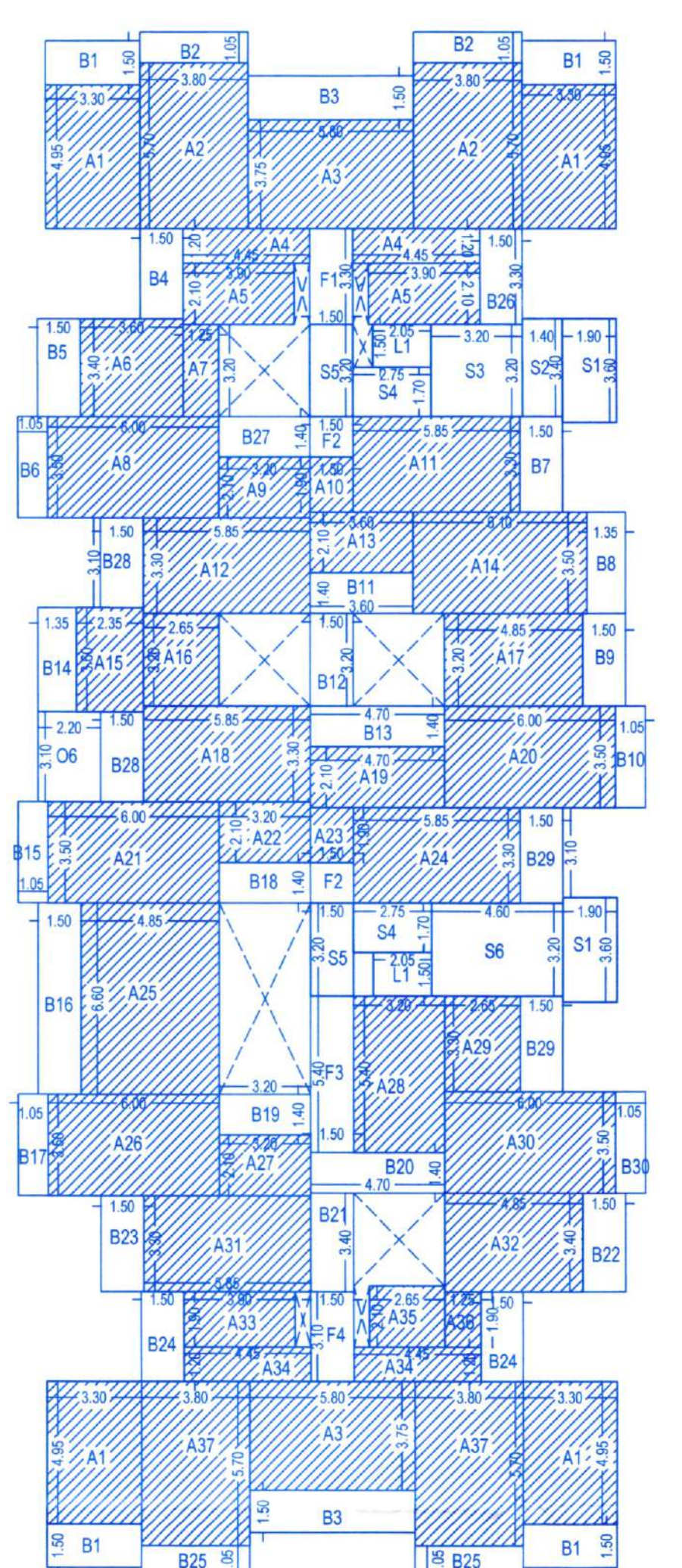

**FAR**

4A1 =4X3.30X4.95 =65.34M<sup>2</sup>  
 2A2 =2X3.80X5.70 =43.32M<sup>2</sup>  
 2A3 =2X5.80X3.75 =43.50M<sup>2</sup>  
 2A4 =2X4.45X1.20 =10.68M<sup>2</sup>  
 2A5 =2X3.90X2.10 =16.38M<sup>2</sup>  
 A6 =3.60X3.40 =12.24M<sup>2</sup>  
 A7 =1.25X3.20 =4.00M<sup>2</sup>  
 A8 =6.00X3.50 =21.00M<sup>2</sup>  
 A9 =3.20X2.10 =6.72M<sup>2</sup>  
 A10 =1.50X1.90 =2.85M<sup>2</sup>  
 A11 =5.85X3.30 =19.31M<sup>2</sup>  
 A12 =5.85X3.30 =19.31M<sup>2</sup>  
 A13 =3.60X2.10 =7.56M<sup>2</sup>  
 A14 =6.10X3.50 =21.35M<sup>2</sup>  
 A15 =2.35X3.60 =8.46M<sup>2</sup>  
 A16 =2.65X3.20 =8.48M<sup>2</sup>  
 A17 =4.85X3.20 =15.52M<sup>2</sup>  
 A18 =5.85X3.30 =19.31M<sup>2</sup>  
 A19 =4.70X2.10 =9.87M<sup>2</sup>  
 A20 =6.00X3.50 =21.00M<sup>2</sup>  
 A21 =6.00X3.50 =21.00M<sup>2</sup>  
 A22 =3.20X2.10 =6.72M<sup>2</sup>  
 A23 =1.50X1.90 =2.85M<sup>2</sup>  
 A24 =5.85X3.30 =19.31M<sup>2</sup>  
 A25 =4.85X6.60 =32.01M<sup>2</sup>  
 A26 =6.00X3.50 =21.00M<sup>2</sup>  
 A27 =3.20X2.10 =6.72M<sup>2</sup>  
 A28 =3.20X5.40 =17.28M<sup>2</sup>  
 A29 =2.65X3.30 =8.75M<sup>2</sup>  
 A30 =6.00X3.50 =21.00M<sup>2</sup>  
 A31 =5.85X3.30 =19.31M<sup>2</sup>  
 A32 =4.85X3.40 =16.49M<sup>2</sup>  
 A33 =3.90X1.90 =7.41M<sup>2</sup>  
 2A34 =2X4.45X1.20 =10.68M<sup>2</sup>  
 A35 =2.65X2.10 =5.57M<sup>2</sup>  
 A36 =1.25X1.90 =2.38M<sup>2</sup>  
 2A37 =2X3.80X5.70 =43.32M<sup>2</sup>

**TOTAL** =638.00M<sup>2</sup>

**STAIRCASE**

S1 =2X1.90X3.60 =13.68M<sup>2</sup>  
 S2 =1.40X3.40 =4.76M<sup>2</sup>  
 S3 =3.20X3.20 =10.24M<sup>2</sup>  
 S4 =2X2.75X1.70 =9.35M<sup>2</sup>  
 S5 =2X1.50X3.20 =9.60M<sup>2</sup>  
 S6 =4.60X3.20 =14.72M<sup>2</sup>

**TOTAL** =62.35M<sup>2</sup>

**LIFT**

L1 =2X2.05X1.50 =6.15M<sup>2</sup>  
**TOTAL** =6.15M<sup>2</sup>

SECOND & FOURTH FLOOR PLAN

**TOTAL BUILT UP AREA** =FAR+STAIRCASE+LIFT+FOYER  
 =638.00+62.35+6.15+19.59+21.90  
 =923.99M<sup>2</sup>

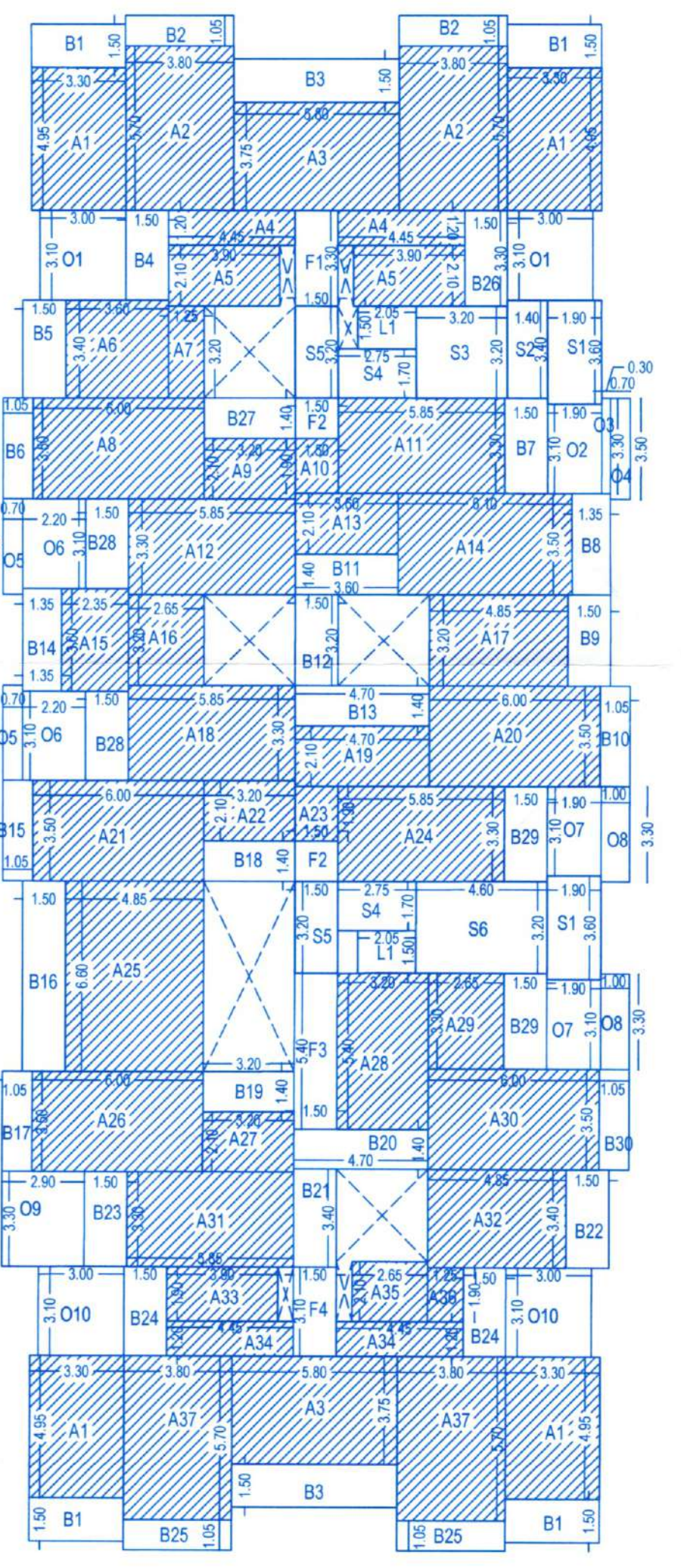

**FAR**

4A1 =4X3.30X4.95 =65.34M<sup>2</sup>  
 2A2 =2X3.80X5.70 =43.32M<sup>2</sup>  
 2A3 =2X5.80X3.75 =43.50M<sup>2</sup>  
 2A4 =2X4.45X1.20 =10.68M<sup>2</sup>  
 2A5 =2X3.90X2.10 =16.38M<sup>2</sup>  
 A6 =3.60X3.40 =12.24M<sup>2</sup>  
 A7 =1.25X3.20 =4.00M<sup>2</sup>  
 A8 =6.00X3.50 =21.00M<sup>2</sup>  
 A9 =3.20X2.10 =6.72M<sup>2</sup>  
 A10 =1.50X1.90 =2.85M<sup>2</sup>  
 A11 =5.85X3.30 =19.31M<sup>2</sup>  
 A12 =5.85X3.30 =19.31M<sup>2</sup>  
 A13 =3.60X2.10 =7.56M<sup>2</sup>  
 A14 =6.10X3.50 =21.35M<sup>2</sup>  
 A15 =2.35X3.60 =8.46M<sup>2</sup>  
 A16 =2.65X3.20 =8.48M<sup>2</sup>  
 A17 =4.85X3.20 =15.52M<sup>2</sup>  
 A18 =5.85X3.30 =19.31M<sup>2</sup>  
 A19 =4.70X2.10 =9.87M<sup>2</sup>  
 A20 =6.00X3.50 =21.00M<sup>2</sup>  
 A21 =6.00X3.50 =21.00M<sup>2</sup>  
 A22 =3.20X2.10 =6.72M<sup>2</sup>  
 A23 =1.50X1.90 =2.85M<sup>2</sup>  
 A24 =5.85X3.30 =19.31M<sup>2</sup>  
 A25 =4.85X6.60 =32.01M<sup>2</sup>  
 A26 =6.00X3.50 =21.00M<sup>2</sup>  
 A27 =3.20X2.10 =6.72M<sup>2</sup>  
 A28 =3.20X5.40 =17.28M<sup>2</sup>  
 A29 =2.65X3.30 =8.75M<sup>2</sup>  
 A30 =6.00X3.50 =21.00M<sup>2</sup>  
 A31 =5.85X3.30 =19.31M<sup>2</sup>  
 A32 =4.85X3.40 =16.49M<sup>2</sup>  
 A33 =3.90X1.90 =7.41M<sup>2</sup>  
 2A34 =2X4.45X1.20 =10.68M<sup>2</sup>  
 A35 =2.65X2.10 =5.57M<sup>2</sup>  
 A36 =1.25X1.90 =2.38M<sup>2</sup>  
 2A37 =2X3.80X5.70 =43.32M<sup>2</sup>

**TOTAL** =638.00M<sup>2</sup>

**STAIRCASE**

S1 =2X1.90X3.60 =13.68M<sup>2</sup>  
 S2 =1.40X3.40 =4.76M<sup>2</sup>  
 S3 =3.20X3.20 =10.24M<sup>2</sup>  
 S4 =2X2.75X1.70 =9.35M<sup>2</sup>  
 S5 =2X1.50X3.20 =9.60M<sup>2</sup>  
 S6 =4.60X3.20 =14.72M<sup>2</sup>

**TOTAL** =62.35M<sup>2</sup>

**LIFT**

L1 =2X2.05X1.50 =6.15M<sup>2</sup>  
**TOTAL** =6.15M<sup>2</sup>

THIRD & FIFTH FLOOR PLAN

**TOTAL BUILT UP AREA** =FAR+STAIRCASE+LIFT+FOYER  
 =638.00+62.35+6.15+19.59+21.90  
 =923.99M<sup>2</sup>

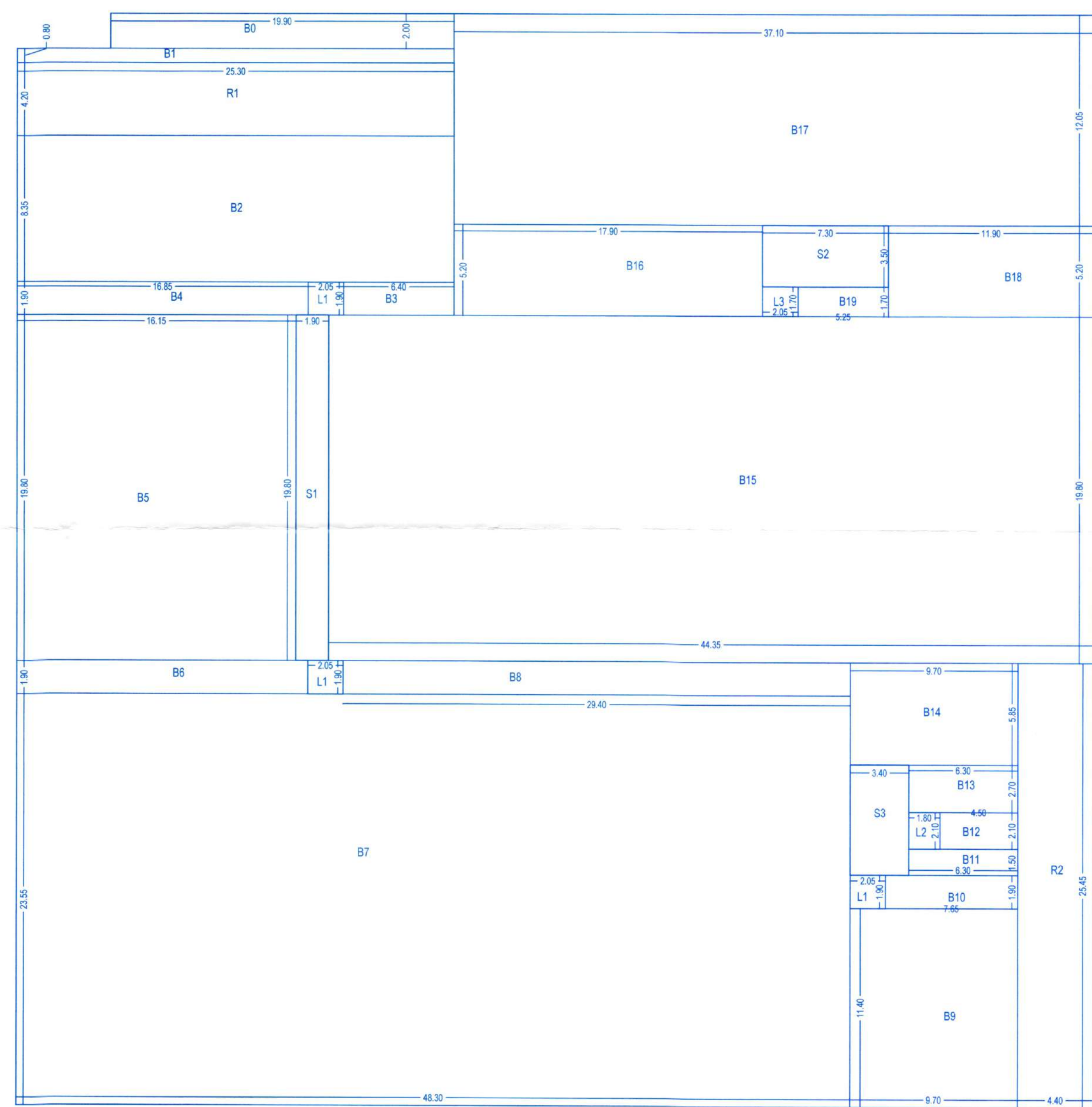

**BASEMENT**

B0 =19.90X2.00 =39.80M<sup>2</sup>  
 B1 =25.30X8.35 =211.26M<sup>2</sup>  
 B2 =25.30X8.35 =211.26M<sup>2</sup>  
 B3 =6.40X1.90 =12.16M<sup>2</sup>  
 B4 =16.85X1.90 =32.02M<sup>2</sup>  
 B5 =16.85X1.90 =32.02M<sup>2</sup>  
 B6 =4.60X3.20 =14.72M<sup>2</sup>  
 B7 =29.40X1.90 =55.86M<sup>2</sup>  
 B8 =5.70X1.40 =7.98M<sup>2</sup>  
 B9 =7.65X1.90 =14.54M<sup>2</sup>  
 B10 =6.30X1.50 =9.45M<sup>2</sup>  
 B11 =4.50X2.10 =9.45M<sup>2</sup>  
 B12 =6.30X2.70 =17.01M<sup>2</sup>  
 B13 =9.70X5.85 =56.75M<sup>2</sup>  
 B14 =44.35X19.80 =878.13M<sup>2</sup>  
 B15 =17.90X5.20 =93.08M<sup>2</sup>  
 B16 =37.10X12.05 =447.06M<sup>2</sup>  
 B17 =11.90X5.20 =61.88M<sup>2</sup>  
 B18 =5.25X1.70 =8.93M<sup>2</sup>  
**TOTAL** =3567.46M<sup>2</sup>

**STAIRCASE**

S1 =1.90X19.80 =37.62M<sup>2</sup>  
 S2 =7.30X3.50 =25.55M<sup>2</sup>  
 S3 =3.40X6.30 =21.42M<sup>2</sup>

**TOTAL** =84.59M<sup>2</sup>

**LIFT**

L1 =3X2.05X1.90 =11.69M<sup>2</sup>  
 L2 =1.80X2.10 =3.78M<sup>2</sup>  
 L3 =2.05X1.70 =3.49M<sup>2</sup>

**TOTAL** =18.96M<sup>2</sup>

**RAMP**

R1 =25.30X4.20 =106.26M<sup>2</sup>  
 R2 =4.40X25.45 =111.98M<sup>2</sup>

**TOTAL** =218.24M<sup>2</sup>

**TOTAL BUILT UP AREA** =BASEMENT+STAIRCASE+LIFT+RAMP  
 =3567.46+84.59+18.96+218.24  
 =3889.25M<sup>2</sup>

BASEMENT PLAN

**SCHEDULE OF OPENINGS**

TYPE	SIZE	TYPE	SIZE
RS1	3.00 X 4.40	SW1	2.20 X 1.50
RS2	2.50 X 4.40	SW2	1.50 X 1.80
FG1	4.65 X 4.40	SW3	0.90 X 1.80
FG2	3.70 X 4.40	KW1	1.00 X 1.30
DD	1.50 X 2.20	KW2	0.90 X 1.30
D1	1.00 X 2.20	KW3	0.80 X 1.30
D2	0.90 X 2.20	V1	0.60 X 1.00
D3	0.75 X 2.20	V2	0.55 X 1.00
KD	0.90 X 2.50	LD	0.80 X 2.20
FD1	3.40 X 2.50	FD	1.00 X 2.20
FD2	3.20 X 2.50	FD6	4.5 X 2.50
FD3	3.10 X 2.50	FD7	7.70 X 2.50
FD4	3.00 X 2.50	FD8	4.30 X 2.50
FD5	2.80 X 2.50	FD9	4.00 X 2.50
		FD10	3.90 X 2.50

ALL BALCONIES TO BE ENCLOSED WITH SLIDING GLASS PANEL SHUTTER WITH PARAPET  
 OWNER : ARP BORDA CONSTRUCTION LLP.  
 PROJECT : "FERREIRA ARCADE"  
 PROPOSED COMMERCIAL AND RESIDENTIAL BUILDINGS AND COMPOUND WALL AT BORDA, MARGAO - GOA  
 DATE: 14/11/22  
 SCALE: 1:100 & 1:500  
 OWNER: UDAY SAWANT ARCHITECTS, ENGINEERS INTERIOR DESIGNERS  
 PROJECT: FERREIRA ARCADE, 1ST FLOOR, MARGAO, MARGAO GOA  
 PHONE NO: 972288  
 REVISION: 12  
 ENGINEER: UDAY SAWANT  
 Reg. No. ER/0022/2010  
 REVISED