

Block 1' completed in all respects with Completion Order No. GPPDA/246-041/22/26/2013 dated 25/11/2013 issued by Metro City Planning and Development Authority & Occupancy Certificate No. YHT/COCC/CP/CE/180/13-01/2109 Series 24/12/13

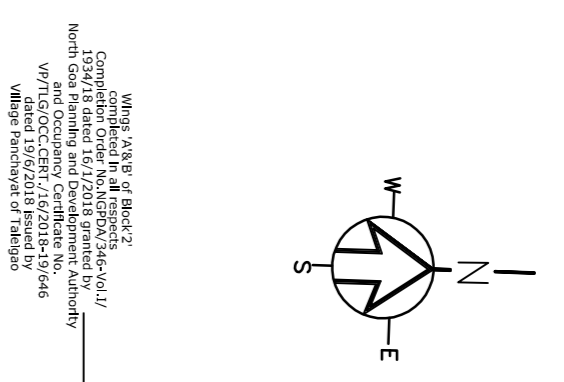

SITE PLAN

AREA STATEMENT

1 TOTAL AREA OF PLOT	54,000.00 SQ.M
2 AREA RESERVED FOR OPEN SPACE	11,850.00 SQ.M
3 AREA RESERVED FOR ROADWAY/DRIVEWAY	11,850.00 SQ.M
4 AREA RESERVED FOR OPEN SPACE	11,850.00 SQ.M
5 EFFECTIVE AREA OF PLOT	29,350.00 SQ.M
6 TOTAL COVERED AREA OF EXISTING BLOCK 1	4,838.82 SQ.M
7 TOTAL COVERED AREA OF EXISTING BLOCK 2	6,333.33 SQ.M
8 TOTAL COVERED AREA OF EXISTING BLOCK 3	6,333.33 SQ.M
9 TOTAL COVERED AREA OF EXISTING BLOCK 4	4,838.82 SQ.M
10 TOTAL COVERED AREA OF EXISTING CLUBHOUSE	1,488.00 SQ.M
11 TOTAL COVERED AREA OF EXISTING VILLAS	1,488.00 SQ.M
12 TOTAL COVERED AREA OF EXISTING VILLAS	1,488.00 SQ.M
13 TOTAL COVERED AREA OF EXISTING VILLAS	1,488.00 SQ.M
14 TOTAL COVERED AREA OF EXISTING VILLAS	1,488.00 SQ.M
15 TOTAL COVERED AREA OF EXISTING VILLAS	1,488.00 SQ.M
16 TOTAL COVERED AREA OF EXISTING VILLAS	1,488.00 SQ.M
17 TOTAL COVERED AREA OF EXISTING VILLAS	1,488.00 SQ.M
18 TOTAL COVERED AREA OF EXISTING VILLAS	1,488.00 SQ.M
19 TOTAL COVERED AREA OF EXISTING VILLAS	1,488.00 SQ.M
20 TOTAL COVERED AREA OF EXISTING VILLAS	1,488.00 SQ.M
21 TOTAL COVERED AREA OF EXISTING VILLAS	1,488.00 SQ.M
22 TOTAL COVERED AREA OF EXISTING VILLAS	1,488.00 SQ.M
23 TOTAL COVERED AREA OF EXISTING VILLAS	1,488.00 SQ.M
24 TOTAL COVERED AREA OF EXISTING VILLAS	1,488.00 SQ.M
25 TOTAL COVERED AREA OF EXISTING VILLAS	1,488.00 SQ.M
26 TOTAL COVERED AREA OF EXISTING VILLAS	1,488.00 SQ.M
27 TOTAL COVERED AREA OF EXISTING VILLAS	1,488.00 SQ.M
28 TOTAL COVERED AREA OF EXISTING VILLAS	1,488.00 SQ.M
29 TOTAL COVERED AREA OF EXISTING VILLAS	1,488.00 SQ.M
30 TOTAL COVERED AREA OF EXISTING VILLAS	1,488.00 SQ.M
31 TOTAL COVERED AREA OF EXISTING VILLAS	1,488.00 SQ.M
32 TOTAL COVERED AREA OF EXISTING VILLAS	1,488.00 SQ.M
33 TOTAL COVERED AREA OF EXISTING VILLAS	1,488.00 SQ.M
34 TOTAL COVERED AREA OF EXISTING VILLAS	1,488.00 SQ.M
35 TOTAL COVERED AREA OF EXISTING VILLAS	1,488.00 SQ.M
36 TOTAL COVERED AREA OF EXISTING VILLAS	1,488.00 SQ.M
37 TOTAL COVERED AREA OF EXISTING VILLAS	1,488.00 SQ.M
38 TOTAL COVERED AREA OF EXISTING VILLAS	1,488.00 SQ.M
39 TOTAL COVERED AREA OF EXISTING VILLAS	1,488.00 SQ.M
40 TOTAL COVERED AREA OF EXISTING VILLAS	1,488.00 SQ.M
41 TOTAL COVERED AREA OF EXISTING VILLAS	1,488.00 SQ.M
42 TOTAL COVERED AREA OF EXISTING VILLAS	1,488.00 SQ.M
43 TOTAL COVERED AREA OF EXISTING VILLAS	1,488.00 SQ.M
44 TOTAL COVERED AREA OF EXISTING VILLAS	1,488.00 SQ.M
45 TOTAL COVERED AREA OF EXISTING VILLAS	1,488.00 SQ.M
46 TOTAL COVERED AREA OF EXISTING VILLAS	1,488.00 SQ.M
47 TOTAL COVERED AREA OF EXISTING VILLAS	1,488.00 SQ.M
48 TOTAL COVERED AREA OF EXISTING VILLAS	1,488.00 SQ.M
49 TOTAL COVERED AREA OF EXISTING VILLAS	1,488.00 SQ.M
50 TOTAL COVERED AREA OF EXISTING VILLAS	1,488.00 SQ.M
51 TOTAL COVERED AREA OF EXISTING VILLAS	1,488.00 SQ.M
52 TOTAL COVERED AREA OF EXISTING VILLAS	1,488.00 SQ.M
53 TOTAL COVERED AREA OF EXISTING VILLAS	1,488.00 SQ.M
54 TOTAL COVERED AREA OF EXISTING VILLAS	1,488.00 SQ.M
55 TOTAL COVERED AREA OF EXISTING VILLAS	1,488.00 SQ.M
56 TOTAL COVERED AREA OF EXISTING VILLAS	1,488.00 SQ.M
57 TOTAL COVERED AREA OF EXISTING VILLAS	1,488.00 SQ.M
58 TOTAL COVERED AREA OF EXISTING VILLAS	1,488.00 SQ.M
59 TOTAL COVERED AREA OF EXISTING VILLAS	1,488.00 SQ.M
60 TOTAL COVERED AREA OF EXISTING VILLAS	1,488.00 SQ.M
61 TOTAL COVERED AREA OF EXISTING VILLAS	1,488.00 SQ.M
62 TOTAL COVERED AREA OF EXISTING VILLAS	1,488.00 SQ.M
63 TOTAL COVERED AREA OF EXISTING VILLAS	1,488.00 SQ.M
64 TOTAL COVERED AREA OF EXISTING VILLAS	1,488.00 SQ.M
65 TOTAL COVERED AREA OF EXISTING VILLAS	1,488.00 SQ.M
66 TOTAL COVERED AREA OF EXISTING VILLAS	1,488.00 SQ.M
67 TOTAL COVERED AREA OF EXISTING VILLAS	1,488.00 SQ.M
68 TOTAL COVERED AREA OF EXISTING VILLAS	1,488.00 SQ.M
69 TOTAL COVERED AREA OF EXISTING VILLAS	1,488.00 SQ.M
70 TOTAL COVERED AREA OF EXISTING VILLAS	1,488.00 SQ.M
71 TOTAL COVERED AREA OF EXISTING VILLAS	1,488.00 SQ.M
72 TOTAL COVERED AREA OF EXISTING VILLAS	1,488.00 SQ.M
73 TOTAL COVERED AREA OF EXISTING VILLAS	1,488.00 SQ.M
74 TOTAL COVERED AREA OF EXISTING VILLAS	1,488.00 SQ.M
75 TOTAL COVERED AREA OF EXISTING VILLAS	1,488.00 SQ.M
76 TOTAL COVERED AREA OF EXISTING VILLAS	1,488.00 SQ.M
77 TOTAL COVERED AREA OF EXISTING VILLAS	1,488.00 SQ.M
78 TOTAL COVERED AREA OF EXISTING VILLAS	1,488.00 SQ.M
79 TOTAL COVERED AREA OF EXISTING VILLAS	1,488.00 SQ.M
80 TOTAL COVERED AREA OF EXISTING VILLAS	1,488.00 SQ.M
81 TOTAL COVERED AREA OF EXISTING VILLAS	1,488.00 SQ.M
82 TOTAL COVERED AREA OF EXISTING VILLAS	1,488.00 SQ.M
83 TOTAL COVERED AREA OF EXISTING VILLAS	1,488.00 SQ.M
84 TOTAL COVERED AREA OF EXISTING VILLAS	1,488.00 SQ.M
85 TOTAL COVERED AREA OF EXISTING VILLAS	1,488.00 SQ.M
86 TOTAL COVERED AREA OF EXISTING VILLAS	1,488.00 SQ.M
87 TOTAL COVERED AREA OF EXISTING VILLAS	1,488.00 SQ.M
88 TOTAL COVERED AREA OF EXISTING VILLAS	1,488.00 SQ.M
89 TOTAL COVERED AREA OF EXISTING VILLAS	1,488.00 SQ.M
90 TOTAL COVERED AREA OF EXISTING VILLAS	1,488.00 SQ.M
91 TOTAL COVERED AREA OF EXISTING VILLAS	1,488.00 SQ.M
92 TOTAL COVERED AREA OF EXISTING VILLAS	1,488.00 SQ.M
93 TOTAL COVERED AREA OF EXISTING VILLAS	1,488.00 SQ.M
94 TOTAL COVERED AREA OF EXISTING VILLAS	1,488.00 SQ.M
95 TOTAL COVERED AREA OF EXISTING VILLAS	1,488.00 SQ.M
96 TOTAL COVERED AREA OF EXISTING VILLAS	1,488.00 SQ.M
97 TOTAL COVERED AREA OF EXISTING VILLAS	1,488.00 SQ.M
98 TOTAL COVERED AREA OF EXISTING VILLAS	1,488.00 SQ.M
99 TOTAL COVERED AREA OF EXISTING VILLAS	1,488.00 SQ.M
100 TOTAL COVERED AREA OF EXISTING VILLAS	1,488.00 SQ.M

Total Area of Plot for Wings 'A', 'B' of Block 4, Villa 'A'(1) & Villa 'E'(9) for the Purpose of REKA Registration=4,483.82 SQ.M (Phase 1) and approved vide Order No. GPPDA/T/G/76/2022 dated 26/4/2022 issued by Greater Panaji Planning and Development Authority

Factor=5,203.91 SQ.M (B.U.A for F.A.R. of Phase 1) x 22,255.00 SQ.M (CZ2 & S3 Zones) =5,248.25 SQ.M

Total Area of Plot for Wings 'C', Clubhouse of Block 4, Villa 'B'(4) & Villa 'F'(10) for the Purpose of REKA Registration=7,066.81 SQ.M (Phase 2) and approved vide Order No. GPPDA/T/G/76/2022 dated 26/4/2022 issued by Greater Panaji Planning and Development Authority

Factor=3,233.96 SQ.M (B.U.A for F.A.R. of Phase 2) x 22,255.00 SQ.M (CZ2 & S3 Zones) =3,261.51 SQ.M

Area Statement of Bay Hill Phase 1

Particulars	Plot Area for F.A.R.	Prop. Area
Villa 'A'(1)	397.47 m ²	662.45 m ²
Villa 'E'(9)	617.07 m ²	1,028.45 m ²
Block 4 - 'A' Wing	2,124.75 m ²	1,416.50 m ²
Block 4 - 'B' Wing	2,064.62 m ²	1,376.42 m ²
Total	5,203.91 m ²	4,483.82 m ²

Area Statement of Bay Hill Phase 2

Particulars	Plot Area for F.A.R.	Prop. Area
Villa 'B'(4)	348.64 m ²	581.07 m ²
Villa 'F'(10)	562.18 m ²	936.97 m ²
Block 4 - 'C' Wing	1,351.19 m ²	900.80 m ²
Block 4 - Clubhouse	971.95 m ²	647.97 m ²
Total	3,233.96 m ²	3,066.81 m ²

AREA LINE DIAGRAM Phase 1

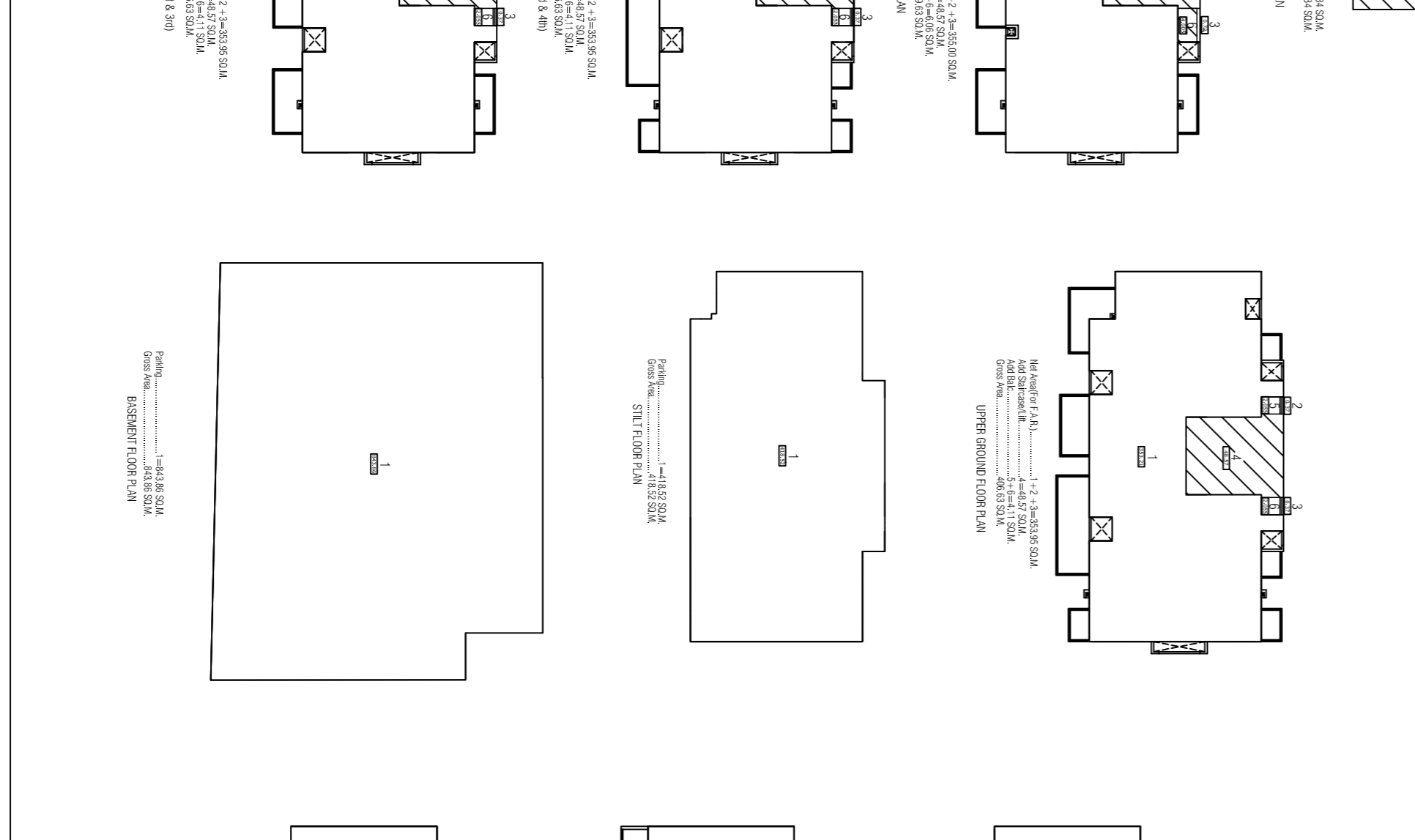

AREA LINE DIAGRAM Phase 2

